

STATE OF INDIANA)
) ss:
COUNTY OF LAKE)

IN THE LAKE CIRCUIT
COURT SITTING IN CROWN
POINT, INDIANA

30

F & H PROPERTIES, INC)
AN INDIANA CORPORA)
TION)

Plaintiff)

CAUSE NO. 45 C019511 CD 0030

vs

CONSOLIDATED RAIL)
CORPORATION, A PENNSYLVANIA)
CORPORATION AND THE UNKNOWN)
HEIRS REPRESENTATIVES, DEVISEES,)
WIDOWS, WIDOWERS, LEGATEES,)
EXECUTORS, ADMINISTRATORS,)
HUSBAND AND WIVES, RECEIVORS)
LESSORS, SUCCESSORS AND ASSIGNS)
OF JOHN H. ABRAMS AND FANNY A.)
ABRAMS, HIS WIFE)

Defendants

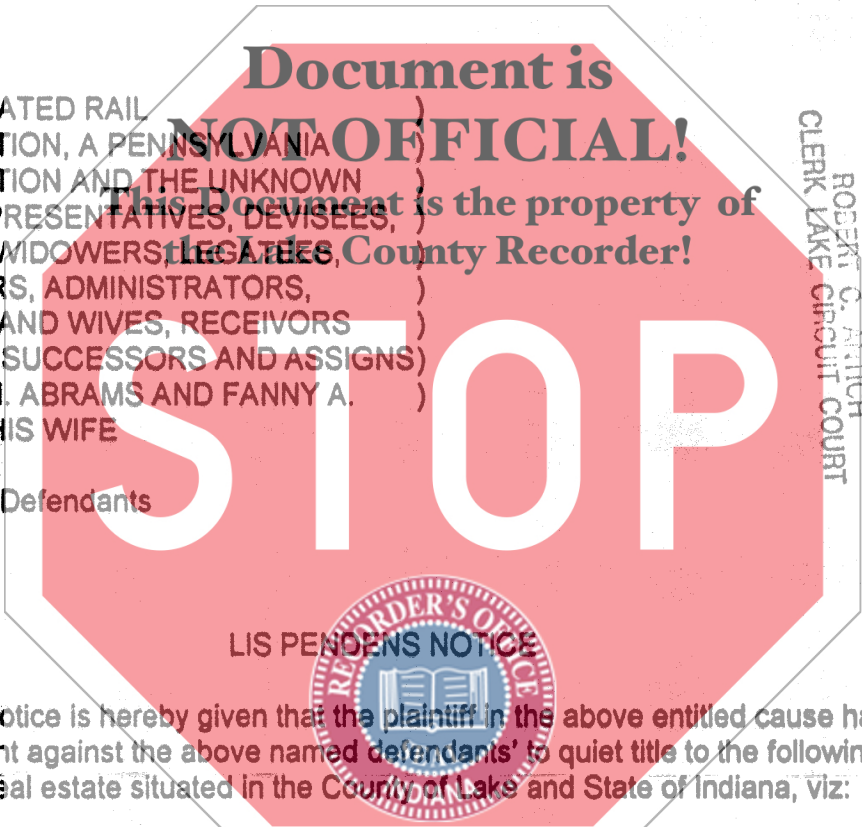

ROBERT C. ATTICH
CLERK LAKE CIRCUIT COURT

95 NOV 10 PM 2 16

FILED IN
CLERK'S OFFICE
95068998

Notice is hereby given that the plaintiff in the above entitled cause has filed his complaint against the above named defendants' to quiet title to the following described real estate situated in the County of Lake and State of Indiana, viz:

Part of the Northwest 1/4, Southeast 1/4 Section 5, Township 34 North, Range 8 West of the 2nd Principal Meridian, described as: Beginning at a point 158.6 feet East of the West line of the Southeast 1/4 of said Section 5 and on the Southerly right-of-way of the P.C.C. & St. Louis Railroad; thence North 45 degrees 42 minutes 46 seconds East a distance of 50.00 feet to the center line of said Railroad; thence South 44 degrees 17 minutes 14 seconds East along said center line, 314.69 feet more or less to the center line of Merrillville Road, thence South 19 degrees 26 minutes 24 seconds West along the center line of Merrillville Road, 55.76 feet to the Southerly right-of-way of said railroad; thence North 44 degrees 17 minutes 14 seconds West, 339.37 feet more or less to the point of beginning.

MARGARET H. WILSON
RECORDER

95 NOV 10 PH 2:20

STATE OF INDIANA
LAKE COUNTY
FILED FOR RECORD

ck# 986

11-11

Part of the Northwest ¼, Southeast ¼ Section 5, Township 34 North, Range 8 West of the 2nd Principal Meridian, described as: Beginning at a point 158.6 feet East of the West line of the Southeast ¼ of said Section 5 and on the Southerly right-of-way of the P.C.C. & St. Louis Railroad; thence North 45 degrees 42 minutes 46 seconds East a distance of 50.00 feet to the center line of said Railroad; thence South 44 degrees 17 minutes 14 seconds East along said center line, 314.69 feet more or less to the center line of Merrillville Road, thence South 19 degrees 26 minutes 24 seconds West along the center line of Merrillville Road, 55.76 feet to the Southerly right-of-way of said railroad; thence North 44 degrees 17 minutes 14 seconds West, 339.37 feet more or less to the point of beginning

Part of the Northwest ¼, Southeast ¼ Section 5, Township 34 North, Range 8 West of the 2nd Principal Meridian, described as: Beginning at a point 158.6 feet East of the West line of the Southeast ¼ of said Section 5 and on the Southerly right-of-way of the P.C.C. & St. Louis Railroad; thence North 45 degrees 42 minutes 46 seconds East a distance of 50.00 feet to the center line of said Railroad; thence South 44 degrees 17 minutes 14 seconds East along said center line, 314.69 feet more or less to the center line of Merrillville Road, thence South 19 degrees 26 minutes 24 seconds West along the center line of Merrillville Road, 55.76 feet to the Southerly right-of-way of said railroad; thence North 44 degrees 17 minutes 14 seconds West, 339.37 feet more or less to the point of beginning



Richard A. Parks
Richard A. Parks
Attorney No. 5620-45
Attorney for Plaintiff

P.O. Box 549
Crown Point, Indiana 46307
(219) 663-0099

Filed and recorded this 10th day of November, 1995

Robert C. Antick
CLERK, LAKE CIRCUIT COURT

By: *Shirley V. Payne*