

ASSIGNMENT OF REAL ESTATE MORTGAGE

KNOW ALL MEN BY THESE PRESENTS: THAT CREDIT UNION MORTGAGE SERVICES, INC. A CORPORATION ORGANIZED AND EXISTING UNDER AND BY VIRTUE OF THE LAWS OF THE UNITED STATES AND HAVING ITS OFFICE AND PRINCIPAL PLACE OF BUSINESS IN THE CITY OF MERRILLVILLE AND STATE OF INDIANA, PARTY OF THE FIRST PART, FOR VALUE RECEIVED, HAS GRANTED, BARGAINED, SOLD, ASSIGNED, TRANSFERRED AND SET OVER AND BY THESE PRESENTS DOES GRANT, BARGAIN, SELL, ASSIGN, TRANSFER AND SET OVER UNTO:

COUNTRYWIDE FUNDING CORPORATION

PARTY OF THE SECOND PART, ITS SUCCESSORS AND ASSIGNS, A CERTAIN INDENTURE OF MORTGAGE DATED THE 11th DAY OF SEPTEMBER A.D. 1995, MADE BY HERMAN ARTHUR WATERS & MARY E. WATERS HUSBAND AND WIFE

TO IT, SECURING THE PAYMENT OF ONE PROMISSORY NOTE THEREIN DESCRIBED FOR THE SUM OF Thirty Thousand and 00/100----- DOLLARS, (\$ 30,000.00 ) AND ALL ITS RIGHTS, TITLE AND INTEREST IN AND TO THE PREMISES SITUATED IN THE COUNTY OF LAKE

STATE OF INDIANA, AND DESCRIBED IN SAID MORTGAGE AS FOLLOWS, TOWIT: PART OF THE WEST 1/2 OF THE SOUTHWEST 1/4 OF SECTION 19, TOWNSHIP 35 NORTH, RANGE 7 WEST OF THE 2ND PRINCIPAL MERIDIAN, IN THE CITY OF HOBART, LAKE COUNTY, INDIANA, DESCRIBED AS FOLLOWS: BEGINNING AT A POINT ON THE WEST LINE OF THE SAID WEST 1/2 OF THE SOUTHWEST 1/4, 1,486.05 FEET NORTH OF THE SOUTHWEST CORNER OF THE ABOVE SAID SECTION 19; THENCE EAST AT AN ANGLE OF 90 DEGREES 27 MINUTES 30 SECONDS NORTH TO EAST, 200 FEET; THENCE NORTH, PARALLEL WITH THE WEST LINE OF SECTION 19, A DISTANCE OF 100 FEET; THENCE WEST 200 FEET TO A POINT ON THE WEST LINE OF SAID SECTION 19 WHICH POINT IS 100 FEET NORTH OF THE PLACE OF BEGINNING; THENCE SOUTH 100 FEET TO THE PLACE OF BEGINNING.

WHICH SAID MORTGAGE IS RECORDED IN THE OFFICE OF THE RECORDER OF LAKE COUNTY, IN THE STATE OF INDIANA, IN BOOK NO. , PAGE , DOCUMENT NO. 95055212 , TOGETHER WITH THE SAID NOTE THEREIN DESCRIBED AND THE MONEY DUE OR TO GROW DUE THEREON, WITH THE INTEREST;

TO HAVE AND TO HOLD THE SAME UNTO THE SAID PARTY OF THE SECOND PART, ITS SUCCESSORS AND ASSIGNS, FOREVER; SUBJECT ONLY TO THE PROVISIONS IN THE SAID INDENTURE OF MORTGAGE CONTAINED.

IN WITNESS WHEREOF, THE PARTY OF THE FIRST PART HAS CAUSED THIS INSTRUMENT TO BE EXECUTED IN ITS NAME BY SHIRLEY L. HANEY, MANAGER, AND ATTESTED BY LINDA G. UNDERWOOD, ITS CORPORATE SEAL TO BE HEREUNTO AFFIXED, THIS 11th DAY OF SEPTEMBER, A.D. 1995.

BY: Shirley L. Haney SHIRLEY L. HANEY, MANAGER

ATTEST: Linda G. Underwood LINDA G. UNDERWOOD

STATE OF Indiana ) )SS: COUNTY OF Lake )

BEFORE ME THE UNDERSIGNED, A NOTARY PUBLIC IN AND FOR THE COUNTY AND STATE AFORESAID, THIS 11th DAY OF September, 1995, PERSONALLY APPEARED Shirley L. Haney, Manager AND Linda G. Underwood RESPECTIVELY, AND ACKNOWLEDGED THE EXECUTION OF THE FORGOING INSTRUMENT.

NOTARY PUBLIC Virginia Cantrell

MY COMMISSION EXPIRES: 4/1/96

COUNTY OF RESIDENCE: Lake

THIS INSTRUMENT PREPARED BY: Donna Ivanyo

RETURN TO: CREDIT UNION MORTGAGE SERVICES 2476 WEST LINCOLN HIGHWAY MERRILLVILLE, IN 46410

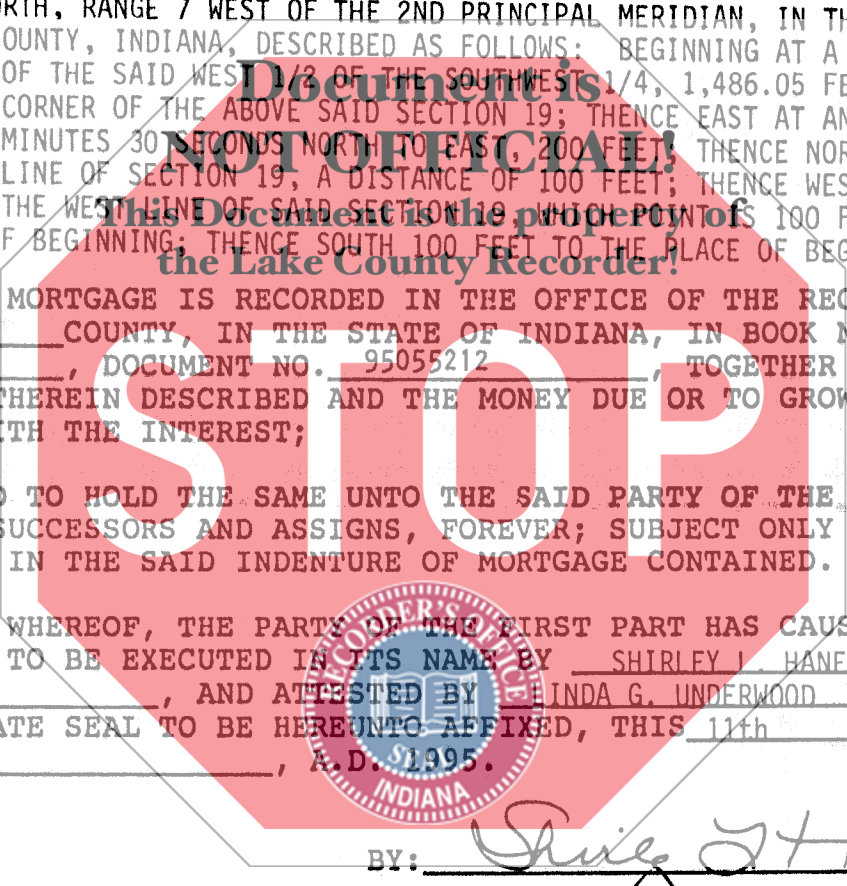

95067471

95 NOV - 6 AM 8:58

STATE OF INDIANA LAKE COUNTY FILED FOR RECORD

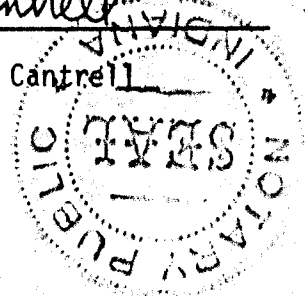

10:00 SW CK# 6774