

Tx 16/6m
19/094



DULY ENTERED FOR TAXATION SUBJECT TO
FINAL ACCEPTANCE FOR TRANSFER.

NOV 2 1995

SAM ORLICH
AUDITOR LAKE COUNTY

WARRANTY DEED

TAX KEY # 32-5-18 Unit#26

THIS INDENTURE WITNESSETH, THAT FRANK E. CARRASCO AND MARCELA BENAVIDES, AS JOINT TENANTS WITH FULL RIGHTS OF SURVIVORSHIP

OF LAKE COUNTY, STATE OF INDIANA CONVEY AND WARRANT TO DEAN R. MADSEN AND BONNIE L. MADSEN, HUSBAND AND WIFE

OF LAKE COUNTY, STATE OF INDIANA, FOR AND IN CONSIDERATION OF THE SUM OF TEN AND NO/100 DOLLARS THE RECEIPT WHEREOF IS HEREBY ACKNOWLEDGED, THE FOLLOWING DESCRIBED REAL ESTATE IN LAKE

COUNTY, STATE OF INDIANA WITH 18 and 19 and Lot 20, except the South 19 feet thereof, in Block 3 in The Baldwin Addition to Gary, in the City of Hammond, as per plat thereof, recorded in Plat Book 10 page 35, in the Office of the Recorder of Lake County, Indiana. Commonly known as: 6532 Illinois Ave., Hammond, In 46323

- Subject to: 1. All easements, covenants, assessments, and restrictions now of record.
- 2. All real estate taxes for the year 1994 and payable in 1995 and all subsequent real estate taxes which become due and payable.

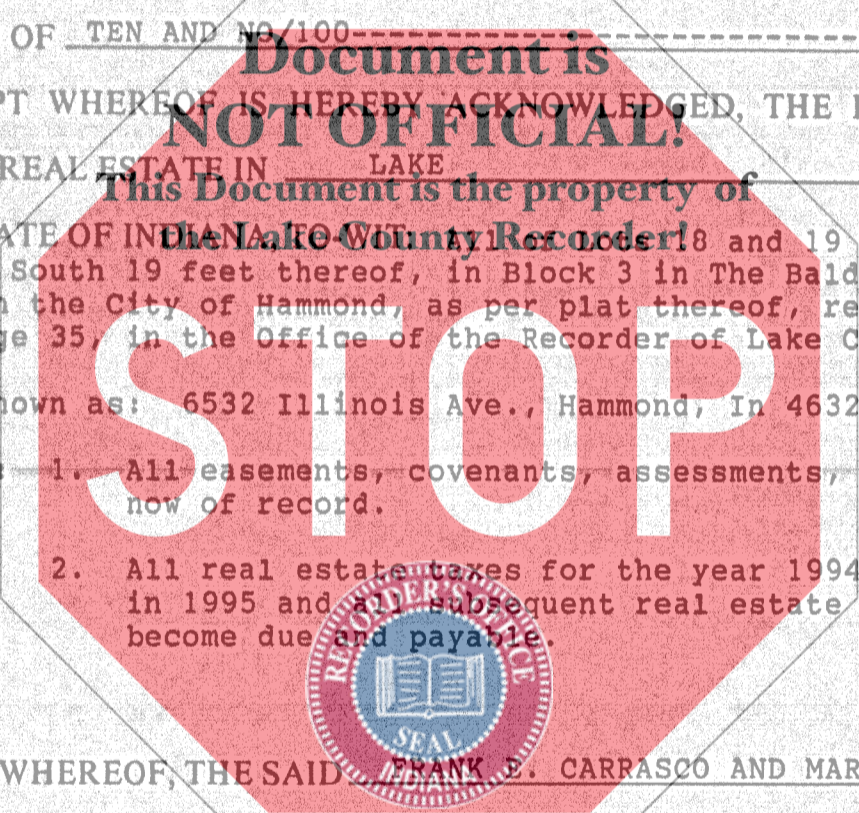

9506218
95 NOV 3 AM 9:45
MARGARET C. AND RECORDED
STATE OF INDIANA
LAKE COUNTY
FILED FOR RECORD

IN WITNESS WHEREOF, THE SAID FRANK E. CARRASCO AND MARCELA BENAVIDES AS JOINT TENANTS WITH FULL RIGHTS OF SURVIVORSHIP

HAVE HEREUNTO SET their HANDS AND SEALS, THIS 31ST DAY OF OCT. 19 95
Frank E. Carrasco (SEAL) Marcela Benavides (SEAL)
Frank E. Carrasco Marcela Benavides
(SEAL) (SEAL)

STATE OF INDIANA, COUNTY OF LAKE, SS:
BEFORE ME, THE UNDERSIGNED NOTARY PUBLIC IN AND FOR SAID COUNTY AND STATE, PERSONALLY APPEARED FRANK E. CARRASCO AND MARCELA BENAVIDES AND ACKNOWLEDGED THE EXECUTION OF THIS INSTRUMENT TO BE THEIR VOLUNTARY ACT AND DEED, WITNESS MY HAND AND OFFICIAL SEAL THIS 31ST DAY OF OCTOBER, 1995
MY COMMISSION EXPIRES: 10-24-96
COUNTY OF RESIDENCE: LAKE Gloria Miller NOTARY PUBLIC
GLORIA MILLER

SEND TAX STATEMENTS TO: 6532 ILLINOIS AV. HAMMOND, IN 46323
Atty Peter Benjamin 1000 E. 80th Place Twin Towers
THIS INSTRUMENT PREPARED BY: South Suite#514, Merr., IN 46410

000172

Handwritten initials and scribbles at the bottom right corner.