

P.O. Box 272  
Griffith, IN 46319  
7

Mail Tax Bills To: 123 East Pine  
Griffith, IN 46319

Tax Key No.: 26-153-45

### QUITCLAIM DEED

THIS INDENTURE WITNESSETH, That **THOMAS A. KELLY** ("Grantor") of Lake County, in the State of Indiana, quitclaim(s) to **CHARLENE R. KELLY** of Lake County, in the State of Indiana, for and in consideration of the sum of Ten Dollars (\$10.00) and other good and valuable consideration, the receipt of which is hereby acknowledged, the following described real estate in Lake County, in the State of Indiana, to-wit:

St. Mary's Addition, Lots 45 and 46, Block 1.  
This Document is the property of the Lake County Recorder!

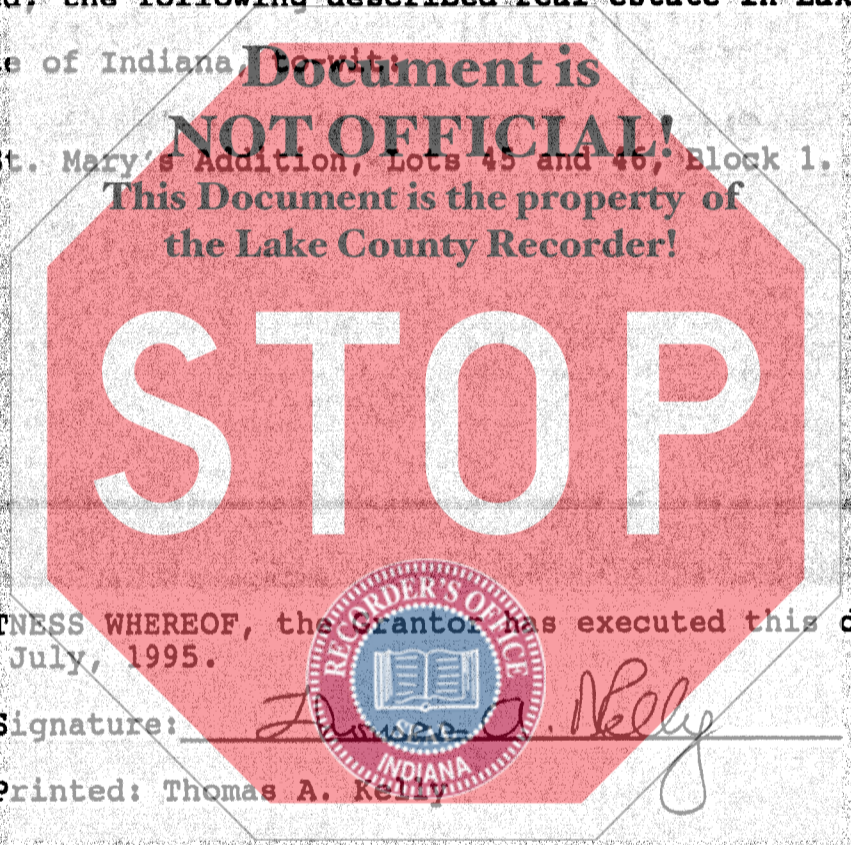

95067038

IN WITNESS WHEREOF, the Grantor has executed this deed, this 1st day of July, 1995.

Signature: Thomas A. Kelly  
Printed: Thomas A. Kelly

STATE OF INDIANA  
LAKE COUNTY  
FILED FOR RECORD  
95 NOV - 2 PH 3:11  
MARGARET O'BRIEN  
RECORDER

STATE OF INDIANA )  
                          )SS:  
COUNTY OF LAKE )

Before me, the undersigned, a Notary Public in and for said county and state, personally appeared Thomas A. Kelly, who acknowledged the execution of the foregoing Quitclaim Deed, and who, having been duly sworn, stated that any representations therein contained are true.

Witness my hand and Notarial Seal this 1st day of July, 1995.  
My Commission Expires: Signature Timothy G. Raymond  
Printed Timothy G. Raymond Notary Public  
Residing in Lake County, Indiana.  
TIMOTHY G. RAYMOND  
NOTARY PUBLIC STATE OF INDIANA  
LAKE COUNTY  
MY COMMISSION EXP. MAY 16, 1998

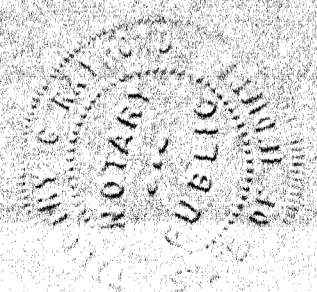

This Instrument was prepared by: Paul A. Leonard, Jr., Goodman Ball & Van Bokkelen, P.C.  
3737 - 45th Street, Highland, IN 46322, attorneys at law.

DULY ENTERED FOR TAXATION SUBJECT TO  
FINAL ACCEPTANCE FOR TRANSFER.

NOV 2 1995

SAM ORLICH  
AUDITOR LAKE COUNTY

606210

10.00  
SW  
CS