

This Instrument was Prepared By:
NORTH AMERICAN MORTGAGE COMPANY

STATE OF INDIANA
LAKE COUNTY
FILED FOR RECORD

95 NOV -2 AM 8:51

MARGARETTE CLEVELAND
RECORDER

[WHEN RECORDED RETURN TO]
NTC ATTN:MARCEL FEMINE
7530 GLENOAKS BLVD., SUITE #200
BURBANK, CALIFORNIA 91504
GE CAPITAL LOAN#: 16252660

ES, INC.
MO 63141

95066725



(space Above This Line For Recording Data)

475322-F28
16252660

ASSIGNMENT OF MORTGAGE

POOL# 05467683

THIS ASSIGNMENT is made by NORTH AMERICAN MORTGAGE COMPANY
a (firm, corporation, partnership or joint venture) (hereinafter referred to as
the "Assignor"), to GE CAPITAL MORTGAGE SERVICES, INC.

A NEW JERSEY CORPORATION
a corporation, having its principal place of business in
625 MARYVILLE CENTRE DRIVE ST. LOUIS MO 63141
(hereinafter referred to as the "Assignee").

ASSIGNMENT

1. The Assignor for good and valuable consideration, receipt whereof is
hereby acknowledged, hereby absolutely and unconditionally grants, transfers
and assigns to the Assignee the Assignor's entire right, title and interest in
and to a certain mortgage entered into on the 1/23/95, wherein

GARCIA LUCIANO L
GARCIA MARTINA
LAKE
warranted to
as Mortgagee, of LAKE
following described real estate in LAKE
Indiana.

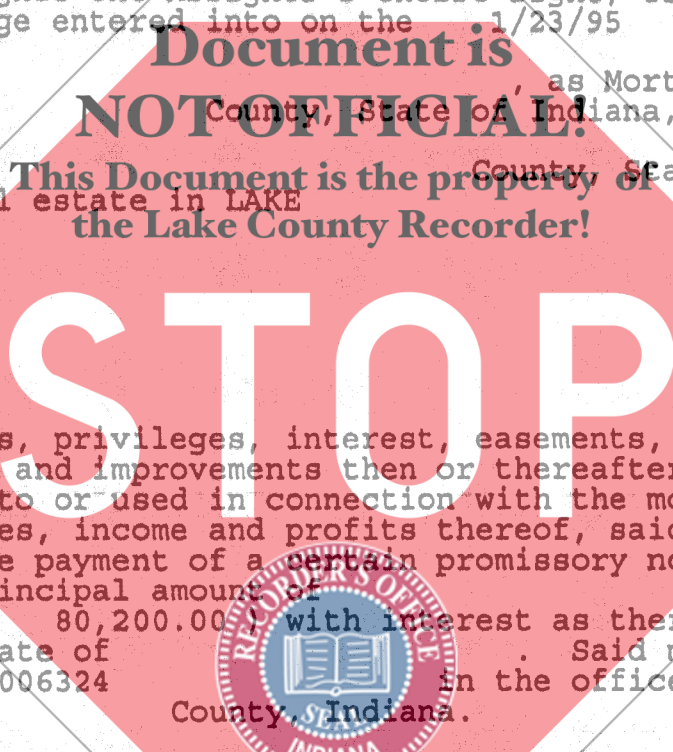

Together with all rights, privileges, interest, easements, hereditaments,
appurtenances, fixtures and improvements then or thereafter belonging,
appertaining, attached to or used in connection with the mortgaged premises
and all the rents, issues, income and profits thereof, said mortgage having
been given to secure the payment of a certain promissory note dated the
1/23/95, in the principal amount of
(\$ 80,200.00) with interest as therein provided and
with a vinal maturity date of . Said mortgage is recorded
as instrument number 95006324 in the office of the Recorder of
LAKE County, Indiana.

IN WITNESS WHEREOF, the Assignor has executed this Assignment of Mortgage
July 25, 1995

NORTH AMERICAN MORTGAGE COMPANY
A DELAWARE CORPORATION

* RE-REC INFO:
INST #:
DATE:
BOOK:
PAGE:

STATE OF CALIFORNIA)
)
COUNTY OF SONOMA) SS.

S.E. Willinger
S.E. WILLINGER
VICE PRESIDENT

On July 25, 1995, before me, PATTY LEACH a Notary Public,
personally appeared S.E. WILLINGER
personally known to me (or proved to me on the basis of satisfactory evidence)
to be the person(s) whose name(s) is/are subscribed to the within instrument
and acknowledged to me that he/she/they executed the same in his/her/their
authorized capacity(ies), and that by his/her/their signature(s) on the
instrument the person(s), or the entity upon behalf of which the person(s)
acted, executed the instrument.

WITNESS my hand and official seal.

Signature *Patty Leach*
A2-R1/IN

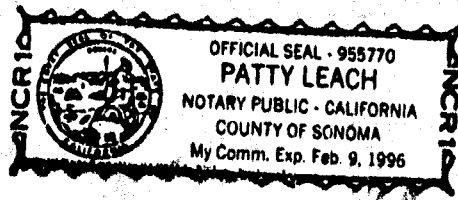

(seal)

10.00
52