



SURVIVORSHIP AFFIDAVIT

STATE OF Indiana } S. S.
COUNTY OF Lake

On this October 23rd, 1995 before me personally appeared
(insert date)

Elsie M. Keiller

to me personally known, who being duly sworn on oath did say that:

- 1. Affiant resides at the address given below affiant's signature;
2. Affiant is Owner (state interest of affiant in the above premises as "owner," "son of owner," etc.)

- 3. Said premises were formerly owned as joint tenants or as tenants by the entireties by James C. Keiller and Elsie M. Keiller

- 4. Said James C. Keiller (fill in name of co-tenant who died)

died on April 20, 1987

leaving will; (insert "a" or "no" if will left, attach a copy)

- 5. The legal description of the premises in question is: Lot 21, Block 6, Hessville Park Addition to Hammond, as shown in Plat Book 17, page 14, in Lake County, Indiana. Key No. 34-85-21 M Unit 26

- 6. To the best of affiant's knowledge there is no Federal or State estate or inheritance tax liability by reason of the death of said decedent;

- 7. Where this affidavit relates to a tenancy by the entireties, were the parties ever divorced? NO

(If answer is "Yes," identify the divorce proceedings:)

- 8. Affiant's relationship to the deceased was Spouse

Signature: Elsie M. Keiller

Address: 6617 Delaware Avenue Hammond, In. 46323

Subscribed and sworn to before me by the affiant

this 23rd day of October, 1995 appeared Elsie M. Keiller

Arlyne K. Royal Lake County Residence

My Commission Expires April 30, 1999

This instrument prepared by Elsie M. Keiller

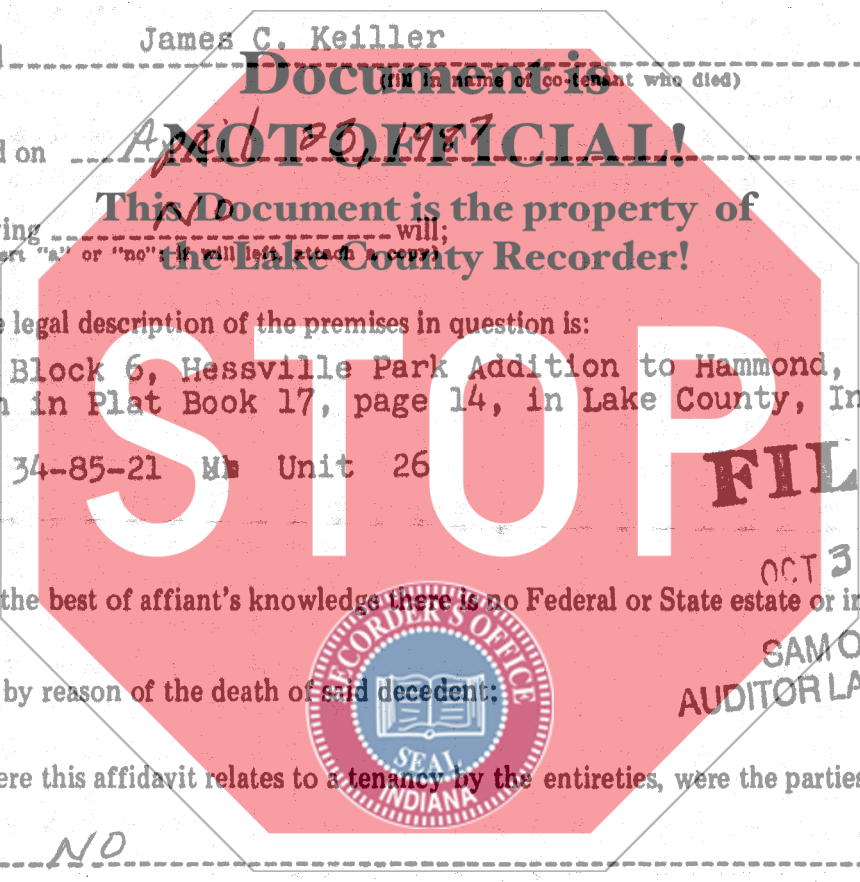

Chicago Title Insurance Company

95066560

OCT 31 1995 SAMORLICH AUDITOR LAKE COUNTY

JANETTES LEVAND RECORDER

95 NOV - 1 PM 1:21

LAKE COUNTY FILED FOR RECORD

001867

Handwritten initials and date: 10/25