

STATE OF INDIANA  
LAKE COUNTY  
FILED FOR RECORD

95 OCT 30 AM 9:15

MARGARETTE CLEVELAND  
RECORDER

95065684

RECORDING REQUESTED BY  
Fidelity National Title Insurance Co.  
NLD # 11882 ACCT # 13548806

WHEN RECORDED MAIL TO  
TRANSAMERICA MERRILLVILLE  
109 W 86TH PLACE  
MERRILLVILLE, IN 46410  
Branch #1348

RECORDERS USE ONLY

NOTE: - This Assignment should be kept with the note and MORTGAGE hereby assigned.

### ASSIGNMENT OF MORTGAGE

FOR VALUE RECEIVED, the undersigned hereby grants, assigns and transfers to  
~~TRANSAMERICA FINANCIAL SERVICES A CALIFORNIA CORPORATION~~ all beneficial interest  
under that certain MORTGAGE

dated 06/24/94 executed by EDWARD G. WARREN AND EMMA C. WARREN, Trustor,  
to AETNA FINANCE COMPANY, A DELAWARE CORPORATION, Trustee,  
and recorded on 06/28/94, INST# 94-047246 of Official Records in the County  
Recorder's office of LAKE, IN. Resubscribing and thereas as:

THE SOUTH 1/2 OF LOT 15, ALL OF LOT 16 AND THE NORTH 1/2 OF LOT 17, BLOCK 3, GARY  
PARK 4TH ADDITION TO GARY, AS SHOWN IN PLAT BOOK 8, PAGE 31, LAKE COUNTY, INDIANA.

P.I.N.: 25-43-0237-0016

AKA: 2260 ARTHUR STREET GARY, IN 46408

Together with the note or notes therein described or referred to, the money due  
and to become due thereon with interest, and all rights accrued or to accrue  
under said MORTGAGE.

Dated 06/12/95

Beneficiary: AETNA FINANCE COMPANY, A DELAWARE CORPORATION By Transamerica Financial  
Services as Attorney in Fact By

GREGORY L. BEARD  
ASSISTANT SECRETARY

(Corporate Acknowledgement)

NOTARY ATTACHED

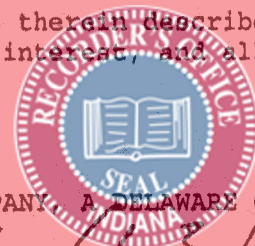
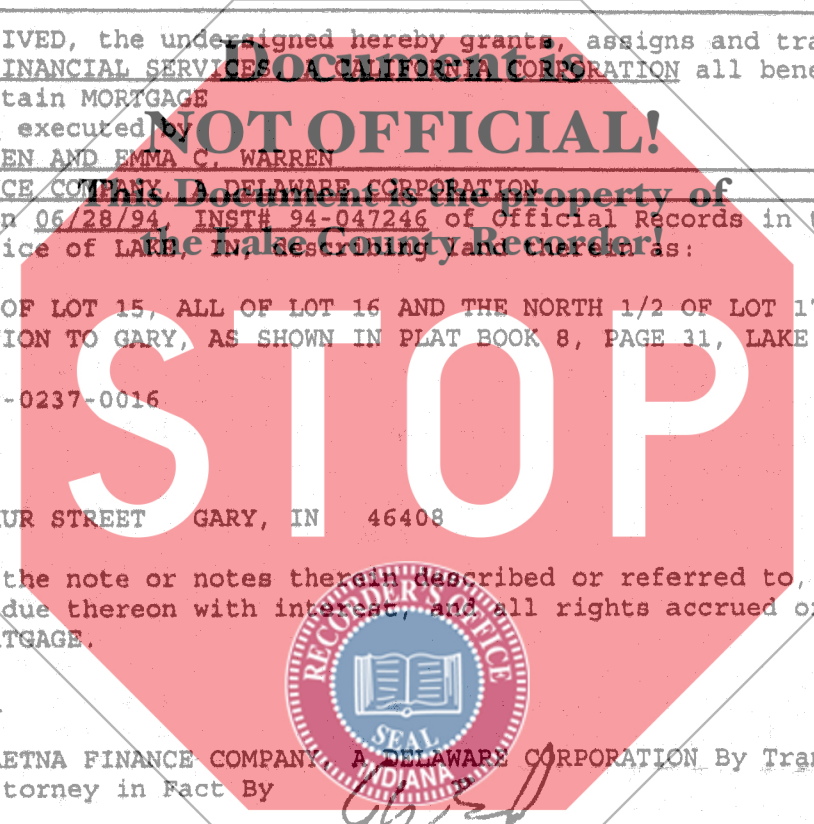

1200

STATE OF CALIFORNIA  
County of Los Angeles

Title or type of Document Assignment of Mortgage  
Number of Pages 1 Date of Document 6/12/95  
Signer(s) Other than named below \_\_\_\_\_

On October 16, 1995 before me Leone A. White personally appeared  
Gregory L. Beard, Asst. Secretary

personally known to me (or proved to me on the basis of satisfactory evidence) to be the person(s) whose name(s) is/are subscribed to the within instrument and acknowledged to me that he/she/they executed the same in his/her/their authorized capacity(ies), and that by this/her/their signature(s) on the instrument the person(s), or the entity upon behalf of which the person(s) acted, executed the instrument.

WITNESS my hand and official seal.

Signature Leone A. White  
Notary Public in and for said County and State



UD01 (Rev. 4/94)

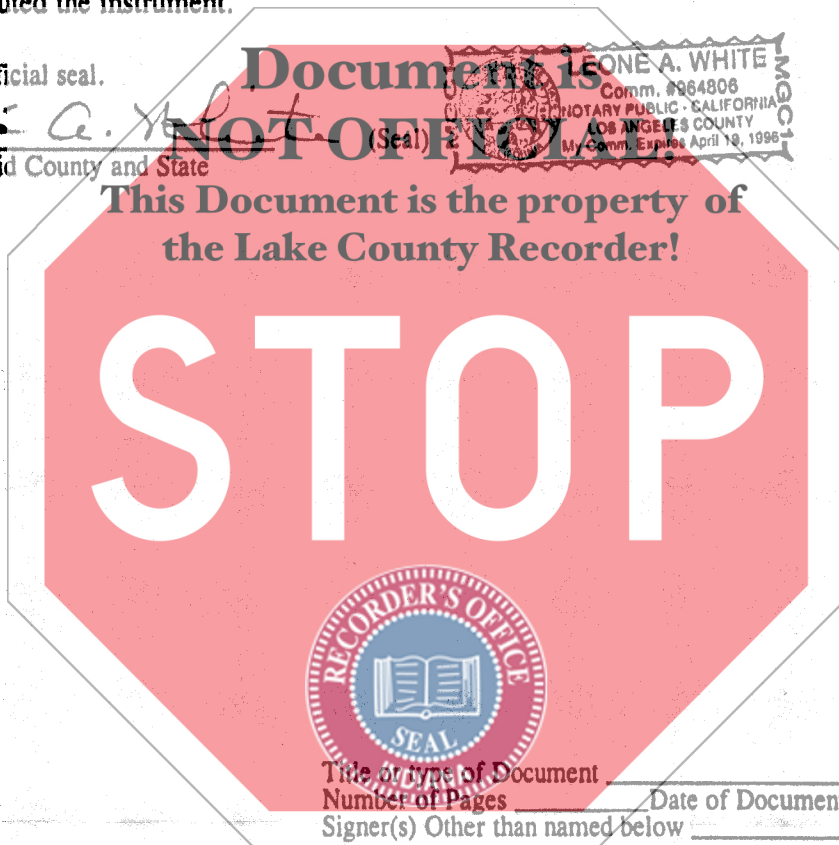

STATE OF CALIFORNIA  
County of \_\_\_\_\_

Title or type of Document \_\_\_\_\_  
Number of Pages \_\_\_\_\_ Date of Document \_\_\_\_\_  
Signer(s) Other than named below \_\_\_\_\_

On \_\_\_\_\_ before me \_\_\_\_\_ personally appeared

personally known to me (or proved to me on the basis of satisfactory evidence) to be the person(s) whose name(s) is/are subscribed to the within instrument and acknowledged to me that he/she/they executed the same in his/her/their authorized capacity(ies), and that by this/her/their signature(s) on the instrument the person(s), or the entity upon behalf of which the person(s) acted, executed the instrument.

WITNESS my hand and official seal.

Signature \_\_\_\_\_ (Seal)  
Notary Public in and for said County and State

UD01 (Rev. 4/94)