

4042 48265619
Lakefall SALA

MAIL TAX BILLS TO:

3236 FARMER DRIVE
HIGHLAND, IN 46322

TAX KEY NOS. 27-292-5

WARRANTY DEED

Chicago Title Insurance Company

This indenture witnesseth that

JAMES B. MITSEFF,

of Lake County in the State of Indiana

Conveys and warrants to

GRANT R. BUTLER and ROBIN L. BUTLER,
husband and wife, as tenants by entireties,

of Lake County in the State of Indiana

for and in consideration of Ten Dollars (\$10.00) and other good and valuable consideration the receipt whereof is hereby acknowledged, the following Real Estate in Lake County in the State of Indiana, to wit:

LOT 5, BLOCK 2, ELLEDALE FIRST ADDITION TO THE TOWN OF HIGHLAND, AS SHOWN IN PLAT BOOK 32, PAGE 78, IN LAKE COUNTY, INDIANA.
Commonly known as 3236 Farmer Drive, Highland, Indiana 46322.

Subject To: all unpaid real estate taxes and assessments for 1995 payable in 1996, and for all real estate taxes and assessments for all subsequent years.

Subject To: all easements, conditions, restrictions, covenants, limitations and building setback lines contained in prior instruments of record, and for all building and zoning ordinances.

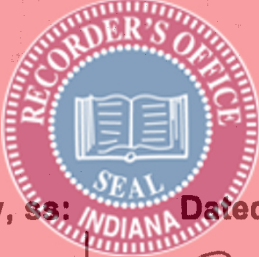
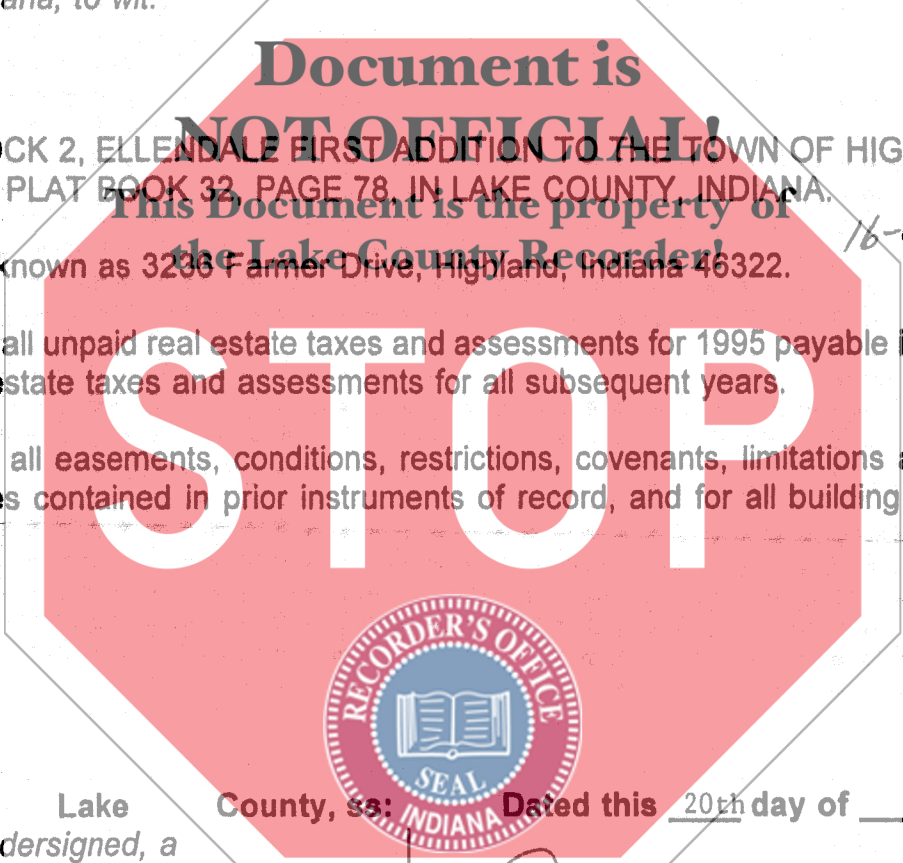

95065216

16-27-292-5

State of Indiana, Lake County, ss: Indiana Dated this 20th day of October, 1995
Before me, the undersigned, a Notary Public in and for said County and State, this 20th day of October, 1995 personally appeared:

JAMES B. MITSEFF,

And acknowledged the execution of the foregoing deed. In witness whereof, I have hereunto subscribed my name and affixed my official seal.
My commission expires: 12-7-96

Cecelia Szeplakay
Cecelia Szeplakay Notary Public

Resident of Lake County

James B. Mitseff
JAMES B. MITSEFF

STATE OF INDIANA
LAKE COUNTY
FILED FOR RECORD
95 OCT 26 PM 1:25
MARGARETTE CLEVELAND
RECORDER
OCT 25 1995
SAM OSRUCH
AUDITOR LAKE COUNTY

This instrument prepared by:
CECELIA SZEPLAKAY
NOTARY PUBLIC STATE OF INDIANA
LAKE COUNTY
MY COMMISSION EXP DEC 7, 1996

Rhett L. Tauber, Esq./Anderson, Tauber & Woodward, P.C.
8935 Broadway, Merrillville, IN 46410
Phone: 219/769-1892

001565

JK
1001