

196394 TICOR 16

THIS FORM HAS BEEN PREPARED FOR USE IN THE STATE OF INDIANA BY LAWYERS ONLY. THE SELECTION OF A FORM OF INSTRUMENT, FILLING IN BLANK SPACES, STRIKING OUT PROVISIONS, AND INSERTION OF SPECIAL CLAUSES, MAY CONSTITUTE THE PRACTICE OF LAW WHICH SHOULD ONLY BE DONE BY A LAWYER.

Mail tax bills to:
4620 Ash Avenue
Hammond, Ind. 46327

WARRANTY DEED

THIS INDENTURE WITNESSETH, That JERRY NIETO AND VERONICA NIETO,
Husband and Wife

("Grantor") of Lake County in the State of Indiana
CONVEYS AND WARRANTS TO FRANCISCO CANELO

of LAKE County in the State of Indiana
in consideration of One Dollar and other valuable consideration, the receipt and sufficiency of which are hereby acknowledged, the following described real estate in Lake County, in the State of Indiana:

The real estate and premises commonly known as 4620 Ash Avenue, Hammond, County of Lake, State of Indiana, and more particularly described as follows, to-wit:

Lots 11 and 12 in Block 6 in Towle and Avery's Addition to Hammond, as per plat thereof, recorded in Plat Book 1 page 104, in the Office of the Recorder of Lake County, Indiana.
26-36-213-10 & 11

Subject to real estate taxes for 1995 payable in 1996, together with delinquency and penalty, if any, and all real estate taxes due and payable thereafter.

Subject to recorded liens, encumbrances, easements, restrictions, ditches and drains, highways, and legal rights of way, and matters which would be disclosed by an accurate survey or inspection of the premises.

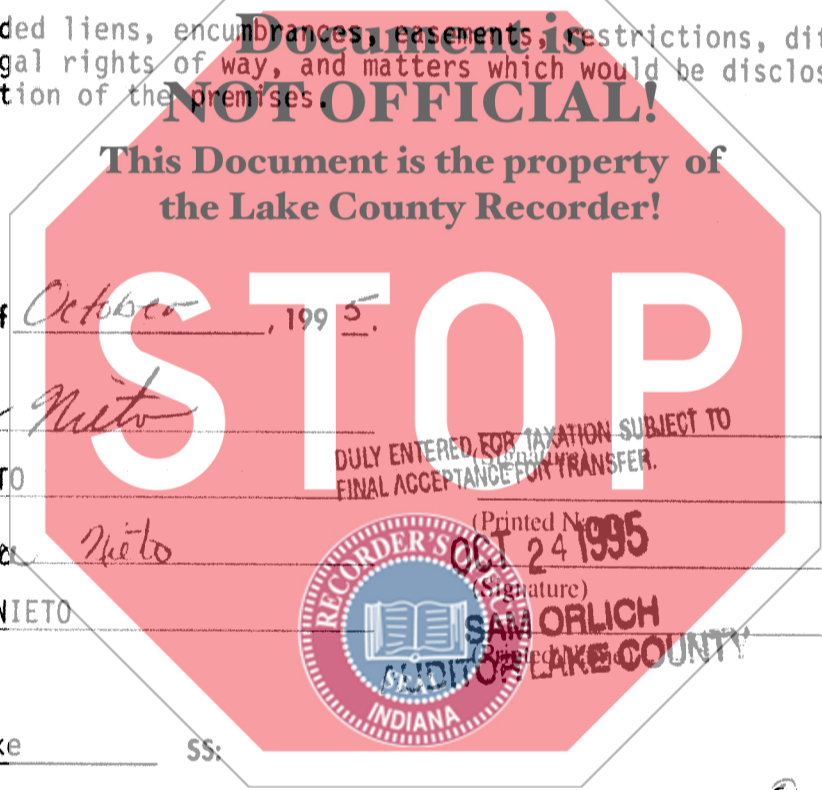

Dated this 20 day of October, 1995.

(Signature) *Jerry Nieto*
JERRY NIETO

(Signature) *Veronica Nieto*
VERONICA NIETO

DULY ENTERED FOR TAXATION SUBJECT TO FINAL ACCEPTANCE FOR TRANSFER.

RECORDER'S OFFICE
OCT 24 1995
S. M. ORLICH
CLERK OF LAKE COUNTY
INDIANA

95064477

STATE OF INDIANA
COUNTY OF Lake SS:

Before me, the undersigned, a Notary Public in and for said County and State, this 20 day of October, 1995, personally appeared: JERRY NIETO AND VERONICA NIETO, Husband and Wife and acknowledged the execution of the foregoing deed. In witness whereof, I have hereunto subscribed my name and affixed my official seal.

My commission expires: June 7, 1996 Signature *Thomas G. Schiller*
Resident of Lake County Printed Thomas G. Schiller, Notary Public

STATE OF _____
COUNTY OF _____ SS:

Before me, the undersigned, a Notary Public in and for said County and State, this _____ day of _____, 199____, personally appeared: _____ and acknowledged the execution of the foregoing deed. In witness whereof, I have hereunto subscribed my name and affixed my official seal.

My commission expires: _____ Signature _____
Resident of _____ County Printed _____, Notary Public

This instrument prepared by Thomas K. Hoffman, One Professional Center, Crown Point, IN Attorney at Law
Attorney Identification No. 7731-45

MAIL TO:

001413

10.00
TW
SW