

RECORDING REQUESTED BY  
Fidelity National Title Insurance Co.  
NLD # 24694 ACCT # 07661490

WHEN RECORDED MAIL TO  
TRANSAMERICA MISHAWAKA  
3930 EDISON LAKES OKWY STE 240  
MISHAWAKA, IN 46545  
Branch #1370

95059969

RECORDERS USE ONLY

NOTE: - This Assignment should be kept with the note and MORTGAGE hereby assigned.

## ASSIGNMENT OF MORTGAGE

FOR VALUE RECEIVED, the undersigned hereby grants, assigns and transfers to  
~~TRANSAMERICA FINANCIAL SERVICES, A CALIFORNIA CORPORATION~~ all beneficial interest  
under that certain MORTGAGE dated 09/22/94 executed by  
~~LUTHER WALKER AND WILLIE B. WALKER~~  
to ~~AETNA FINANCE COMPANY, A DELAWARE CORPORATION~~  
and recorded on 09/27/94, INST. # 94067610 of Official Records in the County  
Recorder's office of LAKE IN, describing land therein as:

LOT 42 AND THE WEST 1/2 OF LOT 41, BLOCK 2, BORMANN'S 2ND ADDITION IN THE CITY OF  
GARY, AS SHOWN IN PLAT BOOK 7, PAGE 17, IN LAKE COUNTY, INDIANA.

AKA: 2571 W. 9TH AVE GARY, IN 46404

Together with the note or notes therein described or referred to, the money due  
and to become due thereon with interest, and all rights accrued or to accrue  
under said MORTGAGE.

Dated 07/20/95

Beneficiary: AETNA FINANCE COMPANY, A DELAWARE CORPORATION By Transamerica Financial  
Services as Attorney in Fact By

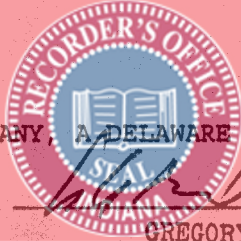

GREGORY L. BEARD  
ASSISTANT SECRETARY

(Corporate Acknowledgement)

NOTARY ATTACHED

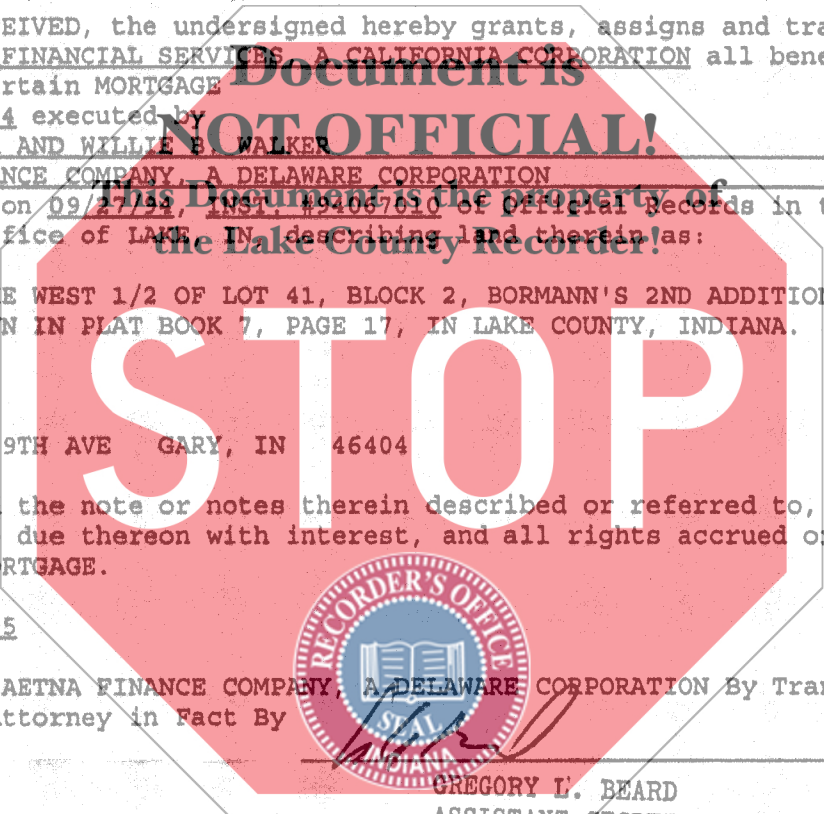

STATE OF INDIANA  
LAKE COUNTY  
FILED FOR RECORD  
95 OCT 24 AM 10:10  
RECORDED  
MARGARET H. CLEVELAND

1200

STATE OF CALIFORNIA

County of Los Angeles

Title or type of Document Assignment of Mortgage  
Number of Pages 1 Date of Document 7/20/95  
Signer(s) Other than named below \_\_\_\_\_

On August 24, 1995 before me Leone A. White personally appeared  
Gregory L. Beard, Asst. Secretary

personally known to me (or proved to me on the basis of satisfactory evidence) to be the person(s) whose name(s) is/are subscribed to the within instrument and acknowledged to me that he/she/they executed the same in his/her/their authorized capacity(ies), and that by this/her/their signature(s) on the instrument the person(s), or the entity upon behalf of which the person(s) acted, executed the instrument.

WITNESS my hand and official seal.

Signature Leone A. White  
Notary Public in and for said County and State

UD01 (Rev. 4/94)



STATE OF CALIFORNIA

County of \_\_\_\_\_

Title or type of Document \_\_\_\_\_  
Number of Pages \_\_\_\_\_ Date of Document \_\_\_\_\_  
Signer(s) Other than named below \_\_\_\_\_

On \_\_\_\_\_ before me \_\_\_\_\_ personally appeared

personally known to me (or proved to me on the basis of satisfactory evidence) to be the person(s) whose name(s) is/are subscribed to the within instrument and acknowledged to me that he/she/they executed the same in his/her/their authorized capacity(ies), and that by this/her/their signature(s) on the instrument the person(s), or the entity upon behalf of which the person(s) acted, executed the instrument.

WITNESS my hand and official seal.

Signature \_\_\_\_\_ (Seal)  
Notary Public in and for said County and State

UD01 (Rev. 4/94)