

195439

THIS FORM HAS BEEN PREPARED FOR USE IN THE STATE OF INDIANA BY LAWYERS ONLY. THE SELECTION OF A FORM OF INSTRUMENT, FILLING IN BLANK SPACES, STRIKING OUT PROVISIONS, AND INSERTION OF SPECIAL CLAUSES, MAY CONSTITUTE THE PRACTICE OF LAW WHICH SHOULD ONLY BE DONE BY A LAWYER.

Mail tax bills to:

7152 McLaughlin
Hammond, IN 46324

WARRANTY DEED

THIS INDENTURE WITNESSETH, That CHARLES R. PIERCE

("Grantor") of Lake County in the State of Indiana
CONVEYS AND WARRANTS TO GREGORY J. FURMAN and NICOLE P. HRABRICH, as joint tenants with full rights of survivorship and not as tenants in common

of Lake County in the State of Indiana
in consideration of One Dollar and other valuable consideration, the receipt and sufficiency of which are hereby acknowledged, the following described real estate in Lake County, in the State of Indiana:

The North 38 feet of Lot 17 and the South 9 feet of Lot 18 in Block 1 in Wilson Square Addition, in the City of Hammond, as per plat thereof, recorded in Plat Book 29 page 21, in the Office of the Recorder of Lake County, Indiana.

Commonly known as: 7152 McLaughlin
Hammond, IN 46324

Tax Key No. 36-488-17

Subject to past and current year real estate taxes.

Subject to easements, restrictions and covenants of record, and any other TAXATION SUBJECT TO REAL ACCEPTANCE FOR TRANSFER.

This Document is the property of the Lake County Recorder!

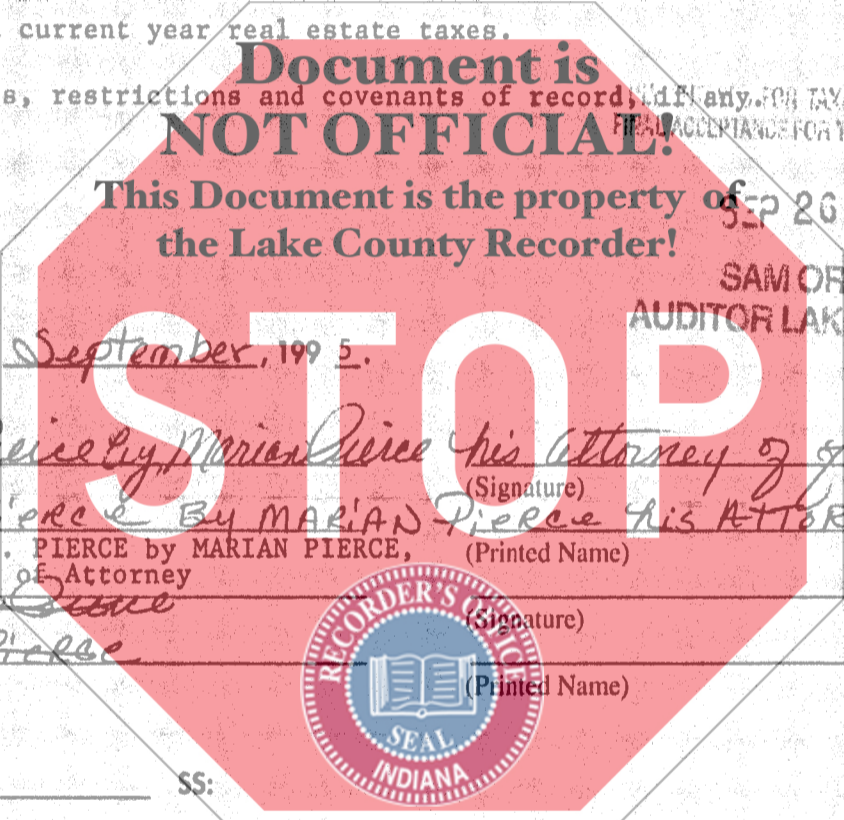

Dated this 22 day of September, 1995.

Charles R. Pierce by Marian Pierce his attorney of fact
(Signature) CHARLES R. PIERCE BY MARIAN PIERCE his attorney
(Printed Name) CHARLES R. PIERCE by MARIAN PIERCE, (Printed Name)
per Power of Attorney
Marian Pierce
(Signature) MARIAN PIERCE
(Printed Name)

STATE OF INDIANA
COUNTY OF LAKE SS:

Before me, the undersigned, a Notary Public in and for said County and State, this 22nd day of September, 1995, personally appeared: CHARLES R. PIERCE by MARIAN PIERCE, ~~per power of attorney~~ His Attorney in Fact and acknowledged the execution of the foregoing deed. In witness whereof, I have hereunto subscribed my name and affixed my official seal.

My commission expires: 10-18-96 Signature *Awilda Galvan*
Resident of Lake County Printed Awilda Galvan, Notary Public

STATE OF _____
COUNTY OF _____ SS:

Before me, the undersigned, a Notary Public in and for said County and State, this _____ day of _____, 199_____, personally appeared: _____ and acknowledged the execution of the foregoing deed. In witness whereof, I have hereunto subscribed my name and affixed my official seal.

My commission expires: _____ Signature _____
Resident of _____ County Printed _____, Notary Public

This instrument prepared by John D. Breclaw, 200 W. Glen Park Ave., Griffith, IN 46319 Attorney at Law
Attorney Identification No. 3656-45

MAIL TO:

001667 10.00