

Mail Tax Bills to:  
HAROLD L. & WINNELL FARLEY  
7507 MARSHALL AVE  
HAMMOND, IN 46323

DULY ENTERED FOR TAXATION SUBJECT TO  
FINAL ACCEPTANCE FOR TRANSFER.

WARRANTY DEED

SEP 25 1995

This Indenture witnesseth that

HECTOR MENDOZA and LISA MENDOZA,  
husband and wife

SAM ORLICH  
AUDITOR LAKE COUNTY

of Lake County in the State of Indiana

Convey and warrant to

HAROLD L. FARLEY and WINNELL FARLEY,  
husband and wife

of Lake County in the State of Indiana

for and in consideration of Ten Dollars (\$10) and other good and  
valuable consideration the receipt whereof is hereby acknowledged,  
the following Real Estate in Lake County, in the State of Indiana,  
to-wit:

Lot 2 in Block 5 in Roxana 1st Addition to Hammond, as per plat  
thereof, recorded in Plat Book 20 page 24, in the Office of the  
Recorder of Lake County, Indiana  
Key No. 35-361-2, Unit No. 26

commonly known as: 7507 Marshall Avenue, Hammond, Indiana

Subject to: 1994 payable 1995 real estate taxes and all  
subsequent years thereto;

Building setback line affecting the West 25  
feet;

All building lines, conditions, covenants,  
easements, limitations, provisions,  
restrictions, rights of way, and terms of  
record, if any

Dated this 20th day of SEPTEMBER, 1995

*Hector Mendoza*  
HECTOR MENDOZA, Seller

*Lisa Mendoza*  
LISA MENDOZA, Seller

State of Indiana )  
County of Lake ) ss:

Before me, the undersigned, a Notary Public in and for said County  
and State, this 20th day of SEPTEMBER, 1995, personally appeared  
HECTOR MENDOZA and LISA MENDOZA, who acknowledged the execution of  
the foregoing deed. In witness whereof, I have hereunto subscribed  
my name and affixed my official seal.

My commission expires:  
May 16, 1997

*Corina Castel Ramos*  
CORINA CASTEL RAMOS  
Notary Public  
Resident of Lake County

This instrument prepared by Joseph M. Skozen, 730 Seberger Drive,  
Munster, Indiana 46321

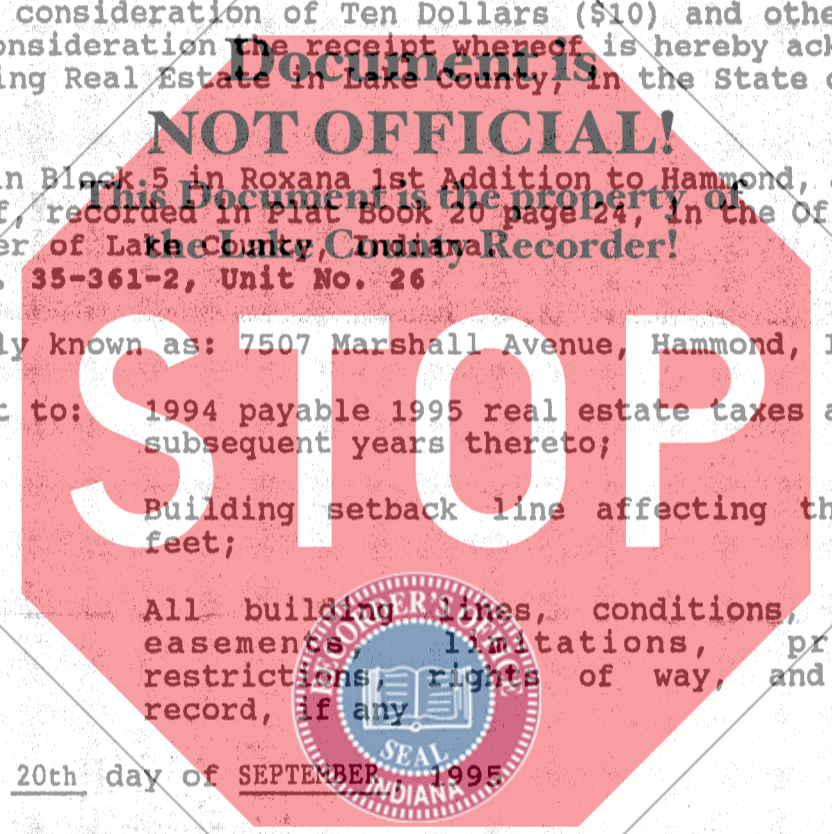

95057487

95 SEP 25 AM 11:06

STATE OF INDIANA  
LAKE COUNTY  
FILED FOR RECORD

MARGARET J. CLEVELAND  
RECORDER

