

# QUITCLAIM DEED

95056941

THIS QUITCLAIM DEED, Executed this 14th day of September, 1995

by first party, Patricia Ann Maretich

whose post office address is 1433 E. 28th Avenue, Lake Station, IN 46405

to second party, Victoria and Jose A. Medina, Husband & Wife as tenants in entire

whose post office address is 1433 E. 28th Avenue, Lake Station, IN 46405

STATE OF INDIANA  
LAKE COUNTY  
FILED FOR RECORD  
95 SEP 21 PM 3:44  
MARCO RECORDED

WITNESSETH, That the said first party, for good consideration and for the sum of Ten & 00/100 Dollars (\$ 10.00 ) paid by the said second party, the receipt whereof is hereby acknowledged, does hereby remise, release and quitclaim unto the said second party forever, all the right, title, interest and claim which the said first party has in and to the following described parcel of land, and improvements and appurtenances thereto in the County of Lake, State of Indiana to wit:

2nd Subdivision E. Gary L.2 Bl.24

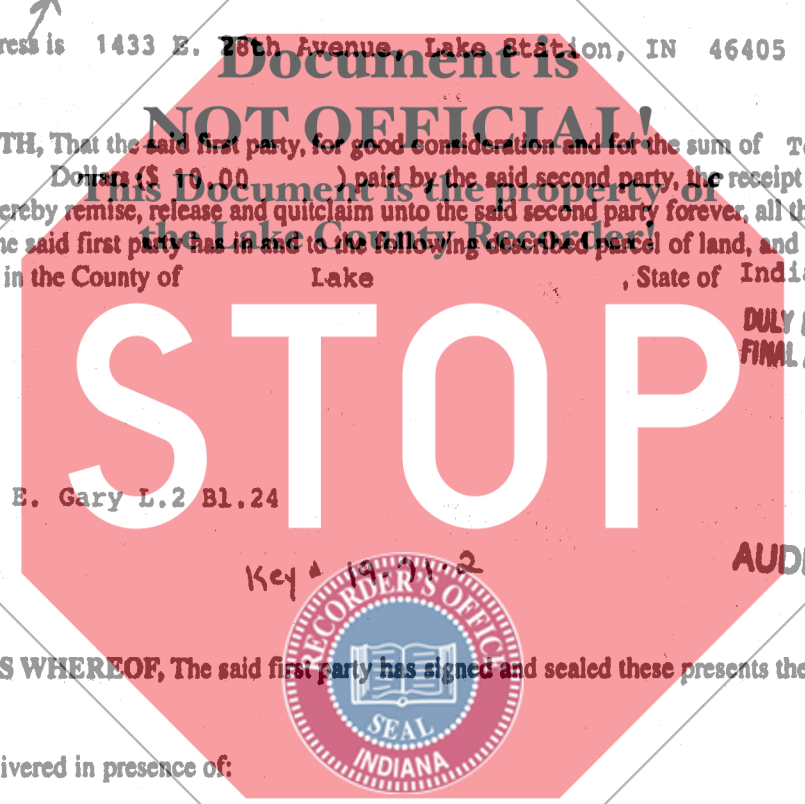

DULY ENTERED FOR TAXATION SUBJECT TO FINAL ACCEPTANCE FOR TRANSFER.  
SEP 21 1995  
SAM ORLICH  
AUDITOR LAKE COUNTY

IN WITNESS WHEREOF, The said first party has signed and sealed these presents the day and year first above written.

Signed, sealed and delivered in presence of:

John M. Masson  
Witness

Patricia Ann Maretich  
First Party

[Signature]  
Witness

\_\_\_\_\_  
Second Party

State of Indiana )  
County of Porter )  
On 9-14-95

before me,  
appeared PATRICIA ANN MARETICH  
personally known to me (or proved to me on the basis of satisfactory evidence) to be the person(s) whose name(s) is/are subscribed to the within instrument and acknowledged to me that he/she/they executed the same in his/her/their authorized capacity(ies), and that by his/her/their signature(s) on the instrument the person(s), or the entity upon behalf of which the person(s) acted, executed the instrument.  
WITNESS my hand and official seal.

Signature [Signature]  
Signature of Notary

Affiant Known Produced ID  
Type of ID Driver License # 8935-98-8a11  
(Seal)

