

THIS FORM HAS BEEN APPROVED BY THE INDIANA STATE BAR ASSOCIATION FOR USE BY LAWYERS ONLY. THE SELECTION OF A FORM OF INSTRUMENT, FILLING IN BLANK SPACES, STRIKING OUT PROVISIONS AND INSERTION OF SPECIAL CLAUSES, CONSTITUTES THE PRACTICE OF LAW AND MAY ONLY BE DONE BY A LAWYER.

Mail tax bills to:

Tax Key No. _____

3859 Delaware St.
Gary, IN 46409

WARRANTY DEED

This indenture witnesseth that

CHARLES MOTE

of Porter County in the State of Indiana

Convey and warrant to

GEORGE A. NICHOLS

of Lake County in the State of Indiana
for and in consideration of One Dollar (\$1.00) and other good and valuable consideration the receipt whereof is hereby acknowledged, the following Real Estate in Lake County in the State of Indiana, to wit:

Lot 33 and the South 1/2 of Lot 34 in Block 12 in Second Highland Park Addition to Gary, as per plat thereof, recorded in Plat Book 8 page 23, in the Office of the Recorder of Lake County, Indiana.

And commonly known as 3859 Delaware St., Gary, IN 46409

Subject to all applicable taxes, assessments, easements, rights of way, restrictive covenants, building and use ordinances and statutes, and agreements of record.

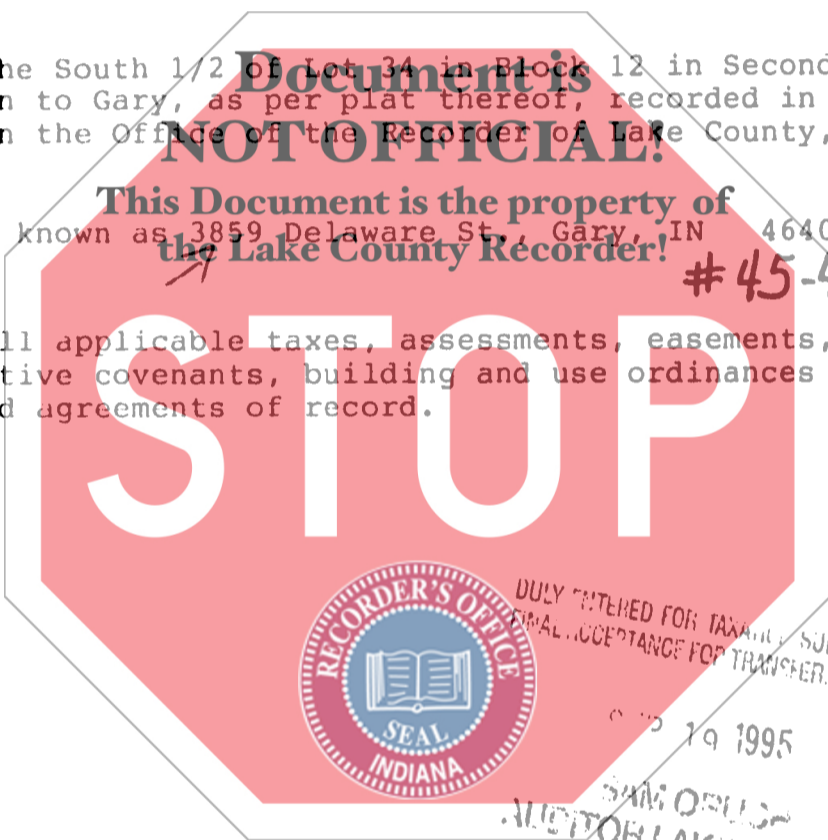

State of Indiana, PORTER County, ss:
Before me, the undersigned, a Notary Public in and for said County and State, this 23rd day of August 19 95 personally appeared:

Charles Mote

Dated this 23 Day of August 19 95

Charles Mote
Charles Mote

And acknowledged the execution of the foregoing deed. In witness whereof, I have hereunto subscribed my name and affixed my official seal. My commission expires November 25 19 98

Roberta M. Back
Roberta M. Back Notary Public

Resident of Porter County.

001242

This instrument prepared by Hollis E. Back Attorney at Law
3109 Willowcreek Road, Portage, IN 46368
(219) 763-2529

MAIL TO: