

# ASSIGNMENT OF REAL ESTATE MORTGAGE

This Deed of Assignment and Assignment of Real Estate Mortgage, made and entered into this 28 day of August, 1995, by and between CALUMET SECURITIES CORPORATION, party of the first part, and , party of the second part.

WITNESSETH: That for valuable consideration, the receipt of which is hereby acknowledged, the party of the first part does hereby assign, transfer, and set over unto the said , its successors and assigns, a certain Mortgage Note dated the 28 day of August, 1995 executed and delivered to CALUMET SECURITIES CORPORATION, by Brian H. Schumann and Karen J. Schumann, husband and wife, and assigned to CARL L BROWN AND COMPANY, said Note bearing interest at the rate of 8.000% percent, per annum, payable monthly, and maturing on the 1 day of September, 2025; together with the mortgage securing the payment of same recorded in Mortgage Book 95051393, page \_\_\_\_\_, in the office of the County Clerk of Lake County, Indiana, on the 1st day of September 1995; and all sums of money due to become due thereon.

IN TESTIMONY WHEREOF, witness the signature of the party of the first part the day and year first above written.

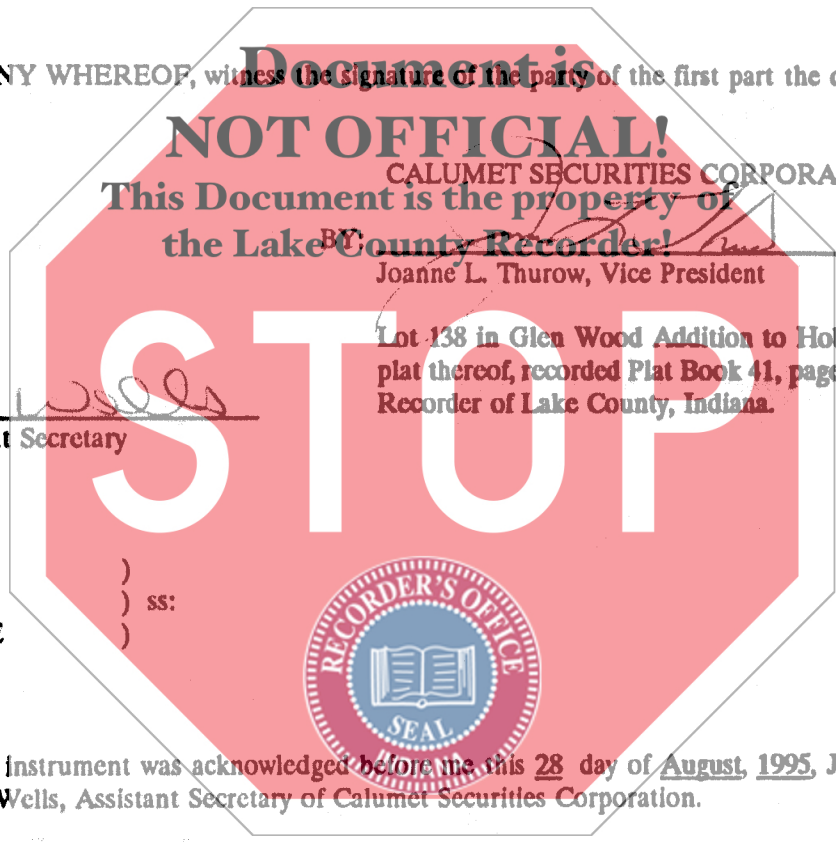

95052142

Lot 138 in Glen Wood Addition to Hobart, Unit No. 4 per plat thereof, recorded Plat Book 41, page 72, in the Office of the Recorder of Lake County, Indiana.

ATTEST:

Debbie Wells  
Debbie Wells, Assistant Secretary

State of Indiana )  
County of LAKE ) ss:

The foregoing instrument was acknowledged before me this 28 day of August, 1995, Joanne Thurow, Vice President and Debbie Wells, Assistant Secretary of Calumet Securities Corporation.

My Commission Expires:  
8-22-99  
Resident of LAKE County

Susan M. Charlebois  
Susan M. Charlebois Notary Public

This Instrument Prepared By: ROBERT G. JONES, JR., AS AGENT FOR CALUMET SECURITIES CORPORATION, P. O. Box 208, SCHERERVILLE, INDIANA 46375

STATE OF INDIANA  
LAKE COUNTY  
FILED FOR RECORDED  
95 SEP 21 1995  
MARGARET J. HIND  
RECORDER

Ticon/CP/KR/945455-

10.00  
T