

MAIL TAX BILLS TO:

TAX KEY NO. 27-286-10

Mrs. Alice M. Wagner, as Trustee  
3547 - 41st Street  
Highland, Indiana 46322

QUIT CLAIM DEED

This indenture witnesseth that ALICE M. WAGNER,

of Lake County in the State of Indiana

Releases and quit claims to ALICE M. WAGNER, As Trustee under a Revocable Trust Agreement dated the 5th day of September, 1995,

of Lake County in the State of Indiana

for and in consideration of Ten Dollars (\$10.00) and other good and valuable consideration the receipt whereof is hereby acknowledged, the following Real Estate in Lake County in the State of Indiana, to wit:

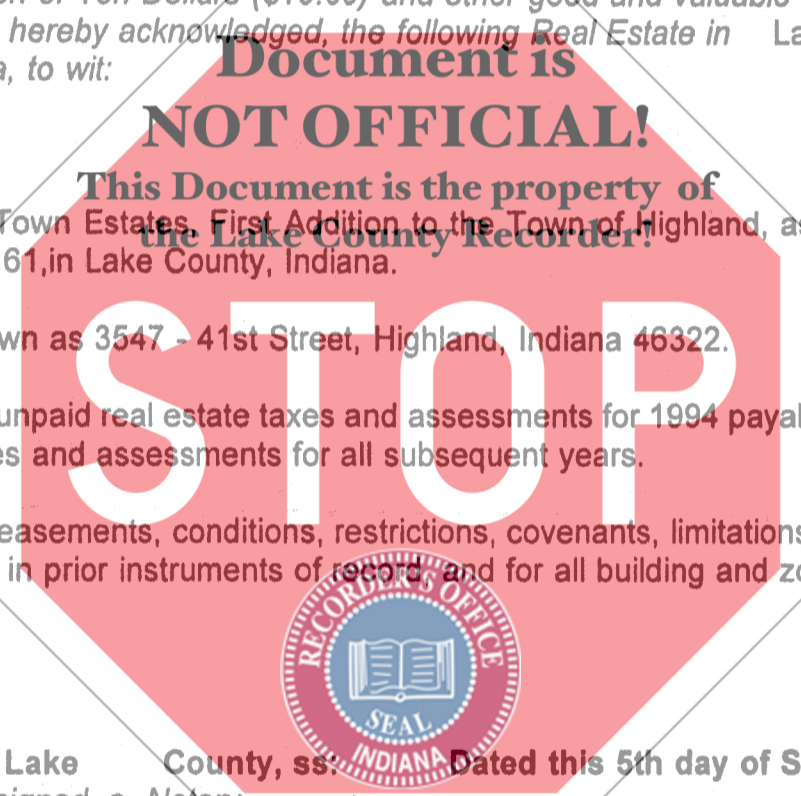

Lot 10, South Town Estates, First Addition to the Town of Highland, as shown in plat Book 32, page 61, in Lake County, Indiana.

Commonly known as 3547 - 41st Street, Highland, Indiana 46322.

Subject To: all unpaid real estate taxes and assessments for 1994 payable in 1995, and for all real estate taxes and assessments for all subsequent years.

Subject To: all easements, conditions, restrictions, covenants, limitations and building setback lines contained in prior instruments of record, and for all building and zoning ordinances.

95052248

State of Indiana, Lake County, ss: Dated this 5th day of September, 1995  
Before me, the undersigned, a Notary Public in and for said County and State, this 5th day of September, 1995, personally appeared:

ALICE M. WAGNER,

And acknowledged the execution of the foregoing deed. In witness whereof, I have hereunto subscribed my name and affixed my official seal.  
My commission expires: 12/19/98

*Sue A. Langer*  
Sue A. Langer, Notary Public

Resident of Lake County

This instrument prepared by: Rhett L. Tauber, Esq., Anderson, Tauber & Woodward, P.C.  
8935 Broadway, Merrillville, IN 46410/(219) 769-1892

*Alice M. Wagner*  
ALICE M. WAGNER  
DULY ENTERED FOR TAXATION SUBJECT TO FINAL ACCEPTANCE FOR TRANSFER.  
SEP 6 1995  
SAM ORLICH  
AUDITOR LAKE COUNTY

STATE OF INDIANA  
LAKE COUNTY  
FILED FOR RECORD  
REC'D  
SEP 6 1995 1:33



000304

101