

194998 TICOR/CP/KK

**WARRANTY DEED**

**This Indenture Witnesseth**

That DANIEL P. GUSHEE and NANCY I. GUSHEE, Husband and Wife, of Lake County, and State of Indiana, convey & warrant to MARK R. ANDERSON and TAMARA L. ANDERSON, Husband and Wife, of Lake County, in the State of Indiana, for and in consideration of TEN DOLLARS (\$10.00) and other valuable consideration, the following described REAL ESTATE in Lake County, in the State of Indiana, to-wit:

Lot 17 in Lemon Lake Estates Unit 2, an Addition to the Town of Cedar Lake, as per plat thereof, recorded in Plat Book 45, page 138, in the Office of the Recorder of Lake County, Indiana (Unit No. 31, Key No. 25-288-9).

Commonly known as 12979 Colfax Street, Cedar Lake, IN 46304.

Subject to:

Covenants and restrictions; easements for streets and utilities, and building lines, as set forth in the plat of subdivision and as set forth in all other documents of record; and taxes for 1995 and thereafter.

**Mail Tax Statements To:** Mark R. and Tamara L. Anderson, \_\_\_\_\_

**In Witness Whereof**, the said Daniel P. Gushee and Nancy I. Gushee, Husband and Wife, have hereunto set their hands and seals, this 30th day of August, 1995.

*Daniel P. Gushee* (Seal)  
Daniel P. Gushee

*Nancy I. Gushee* (Seal)  
Nancy I. Gushee

STATE OF INDIANA, COUNTY OF LAKE, SS:

Before me, the undersigned, a Notary Public in and for said County and State, personally appeared the within named Daniel P. Gushee and Nancy I. Gushee, Husband and Wife, who acknowledged the execution of the foregoing Deed to be their voluntary act and deed.

Witness my hand and Notarial seal this 30th day of August, 1995.

My Commission Expires:

6/16/96

County of Residence: Lake

**This instrument prepared by:** Marc H. Donaldson, Attorney at Law.

*Doris Surowiec*  
(signature)

Doris Surowiec  
(printed)

SEP 5 1995  
SAM ORLICH  
AUDITOR  
LAKE COUNTY

000159

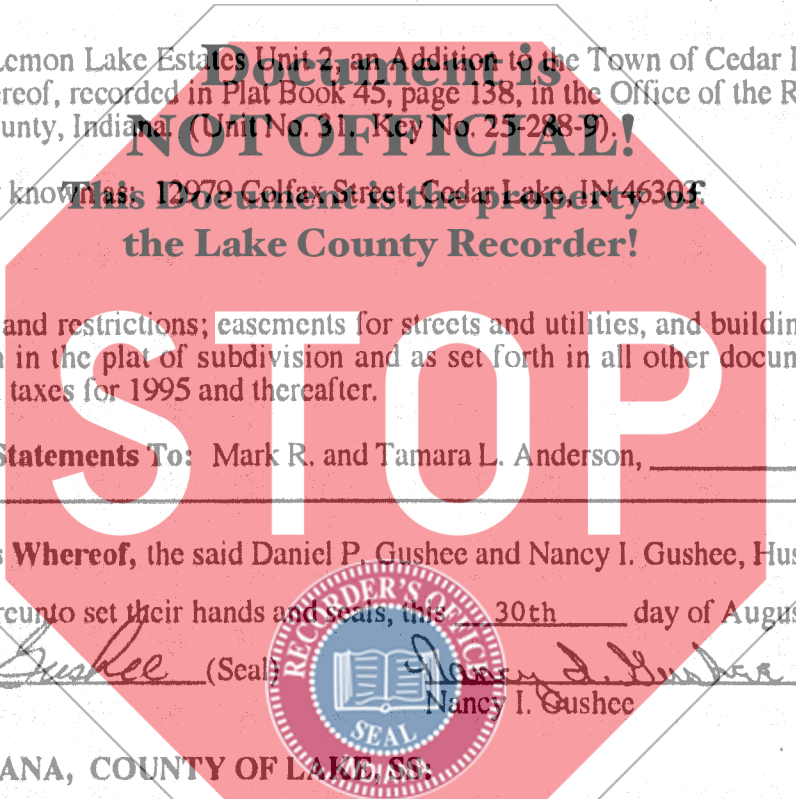
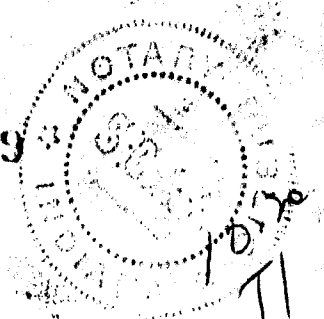

95051956

MARGARET L. REED  
RECORDER

95 SEP -6 AM 10:09

STATE OF INDIANA  
LAKE COUNTY  
FILED FOR RECORD