

THIS FORM HAS BEEN PREPARED FOR USE WITHIN THE STATE OF INDIANA. THE SELECTION OF A FORM OF INSTRUMENT, FILLING IN BLANK SPACES, STRIKING OUT PROVISIONS, AND INSERTION OF SPECIAL CLAUSES, MAY CONSTITUTE THE PRACTICE OF LAW AND SHOULD ONLY BE DONE BY A LAWYER.

MAIL TAX BILLS TO:

Peggy McNary

TAX KEY NO: 15-182-16

6231 Glen Dr

QUIT-CLAIM DEED

Merrillville IN 46410

This indenture witnesseth that PAULINE ADELE McNARY, married to Henry Nathaniel McNary, Jr., up to and including the date of his death

of Lake County in the State of Indiana

Releases and quit claims to TERRY CHAMBERLAIN, an undivided one-fourth; THOMAS McNARY, an undivided one-fourth; TIMOTHY McNARY, an undivided one-fourth; PEGGY VARELLA, an undivided one-fourth; the parties to hold as Tenants in Common, and subject to a life estate reserved in the said PAULINE ADELE McNARY, Grantor herein.

of Lake County in the State of Indiana

for and in consideration of Ten (\$10) Dollars and for all other good and valuable consideration the receipt whereof is hereby acknowledged, the following Real Estate in Lake County in the State of Indiana, to wit:

Lot 16 and Lot 15 in Glenellyn, Lake County, Indiana, as per plat thereof, recorded in Plat Book 25 page 46 in the Recorder's Office of Lake County, Indiana and more commonly known as 6231 Glen Drive, Merrillville, Indiana 46410.

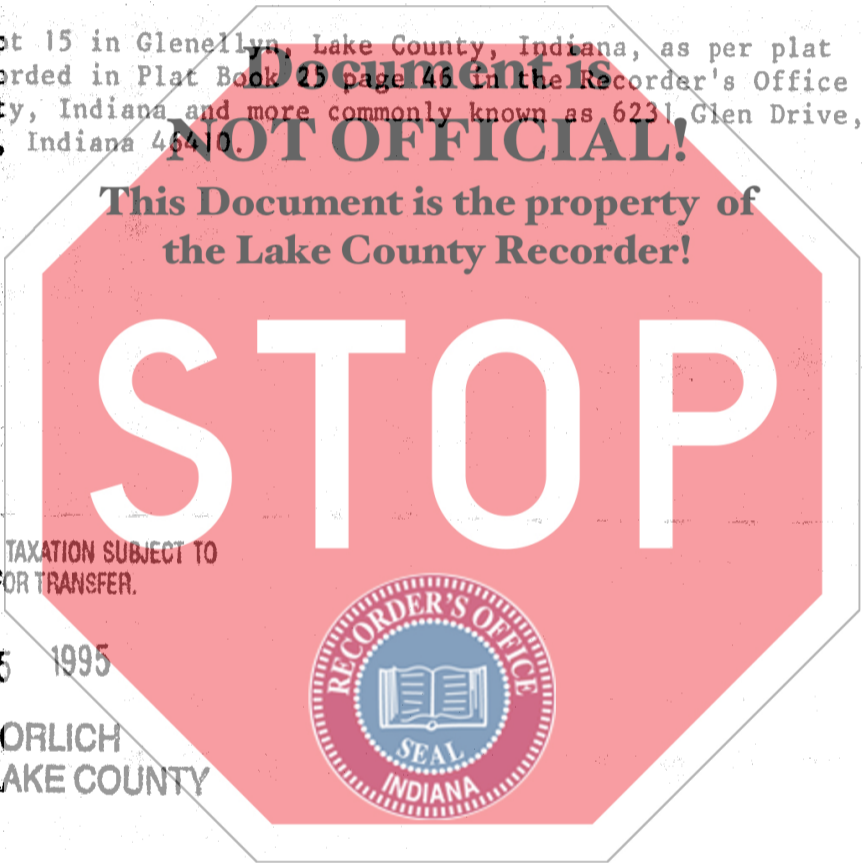

DULY ENTERED FOR TAXATION SUBJECT TO FINAL ACCEPTANCE FOR TRANSFER.

SEP 5 1995

SAM ORLICH
AUDITOR LAKE COUNTY



MARGARET
RECORDER

95051883

95 SEP -5 PM 1:49

STATE OF INDIANA
LAKE COUNTY
FILED FOR RECORD

State of Indiana, LAKE County, ss:

Dated this 24th Day of March 1995

Before me, the undersigned, a Notary Public in and for said County and State, this 24th day of March 1995 personally appeared:

PAULINE ADELE McNARY, married to Henry Nathaniel McNary, Jr., up to and including the date of his death

PAULINE ADELE McNARY, married to Henry Nathaniel McNary, Jr., up to and including the date of his death

Pauline Adele McNary

And acknowledged the execution of the foregoing deed. In witness whereof, I have hereunto subscribed my name and affixed my official seal. My commission expires May 16 1996

Patricia A. Potulock
Notary Public

Resident of Lake County

This instrument prepared by Timothy S. Schafer, 5875 Broadway, Merrillville, IN 46410 Attorney at Law

MAIL TO:

000222

102