

3
County: Grant
201 N. Main St. A.
Gr. No 46357

STATE OF INDIANA)
)SS:
COUNTY OF LAKE)

BEFORE THE LAKE COUNTY,
INDIANA, COUNCIL
(Petitioners: Allen and Norma Westerhoff)

CONTRACTUAL COMMITMENT

RECITALS

WHEREAS, Allen and Norma Westerhoff, Petitioners herein, are the Owners of a parcel of real property located at the southwest quadrant at the intersection of Belshaw Road and Austin Street in West Creek Township, Lake County, Indiana, which is legally described on Exhibit "A" attached hereto; and

WHEREAS, the subject real property owned by Petitioners, Allen Westerhoff and Norma Westerhoff, is a parcel located in an A-1 and C-2 Zoning District in West Creek Township, Lake County, Indiana; and

WHEREAS, Petitioners, Allen and Norma Westerhoff, have applied to the County of Lake, through its Plan Commission, for a Zone Map Amendment from A-1 and C-2 Zoning District Classification to R-1 Single Family Residential Zoning District Classification; and

WHEREAS, Petitioners, Allen and Norma Westerhoff, appeared before the Lake County Plan Commission for a Public Hearing on the Application for Zone Map Amendment from A-1 and C-2 Zoning District Classification to R-1 Single-Family Residential Zoning District Classification on May 9, 1995, for consideration of the Application for Zone Map Change at the above-described real property; and

WHEREAS, pursuant to the provisions of Indiana Code 36-7-4-613 and 614, as each are amended from time to time, Petitioners submit and agree with the entry into and execution of a written Contractual Commitment concerning their Application for Zone Map Change.

NOW, THEREFORE, in consideration of the approval of the Application for Zone Map Change of Petitioners, Allen and Norma Westerhoff, from A-1 and C-2 Zoning District Classifications to R-1 Single-Family Zoning District Classification at the above-described real property in West Creek Township, Lake County, Indiana, and for other good and valuable consideration, the receipt of which is hereby acknowledged, Petitioners, Allen and Norma Westerhoff, do hereby agree as follows:

1. That the following restriction shall be applied to the real property of Petitioners, Allen and Norma Westerhoff, at the above-described real property in West Creek Township, Lake County, Indiana, namely:

FILED

JUL 6 1995

SAM ORLICH
AUDITOR LAKE COUNTY

95037807

95 JUL - 6 AM 11: 38

STATE OF INDIANA
LAKE COUNTY
FILED FOR RECORD

MARGARETTE CLEGG
RECORDER

1300

000298

a. That there shall be no further subdivision of the parcel of real property above-described, and commonly known as Westerhoff Acres 1st Addition Subdivision, unless or until the same would be approved by the duly authorized planning authority with planning/subdivision approval jurisdiction over the subject real property.

2. That the approved Zone Map Change for Petitioners, Allen and Norma Westerhoff, for the subject real property herein, and the terms of this Contractual Commitment, shall be binding upon Petitioners, Allen and Norma Westerhoff, and all Persons or Parties claiming by or through them, in the use of the real property, and further, shall be binding upon any Successors to said real estate; and

3. That this Contractual Commitment concerning the above-described real property in West Creek Township, Lake County, Indiana, and legally described in Exhibit "A" attached hereto, shall be filed and recorded in the Office of the Recorder of Lake County, Indiana, upon its acceptance by the County of Lake, State of Indiana.

ALL OF WHICH IS AGREED TO THIS 15TH DAY OF May, 1995.
the Lake County Recorder!

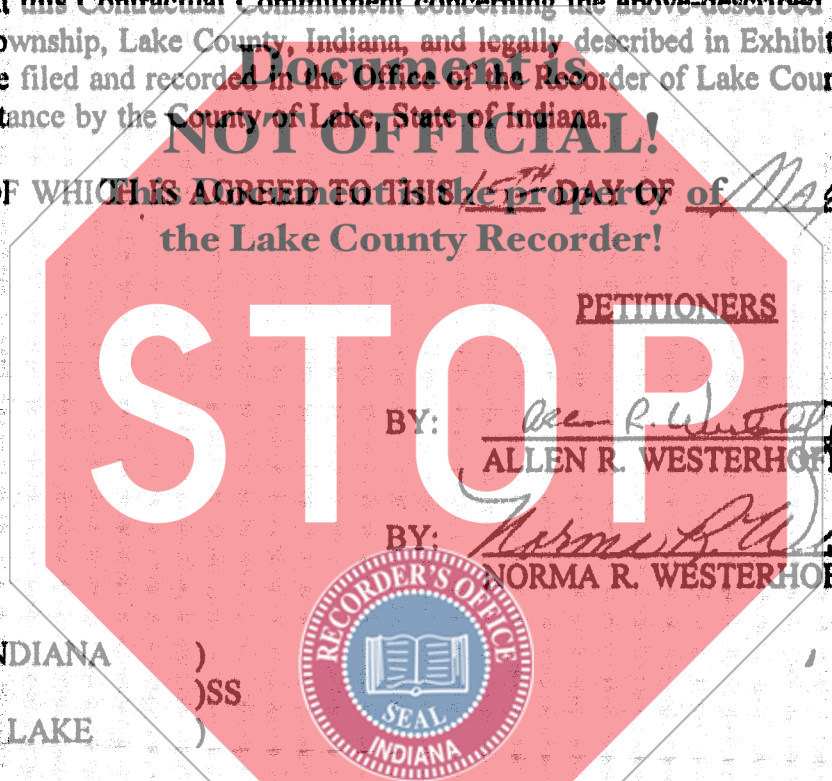

PETITIONERS

BY: Allen R. Westerhoff
ALLEN R. WESTERHOFF

BY: Norma R. Westerhoff
NORMA R. WESTERHOFF

STATE OF INDIANA)
)SS
COUNTY OF LAKE)



Before me, a Notary Public, in and for said County and State, personally appeared ALLEN R. WESTERHOFF and NORMA R. WESTERHOFF, and acknowledged the execution of the foregoing instrument. In Witness whereof, I have hereunto subscribed my name and affixed my official seal.

My Commission Expires:
3-6-99

Susan D. Padalino
Notary Public
A resident of Lake County
Susan D. Padalino
Printed Signature

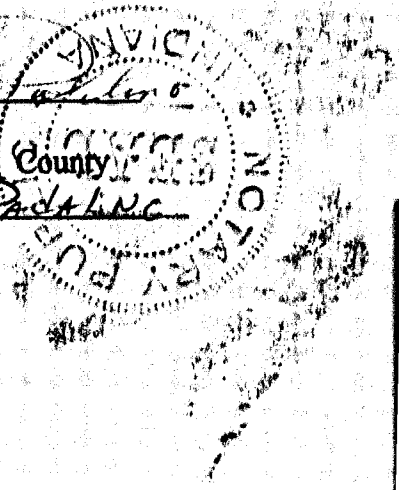

LEGAL DESCRIPTION

A PARCEL OF LAND IN THE WEST HALF OF THE NORTHWEST QUARTER OF SECTION 3, TOWNSHIP 32 NORTH, RANGE 9 WEST OF THE SECOND PRINCIPAL MERIDIAN, IN WEST CREEK TOWNSHIP, LAKE COUNTY, INDIANA, MORE PARTICULARLY DESCRIBED AS FOLLOWS: COMMENCING AT A SPIKE FOUND AT THE SOUTHEAST CORNER OF SAID WEST HALF OF THE NORTHWEST QUARTER (AS OCCUPIED); THENCE NORTH 00 DEGREES 53 MINUTES 10 SECONDS EAST ALONG THE EAST LINE OF SAID WEST HALF OF THE NORTHWEST QUARTER (AS OCCUPIED), 698.99 FEET TO THE POINT OF BEGINNING; THENCE NORTH 88 DEGREES 48 MINUTES 39 SECONDS WEST, 1243.85 FEET; THENCE NORTH 01 DEGREES 18 MINUTES 05 SECONDS EAST ALONG THE EAST LINE OF A PARCEL CONVEYED IN DOCUMENT NO. 890238, RECORDED DECEMBER 9, 1986 IN THE OFFICE OF THE RECORDER OF LAKE COUNTY, INDIANA (AS OCCUPIED), 803.59 FEET; THENCE NORTH 69 DEGREES 30 MINUTES 37 SECONDS EAST ALONG THE CENTERLINE OF BELSHAW ROAD, 1329.46 FEET; THENCE SOUTH 00 DEGREES 53 MINUTES 10 SECONDS WEST ALONG THE EAST LINE OF SAID WEST HALF OF THE NORTHWEST QUARTER (AS OCCUPIED), 1294.71 FEET TO THE POINT OF BEGINNING.



Key # 1-6-18 #19

Key # 1-163-142