

Tutor HO



# TICOR TITLE INSURANCE

Return To: \_\_\_\_\_

193583

## WARRANTY

## This Indenture Witnesseth

That David J. Wilcox, as Trustee, under the provisions of a Trust Agreement dated the 9th day of November, 1988, and known as Trust No. 143943

of Lake County, and State of Indiana

### CONVEY AND WARRANT

To C. M. S. Developers, Inc., an Illinois Corporation

of Lake County, in the State of Indiana

for the sum of Ten (\$10.00) and other valuable consideration Dollars

the following described REAL ESTATE in Lake County, in the State of Indiana, to-wit: \_\_\_\_\_

95032205

16-27-345-2 ACORE  
FOR LEGAL DESCRIPTION, SEE ATTACHED EXHIBIT A

Subject to: Past and current real estate taxes, Covenants, conditions, restrictions and easements of record,

**Document is the property of the Lake County Recorder!**

The Trustee's covenant of warranty relates only to acts done or committed by said Trustee.

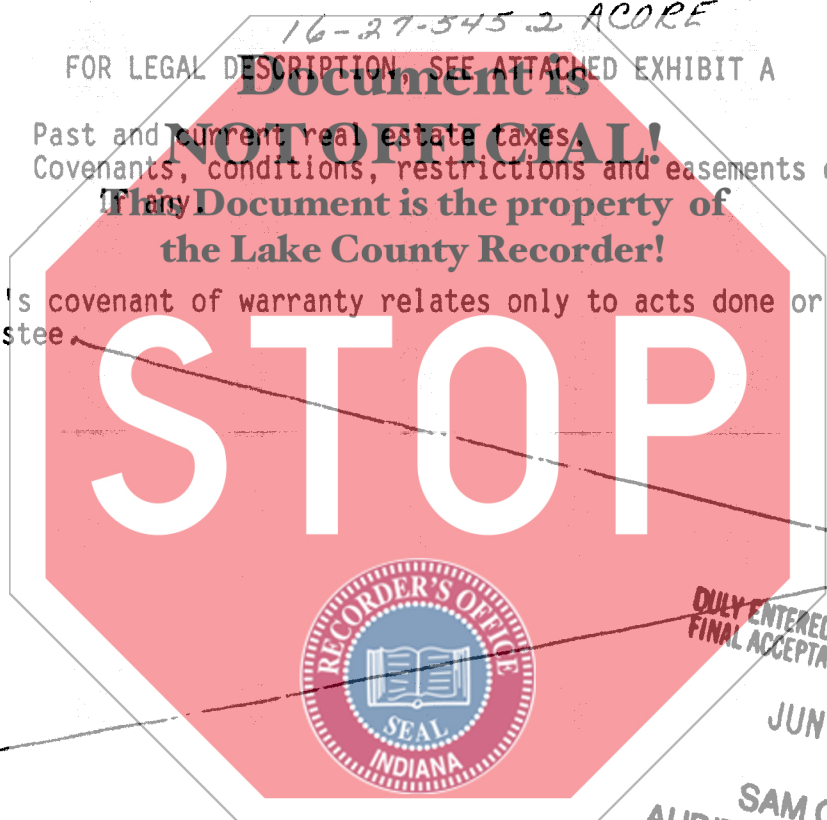

STATE OF INDIANA  
LAKE COUNTY  
FILED FOR RECORD  
RECORDER  
95 JUN -3 AM 9:10

DULY ENTERED FOR TAXATION SUBJECT TO FINAL ACCEPTANCE FOR TRANSFER  
JUN 7 1995

SAM ORLICH  
AUDITOR LAKE COUNTY

IN WITNESS WHEREOF, The said David J. Wilcox, as Trustee, Trust No. 143943

Has hereunto set his Hand and seal this 31st day of May 1995

\_\_\_\_\_  
(SEAL) \_\_\_\_\_ (SEAL)  
DAVID J. WILCOX, AS TRUSTEE (SEAL) \_\_\_\_\_ (SEAL)  
TRUST NO. 143943 (SEAL) \_\_\_\_\_ (SEAL)

STATE OF INDIANA, Lake County, ss:

Before me, the undersigned, a Notary Public in and for said County and State, personally appeared the within named David J. Wilcox, as Trustee, Trust No. 143943

who acknowledged the execution of the foregoing Deed to be his voluntary act and deed.

WITNESS, my hand and Seal this 31st day of May 1995  
My commission expires 3-15 1999  
Robert R. Stiener Notary Public

County of Residence Lake

Mail Tax Statements to 398 West 14th Street, Chicago Heights, IL 60411

This instrument prepared by David J. Wilcox, as Trustee 000357

TICOR TITLE INSURANCE  
Crown Point, Indiana

Handwritten initials/signature

EXHIBIT A

Part of Lot 2, Replat of Lot 2 in Forest Park at 38th, a Planned Unit Development in the Town of Highland, Lake County, Indiana, as recorded in Plat Book 77, page 55 in the Office of the Recorder of Lake County, Indiana, being more particularly described as follows: Commencing at the Northwest corner of said Lot 2; thence South 83 degrees, 40 minutes, 00 seconds East, along the North line of said Lot 2, a distance of 144.59 feet to the point of beginning; thence continuing South 83 degrees, 40 minutes, 00 seconds East, along said North line, a distance of 76.76 feet; thence South 00 degrees, 53 minutes, 45 seconds West, along said North line, a distance of 9.88 feet; thence South 89 degrees, 06 minutes, 15 seconds East, along said North line, a distance of 194.63 feet to the Northwest corner of said Lot 2; thence South 00 degrees, 53 minutes, 45 seconds West, along the East line of said Lot 2, a distance of 75.94 feet; thence South 89 degrees, 06 minutes, 15 seconds East, along said East line, a distance of 55.00 feet; thence South 00 degrees, 53 minutes, 45 seconds West, along said East line, a distance of 297.87 feet to the Southeast corner of said Lot 2; thence North 88 degrees, 44 minutes, 30 seconds West, along the South line of said Lot 2, a distance of 117.84 feet; thence North 00 degrees, 53 minutes, 45 seconds East, parallel to the East line of said Lot 2, a distance of 100.06 feet; thence South 88 degrees, 53 minutes, 52 seconds East, a distance of 25.00 feet; thence North 00 degrees, 53 minutes, 45 seconds East a distance of 109.95 feet to a point of curve; thence Northwesterly along a curve being concave to the Southwest and having a radius of 69.86 feet, an arc distance of 109.29 feet; thence North 88 degrees, 44 minutes, 30 seconds West, a distance of 80.00 feet to a point of curve; thence Southwesterly along a curve being concave to the Southeast and having a radius of 72.50 feet, an arc distance of 70.39 feet; thence North 88 degrees, 44 minutes, 30 seconds West, a distance of 25.05 feet; thence North 01 degrees, 17 minutes, 10 seconds East, a distance of 140.97 feet to the point of beginning, all in the Town of Highland, Lake County, Indiana.

and

commencing at the Southwest corner of said Lot 2; thence South 88 degrees, 44 minutes, 30 seconds East, along the South line of said Lot 2, a distance of 172.50 feet to the point of beginning; thence North 00 degrees, 53 minutes, 45 seconds East, a distance of 33.50 feet to a point of curve; thence Northerly along said curve being concave to the West

EXHIBIT A continued...

and having a radius of 359.43 feet; an arc distance of 71.89 feet to a point of reverse curvature; thence Northerly along said reverse curve being concave to the East and having a radius of 512.50 feet, an arc distance of 30.77 feet; thence South 88 degrees, 53 minutes, 52 seconds East, a distance of 25.42 feet; thence Southerly along a curve being concave to the West and having a radius of 384.43 feet, an arc distance of 66.41 feet; thence South 00 degrees, 53 minutes, 45 seconds West, a distance of 33.58 feet to the South line of said Lot 2; thence North 88 degrees, 44 minutes, 30 seconds West, along the South line of said Lot 2, a distance of 25.00 feet, to the point of beginning, all in the Town of Highland, Lake County, Indiana.

