

Mail tax bills to:
8534 Madison
Munster, IN. 46321

WARRANTY DEED

THIS INDENTURE WITNESSETH, That JOHN E. LICHTLE AND MARLENE A. LICHTLE
Husband and Wife

("Grantor") of Lake County in the State of Indiana
CONVEYS AND WARRANTS TO JOHN C. PLUG, JR. AND CANDICE J. PLUG
Husband and Wife

of Cook County in the State of Illinois
in consideration of One Dollar and other valuable consideration, the receipt and sufficiency of which are hereby acknowledged, the following described real estate in Lake County, in the State of Indiana:

The real estate commonly known as 8534 Madison, Munster, County of Lake, State of Indiana, and more particularly described as follows, to-wit:

Lot 6, Rueth Estates 1st addition, block 1, in the town of Munster, as shown in Plat book 46, Page 21, in Lake County, Indiana. Key No. 28-400-6.

Subject to real estate taxes for 1995 payable in 1996, together with delinquency and penalty, if any and all real estate taxes due and payable thereafter.

Subject to recorded liens, encumbrances, easements, restrictions, ditches and drains, highways and legal rights of way, and matters which would be disclosed by an accurate survey or inspection of the premises.

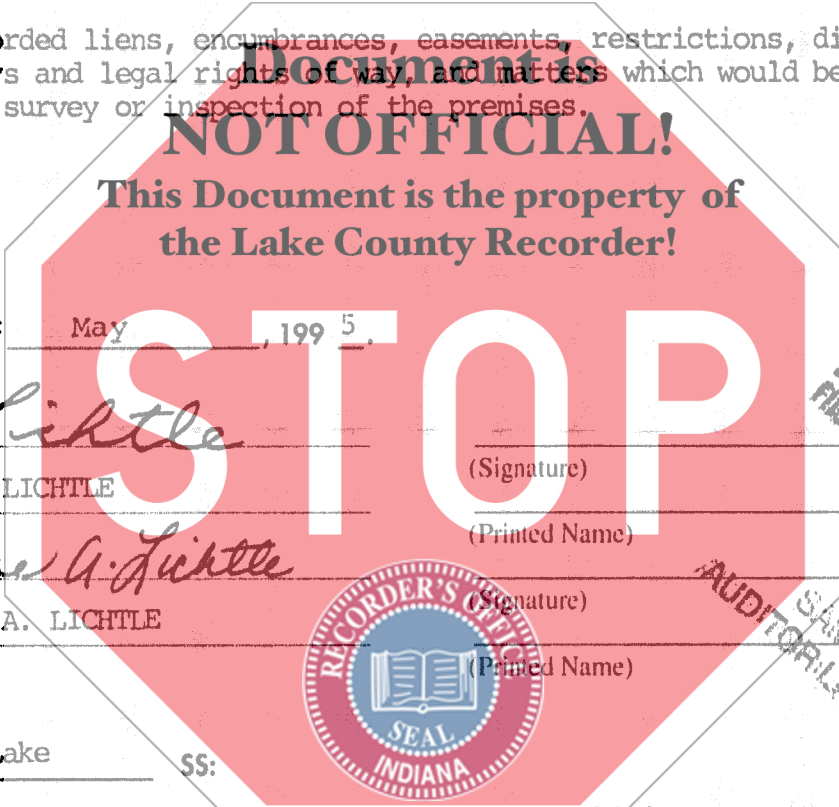

95031137

Chicago Title Insurance Company

Dated this 30th day of May, 1995.

John E. Lichtle
(Signature) JOHN E. LICHTLE
(Printed Name)

Marlene A. Lichtle
(Signature) MARLENE A. LICHTLE
(Printed Name)

STATE OF INDIANA
LAKE COUNTY
FILED FOR RECORD
95 JUN - 2 10:14
DULY ENTERED FOR PARTITION PUBLIC
FINAL JUDGEMENT FOR TRANSFER
JUN 7 1995
SANDY CELICH
AUDITOR LAKE COUNTY

STATE OF INDIANA
COUNTY OF Lake SS:

Before me, the undersigned, a Notary Public in and for said County and State, this 30th day of May, 1995, personally appeared: JOHN E. LICHTLE AND MARLENE A. LICHTLE
Husband and Wife and acknowledged the execution of the foregoing deed. In witness whereof, I have hereunto subscribed my name and affixed my official seal.

My commission expires: 12-17-97 Signature *Roberta S. Tate*
Resident of Porter County Printed Roberta S. Tate, Notary Public

STATE OF _____
COUNTY OF _____ SS:

Before me, the undersigned, a Notary Public in and for said County and State, this _____ day of _____, 199____, personally appeared: _____ and acknowledged the execution of the foregoing deed. In witness whereof, I have hereunto subscribed my name and affixed my official seal.

My commission expires: _____ Signature _____
Resident of _____ County Printed _____, Notary Public

This instrument prepared by Thomas K. Hoffman, One Professional Center, Crown Point, IN Attorney at Law
Attorney Identification No. 7731-45

MAIL TO:

000091 700 *ht*