

NOTICE OF INTENTION TO HOLD MECHANIC'S LIEN

February 28, 1995

To Bill C. and Karen Farris
5515 W/ 41st Avenue
Gary, Indiana 46408

and all others concerned.

You are Hereby Notified, That I (we) intend to hold a Mechanic's Lien on the following described real estate: THE EAST 1/2 OF THE NORTHEAST 1/4 OF SECTION 35, TOWNSHIP 33 NORTH, RANGE 9 WEST OF THE 2ND P.M. IN LAKE COUNTY INDIANA, LYING NORTH OF THE CENTER LINE OF THE PUBLIC HIGHWAY KNOWN AS BELSHAW ROAD, EXCEPTING THEREFROM THE RIGHT OF WAY OF THE CHICAGO AND INDIANAPOLIS, AND LOUISVILLE RAILWAY COMPANY, AND ALSO EXCEPTING THEREFROM THAT PART LYING NORTH OF THE RIGHT OF WAY OF THE CHICAGO AND INDIANAPOLIS AND LOUISVILLE RAILWAY COMPANY AND ALSO EXCEPTING THEREFROM THE FOLLOWING DESCRIBED PARCELS A, B, AND C. SEE ATTACHED THE SAME BEING KNOWN ALSO AS 6704 Belshaw Road, Lovett, Indiana together with all of the improvements thereon. The amount claimed by Lienor for which he holds the above named person liable is Five Thousand Seven Hundred Thirty One & 50/100 Dollars (\$5,731.50)

and is for work done and/or materials furnished by Lienor for the improvement of the above described real estate within the last sixty (60) days.

EXECUTED this 28th day of February, 1995

Attest: L. Scott Electric Co., Inc. Firm Name

(Written)

Signature of Owner, Partner or Officer

Ulle L. Scott

(Printed)

(Printed)

STATE OF INDIANA

COUNTY OF Lake

SS: 3779 Rutledge Street, Gary, Indiana
(Address of Lienor) 46408

Before me, a Notary Public in and for said County and State, personally appeared Ulle L. Scott and being duly sworn upon his oath says he is the person who executed the foregoing notice of mechanic's lien, that he has read the same and that the statements therein contained are true.

WITNESS my hand and Notarial Seal this 28th day of February, 1995

My Commission expires MAY 12, 1996 Notary Public (Written)

Residence: Lake County (Printed)

This instrument prepared by Janet Scott

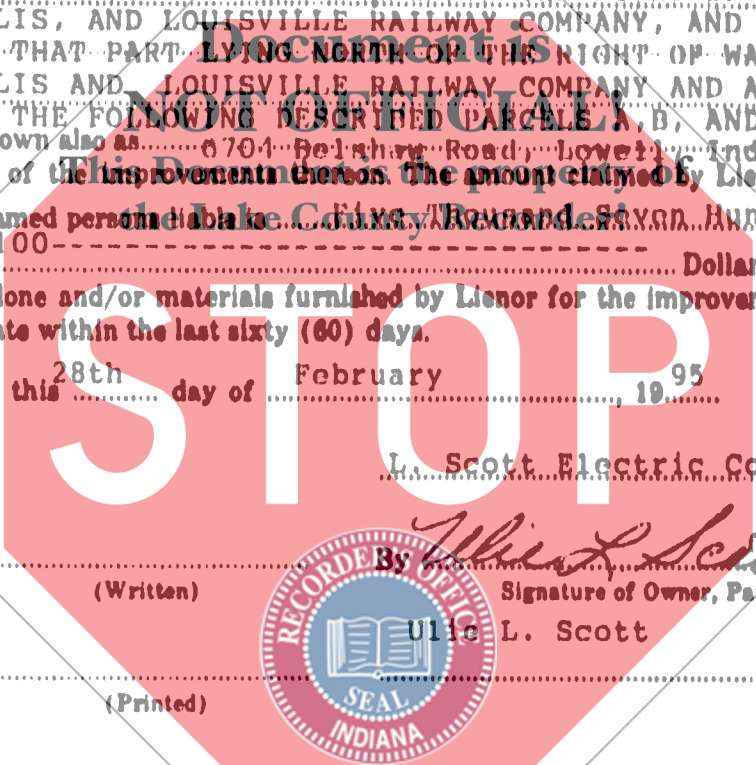

95010748
FILED FOR RECORD
STATE OF INDIANA
LAKE COUNTY
FEB 28 PM 12:13

201

PARCEL A:

COMMENCING AT THE SOUTHWEST CORNER OF THE SOUTHEAST 1/4 OF THE NORTHEAST 1/4 OF SAID SECTION 35, THENCE NORTH 161.5 FEET TO A POINT IN THE CENTER LINE OF BELSHAW ROAD FOR A POINT OF BEGINNING; THENCE CONTINUING NORTH ALONG THE WEST LINE OF SAID SOUTHEAST 1/4 OF THE NORTHEAST 1/4, 328.8 FEET, THENCE EAST 635 FEET; THENCE SOUTH 82.8 FEET TO A POINT IN THE CENTER LINE OF BELSHAW ROAD, THENCE SOUTHWESTERLY 672.6 FEET TO THE POINT OF BEGINNING.

PARCEL B:

COMMENCING AT A POINT WHICH IS THE INTERSECTION OF THE EAST LINE OF THE EAST 1/2 OF THE NORTHEAST 1/4 OF SAID SECTION 35 AND THE SOUTHWESTERLY RIGHT OF WAY LINE OF THE C.I. & L. (MONON) RAILROAD, THENCE SOUTH ALONG THE EAST LINE OF SAID EAST 1/2 OF THE NORTHEAST 1/4 A DISTANCE OF 166.1 FEET TO THE CENTER LINE OF BELSHAW ROAD, THENCE SOUTHWESTERLY ALONG THE CENTER LINE OF BELSHAW ROAD A DISTANCE OF 663.75 FEET, THENCE NORTH ALONG A LINE WHICH MAKES AN ANGLE OF 66 DEGREES 18 MINUTES 15 SECONDS WITH THE PREVIOUS DESCRIBED LINE, A DISTANCE OF 480.81 FEET, THENCE EAST ALONG A LINE WHICH IS A RIGHT ANGLE TO THE PREVIOUS DESCRIBED LINE A DISTANCE OF 549.23 FEET TO THE SOUTHWESTERLY RIGHT OF WAY LINE OF SAID RAILROAD, THENCE SOUTHEASTERLY ALONG SAID RIGHT OF WAY LINE A DISTANCE OF 68.65 FEET TO THE POINT OF BEGINNING.

PARCEL C:

COMMENCING AT A POINT WHICH IS THE INTERSECTION OF THE EAST LINE OF THE EAST 1/2 OF THE NORTHEAST 1/4 OF SECTION 35, TOWNSHIP 33 NORTH, RANGE 9 WEST OF THE 2ND P.M., AND THE SOUTHWESTERLY RIGHT OF WAY LINE OF THE C.I. & L. (MONON) RAILROAD, THENCE SOUTH ALONG THE EAST LINE OF SAID EAST 1/2 OF THE NORTHEAST 1/4 A DISTANCE OF 166.1 FEET (DEED), TO THE CENTER LINE OF BELSHAW ROAD, THENCE SOUTHWESTERLY ALONG THE CENTERLINE OF BELSHAW ROAD, A DISTANCE OF 663.75 FEET (DEED); THENCE NORTH ALONG A LINE WHICH MAKES AN ANGLE OF 66 DEGREES 18 MINUTES 15 SECONDS (DEED) WITH THE PREVIOUSLY DESCRIBED LINE, A DISTANCE OF 480.81 FEET (DEED) TO AN EXISTING IRON PIPE, BEING THE POINT OF BEGINNING; THENCE CONTINUING NORTH, ALONG THE EXTENSION NORTHERLY OF THE PREVIOUSLY DESCRIBED LINE, A DISTANCE OF 374 FEET; THENCE EASTERLY A DISTANCE OF 267.4 FEET TO THE AFORESAID SOUTHEASTERLY RAILROAD RIGHT OF WAY LINE; THENCE SOUTHEASTERLY ALONG THE AFORESAID RAILROAD RIGHT OF WAY LINE, A DISTANCE OF 475.86 FEET TO AN EXISTING IRON PIPE; THENCE WESTERLY, A DISTANCE OF 549.23 FEET TO THE POINT OF BEGINNING. ALL IN LAKE COUNTY, INDIANA.