

Recording requested by / Return to:
Peelle Management Corporation (90317)
P.O. Box 1710, Campbell, CA 95009-1710

Send Any Notices to Assignee.

Assignment of Mortgage

For Good and Valuable Consideration, the sufficiency of which is hereby acknowledged, the undersigned,

FLEET MORTGAGE CORP., a Rhode Island corporation
whose address is 11200 W. Parkland Avenue, Milwaukee, WI 53224 (Assignor)
by these presents does convey, grant, bargain, sell, assign, transfer and set over the described
mortgage, together with the certain note(s) described therein with all interest, all liens, and any rights
due or to become due thereon to:

SOURCE ONE MORTGAGE SERVICES CORPORATION, a Delaware corporation (Assignee)
27555 Farmington Road, Farmington Hills, MI 48334-3357
Said mortgage is recorded in the State of IN, County of Lake
on 10/03/91 as Instrument/series/file: 91049941
Original Mortgagor--: Gregory J. Branson, Cynthia L. Branson
Original Mortgagee--: FLEET NATIONAL BANK

Date of mortgage: 09/24/91

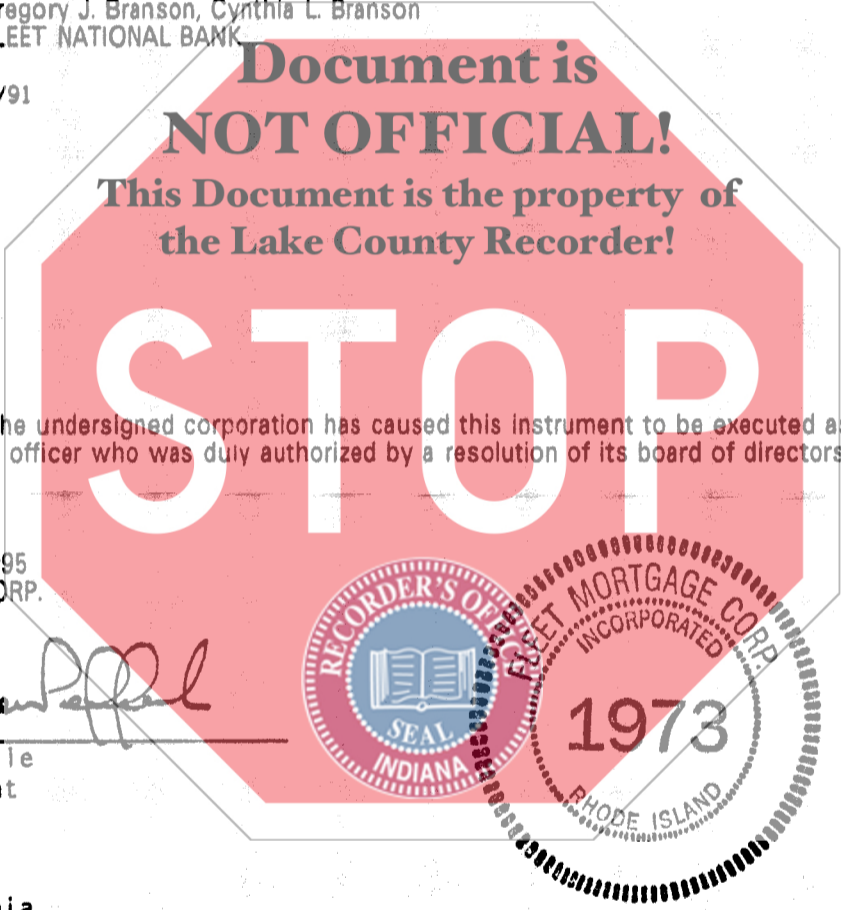

95010473

IN WITNESS WHEREOF, the undersigned corporation has caused this instrument to be executed as a sealed instrument by its proper officer who was duly authorized by a resolution of its board of directors.

Dated: February 1, 1995
FLEET MORTGAGE CORP.

By: Steven Pefferle
Steven Pefferle
Vice President

STATE OF INDIANA
LAKE COUNTY
FILED FOR RECORD
95 FEB 28 AM 8:52
MARKET VILLAGE
RECORDER

State of California
County of Santa Clara

On February 1, 1995, before me, the undersigned, a Notary Public for said County and State, personally appeared Steven Pefferle, personally known to me to be the person that executed the foregoing instrument, and acknowledged that he is Vice President of FLEET MORTGAGE CORP., and that he executed the foregoing instrument pursuant to a resolution of its board of directors and that such execution was done as the free act and deed of FLEET MORTGAGE CORP..

Valerie Orsolini

Notary: Valerie Orsolini
My Commission Expires January 23, 1998

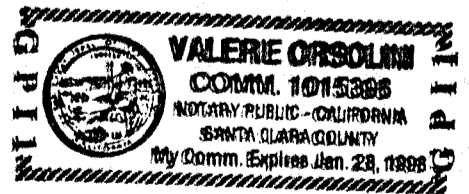

Prepared by: R. S. Stone
Peelle Management Corporation, P.O. Box 1710, Campbell, CA
Pool: 0312170
PMC#: 10752 FMC LN#: 0000645614 SOM LN#: 117107303 Investor #: 0645614
STCO: 13-089 IN Lake
FINAL A.O fleet317 90317 1 020395 GNM 364

20