

Warranty Deed

THIS INDENTURE WITNESSETH, That HARRY A. PROCIARLO

of PORTER County, in the State of INDIANA Convey and Warrant
to INDIANA TRUST CO., INC., A CORPORATION OF INDIANA, AS TRUSTEE
UNDER THE PROVISIONS OF A TRUST AGREEMENT DATED THE 23rd DAY OF
FEBRUARY, 1995, known as TRUST #1001, at PO BOX 824, CHESTERTON, IN
of PORTER County, in the State of INDIANA, for and in consideration of the sum of
TEN DOLLARS

the receipt whereof is hereby acknowledged, the following described Real Estate in LAKE County,
in the State of Indiana, to-wit:

Lot 101 in Elmwood Manor Subdivision of Griffith, as per
plat thereof, recorded December 15, 1960 in Plat Book 34, page 59,
in the Office of the Recorder of Lake County, Indiana, #26-238-37.
Commonly known as 1136/1138 N. Wood Av., Griffith, IN 46319.
Subject to all covenants, conditions, restrictions and easements
contained of record **the Lake County Recorder!**

Also subject to all building lines and zoning ordinances.
Also subject to any and all assessments or installments thereof
due or to become due after the date of this deed.
Also subject to highways and legal right of ways.
Also subject to ditches and drains, if any, and all rights therein.

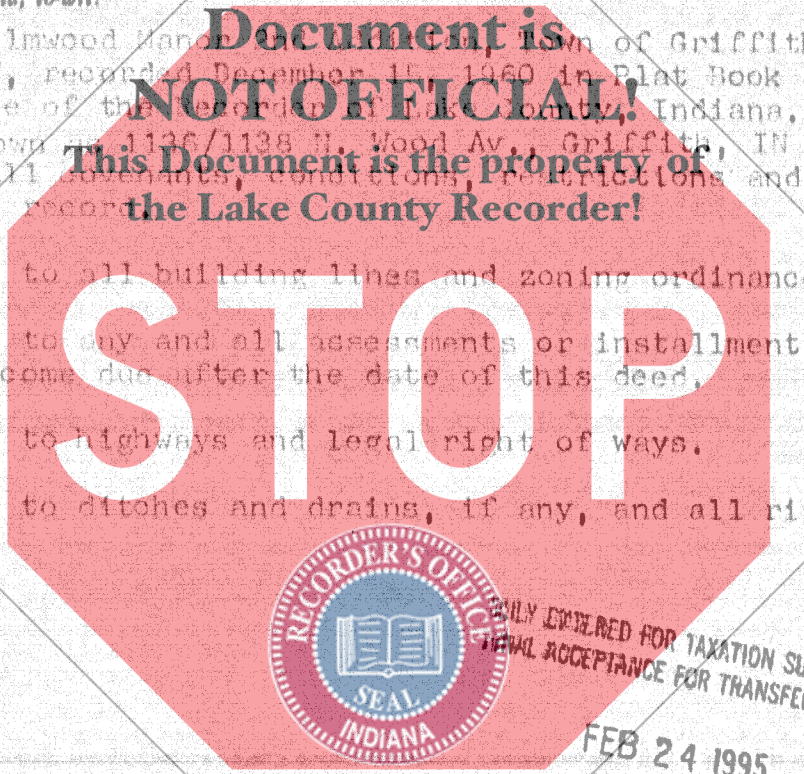

95010021

STATE OF INDIANA
LAKE COUNTY
RECORDER
95 FEB 24 PM 3:29

SAM ORLICH
AUDITOR LAKE COUNTY

Send tax statements to: Indiana Trust Co., Inc. Trust #1001
P.O. Box 824, Chesterton, IN 46304

7

001178

In Witness Whereof, The said

has hereunto set hand and seal, this _____ day of _____ 19____

Nancy A. Procario (Seal) _____ (Seal)

NANCY A. PROCARIO (Seal) _____ (Seal)

_____ (Seal) _____ (Seal)

STATE OF INDIANA,

COUNTY, as:

This Document is the property of the Lake County Recorder!

Before me, the undersigned, a Notary Public in and for said County, this 24th day of FEBRUARY 1995, came

NANCY A. PROCARIO

, and acknowledged the execution of the foregoing instrument.

Witness my hand and official seal.

(KATHERINE S. GRASKOVIC)

My Commission expires 10-10-98

Katherine S. Graskovic

Notary Public
RESIDENT OF PORTER COUNTY

This instrument prepared by: NANCY A. PROCARIO, Real Estate Independent Broker

