

190918 JAN H.O

Tax bills to: 4334 Dearborn Avenue, Hammond, Indiana 46327

STATE OF INDIANA) IN THE LAKE COUNTY SUPERIOR COURT
) SS: ROOM FIVE
COUNTY OF LAKE) HAMMOND, INDIANA

Filed in Open Court

IN THE MATTER OF THE SUPERVISED)
ADMINISTRATION OF THE ESTATE OF JAN 18 1995 CAUSE NO. 45D05-9308-ES-167
HELEN B. MACKOWIAK, Deceased.)

PERSONAL REPRESENTATIVE'S DEED

HELEN MARIE KOSARKO and DOLORES ECKELS, Co-Executrixes of the estate of HELEN B. MACKOWIAK, deceased, which estate is under the supervision of the Superior Court of Lake County, under Cause Number 45D05-9308-ES-167 in the Office of the Clerk of the Superior Court of Lake County, Indiana, pursuant to an order of the Superior Court of Lake County, Indiana, dated on the 18th day of January, 1995, for good and sufficient consideration,

conveys to:

JOHN J. LANGWINSKI and SUSAN A. LANGWINSKI, Husband and Wife, as Tenants by the Entireties,

the following described real estate in Lake County, State of Indiana, to-wit: real estate and improvements commonly known as 4334 Dearborn, Hammond, Indiana 46327, whose legal description is:

LOT 61 AND THE SOUTH 1/2 OF LOT 62, BLOCK 14, IN J. WM. ESCHENBURG'S STATE LINE ADDITION TO HAMMOND, AS PER PLAT THEREOF, RECORDED IN PLAT BOOK 2 PAGE 2, IN THE OFFICE OF THE RECORDER OF LAKE COUNTY, INDIANA. (TAX KEY # 33-68-18 & 19)

26-33 68-19+18

subject to all legal highways, rights-of-way and easements; subject to the taxes for the year 1994, payable in 1995, and all taxes subsequent thereto, and all matters which would be disclosed by an accurate survey or inspection of the premises.

IN WITNESS WHEREOF, the said HELEN MARIE KOSARKO and DOLORES

MARGARET E. N. CLEVELAND
LAKE COUNTY RECORDER
95004610

STATE OF INDIANA
LAKE COUNTY
FILED FOR RECORD
95 JAN 25 AM 10:14

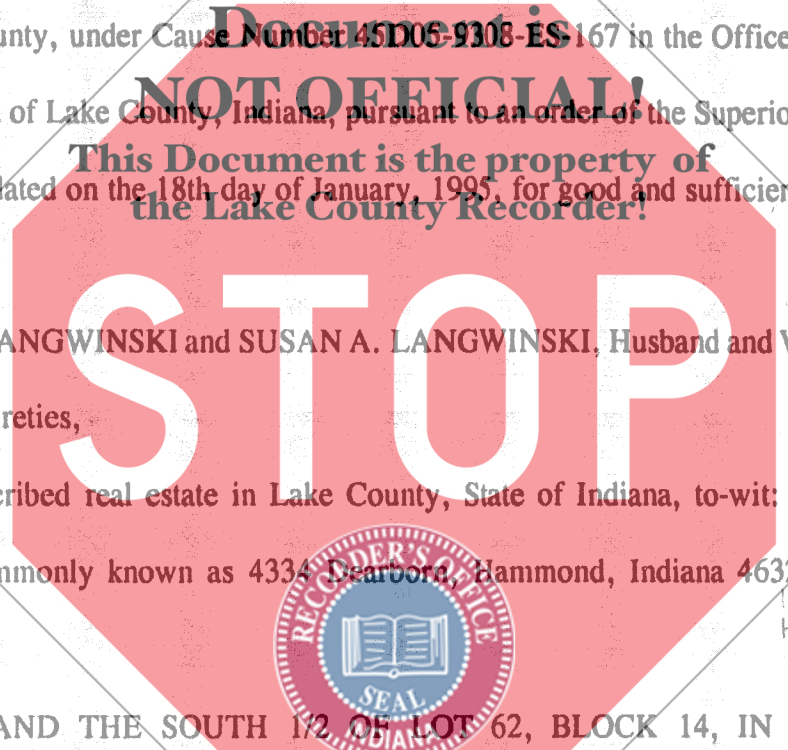

Document is NOT OFFICIAL!
This Document is the property of the Lake County Recorder!

TRULY FILED FOR TAXATION SUBJECT TO FINAL ACCEPTANCE FOR TRANSFER.

JAN 25 1995

JAM ORLICH
RECORDER OF LAKE COUNTY

001075

Handwritten signature/initials

