

Mail tax bills to:  
7260 Pierce Court  
Merrillville, IN 46410

Key No. 15-433-18

# WARRANTY DEED

THIS INDENTURE WITNESSETH, That **TOM G. PARKIS AND LANA PARKIS,**  
husband and wife

("Grantor") of LAKE County in the State of INDIANA  
CONVEYS AND WARRANTS TO **THOMAS W. MESTROVICH**

of LAKE County in the State of INDIANA  
in consideration of One Dollar and other valuable consideration, the receipt and sufficiency of which are hereby acknowledged, the following described real estate in LAKE County, in the State of Indiana:

Lot 205, Turkey Creek South, Unit No. 5, as per plat thereof, recorded in Plat Book 39, page 49, in the office of the Recorder of Lake County, Indiana.

Subject to the following:

1. Real estate taxes, beginning with the installment due and payable in May 1995, and taxes for all subsequent years, not yet due and payable.
2. Easements, covenants, and restrictions contained in prior instruments of record; all building and zoning laws, ordinances, legal drains, right-of-way, and other matters which would be disclosed by an accurate survey of the premises.
3. Liens and encumbrances, if any, created by the acts of the herein grantor.

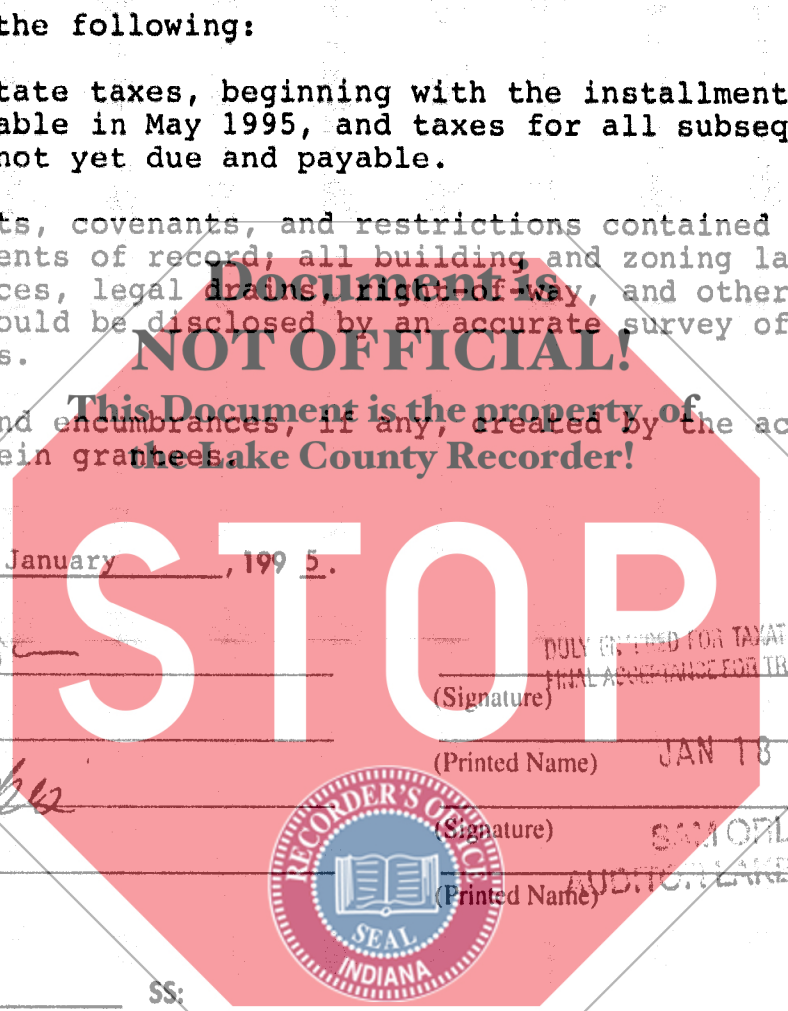

AMASA G. COLBY  
CHIEF DEP. RECORDER

95JAN03356

STATE OF INDIANA  
LAKE COUNTY  
FILED FOR RECORDER  
95 JAN 18 AM 9:34

Dated this 13th day of January, 1995.

*[Signature]*  
(Signature)  
**TOM G. PARKIS**  
(Printed Name)

*[Signature]*  
(Signature)  
**LANA PARKIS**  
(Printed Name)

*[Signature]*  
(Signature)  
**SAM OELICH**  
(Printed Name)  
AUDITOR, LAKE COUNTY

STATE OF INDIANA  
COUNTY OF LAKE SS:

Before me, the undersigned, a Notary Public in and for said County and State, this 13th day of January, 1995, personally appeared: **TOM G. PARKIS AND LANA PARKIS, husband and wife** and acknowledged the execution of the foregoing deed. In witness whereof, I have hereunto subscribed my name and affixed my official seal.

My commission expires: 1-21-95 Signature *[Signature]*  
Resident of Porter County Printed Barbara J. Hall, Notary Public

STATE OF \_\_\_\_\_  
COUNTY OF \_\_\_\_\_ SS:

Before me, the undersigned, a Notary Public in and for said County and State, this \_\_\_\_\_ day of \_\_\_\_\_, 199\_\_\_\_, personally appeared: \_\_\_\_\_ and acknowledged the execution of the foregoing deed. In witness whereof, I have hereunto subscribed my name and affixed my official seal.

My commission expires: \_\_\_\_\_ Signature \_\_\_\_\_  
Resident of \_\_\_\_\_ County Printed \_\_\_\_\_, Notary Public

This instrument prepared by **ERVIN C. CARSTENSEN, 503 Main St., Hobart, IN 46342** Attorney at Law  
Attorney Identification No. 3141-45  
MAIL TO: 7260 Pierce Court, Merrillville, IN 46410

000741

*[Handwritten initials]*