

FA 13889A

ENVIRONMENTAL DISCLOSURE DOCUMENT FOR
TRANSFER OF REAL PROPERTY

For Use by County
Recorder's Office
County _____
Date _____
Doc. No. _____
Vol. _____
Page _____
Rec'd by: _____

The following information is
provided under IC 13-7-22, the
Responsible Property Transfer
Law.

94082480

I. PROPERTY IDENTIFICATION

A. Address of property: 4605-7 BARING
Street

EAST CHICAGO NORTH
City or Town Township

Permanent Real Estate Index No.: 392690-22

B. Legal Description: 727154
Index #

Section 29 Township 37 Range _____

Enter or attach complete legal description in this area:

N 1/2 LOT 14 BL 3 ALL LOT 15 BL 3

LIABILITY DISCLOSURE

Transferors and transferees of real property are advised
that their ownership or other control of such property
may render them liable for environmental cleanup costs
whether or not they caused or contributed to the presence
of environmental problems in association with the
property.

C. Property Characteristics:

Lot Size 37.6 x 139.5 Acreage .12

Check all types of improvement and uses that pertain to
the property:

- Apartment building (6 units or less)
- Commercial apartment (over 6 units)
- Store, office, commercial building
- Industrial building
- Farm, with buildings
- Other (specify)

180
69

Return to:
First American Title Insurance Company

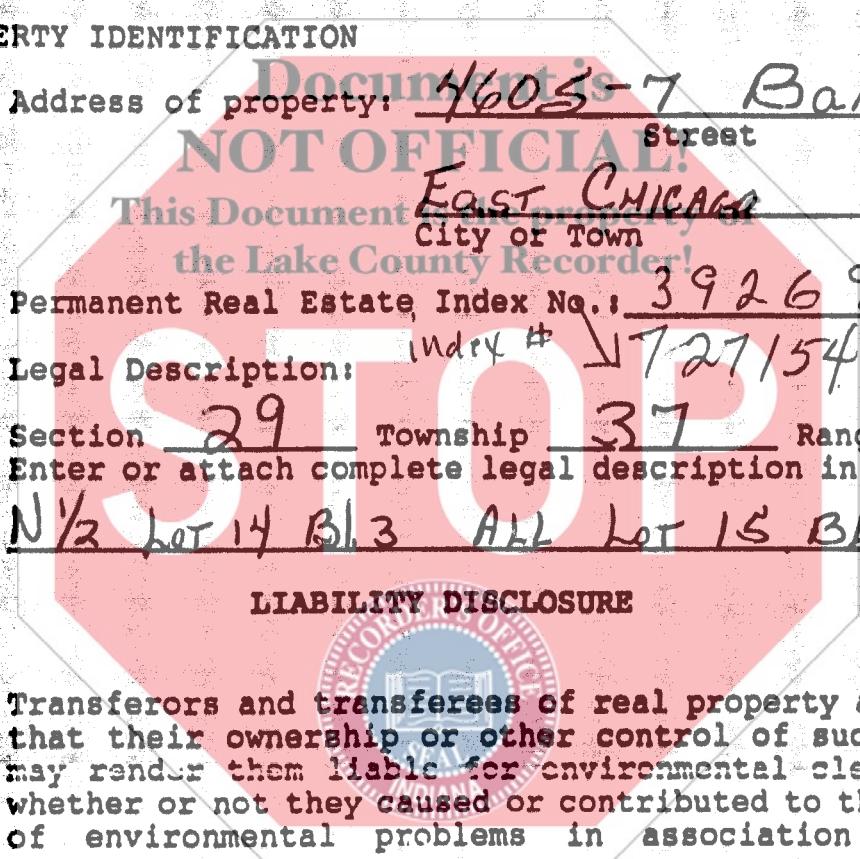

STATE OF INDIANA
LAKE COUNTY
FILED FOR RECORD

94 DEC - 7 AM 10:16

II. NATURE OF TRANSFER

YES NO

- A. (1) Is there a transfer by deed or other instrument of conveyance? YES NO
- (2) Is there a transfer by assignment of over 25% of beneficial interest of a land trust? YES NO
- (3) A lease exceeding a term of 40 years? YES NO
- (4) A mortgage or collateral assignment of beneficial interest? YES NO
- (5) A contract for the sale of property? YES NO

B. (1) Identify Transferor:

Alandrea Gardner 1539 Oak Street

Name and Current Address of Transferor

GARY IN.

Name and Address of Trustee if this is a transfer of beneficial interest of a land trust. Trust No.

(2) Identify person who has completed this form on behalf of the Transferor and who has knowledge of the information contained in this form:

Alandrea Gardner Co owner 883-2222
Name, Position (if any), and address Telephone No.

C. Identify Transferee:

JOHN GOMEZ
Name and Current Address of Transferee

III. ENVIRONMENTAL INFORMATION

A. Regulatory Information During Current Ownership

1. Has the transferor ever conducted operations on the property which involved the generation, manufacture, processing, transportation, treatment, storage, or handling of "hazardous waste", as defined by IC 13-7-1?

This question does not apply to consumer goods stored or handled by a retailer in the same form and approximate amount, concentration, and manner as they are sold to consumers, unless the retailer has engaged in any commercial mixing (other than paint mixing or tinting of consumer sized containers), finishing, refinishing, servicing, or cleaning operations on the property.

Yes
 No

2. Has the transferor ever conducted operations on the property which involved the processing, storage, or handling of petroleum, other than that which was associated directly with the transferor's vehicle usage?

Yes
 No

3. Has the transferor ever conducted operations on the property which involved the generation, transportation, storage, treatment, or disposal of "hazardous waste", as defined in IC 13-7-1?

Yes
 No

4. Are there any of the following specific units (operating or closed) at the property that are used or were used by the transferor to manage hazardous wastes, hazardous substances, or petroleum?

	YES	NO
Landfill	<input type="checkbox"/>	<input checked="" type="checkbox"/>
Surface Impoundment	<input type="checkbox"/>	<input checked="" type="checkbox"/>
Land Treatment	<input type="checkbox"/>	<input checked="" type="checkbox"/>
Waste Pile	<input type="checkbox"/>	<input checked="" type="checkbox"/>
Incinerator	<input type="checkbox"/>	<input checked="" type="checkbox"/>
Storage Tank (Above Ground)	<input type="checkbox"/>	<input checked="" type="checkbox"/>
Storage Tank (Underground)	<input type="checkbox"/>	<input checked="" type="checkbox"/>
Container Storage Area	<input type="checkbox"/>	<input checked="" type="checkbox"/>
Injection Wells	<input type="checkbox"/>	<input checked="" type="checkbox"/>
Wastewater Treatment Units	<input type="checkbox"/>	<input checked="" type="checkbox"/>
Septic Tanks	<input type="checkbox"/>	<input checked="" type="checkbox"/>
Transfer Stations	<input type="checkbox"/>	<input checked="" type="checkbox"/>
Waste Recycling Operations	<input type="checkbox"/>	<input checked="" type="checkbox"/>
Waste Treatment Detoxification	<input type="checkbox"/>	<input checked="" type="checkbox"/>
Other Land Disposal Area	<input type="checkbox"/>	<input checked="" type="checkbox"/>

If there are "YES" answers to any of the above items and the transfer of property that requires the filing of this

document is other than a mortgage or collateral assignment of beneficial interest, you must attach to the copies of this document that you file with the county recorder and the department of environmental management a site plan that identifies the location of each unit.

5. Has the transferor ever held any of the following in regard to this real property?

(A) Permits for discharges of wastewater to waters of Indiana. Yes
No

(B) Permits for emissions to the atmosphere. Yes
No

(C) Permits for any waste storage, waste treatment, or waste disposal operation. Yes
No

6. Has the transferor ever discharged any wastewater (other than sewage) to a publicly owned treatment works?

Yes
No

7. Has the transferor been required to take any of the following actions relative to this property?

(A) Filed an emergency and hazardous chemical inventory form pursuant to the federal Emergency Planning and Community Right-to-Know Act of 1986 (42 U.S.C. 11022). Yes
No

(B) Filed a toxic chemical release form pursuant to the federal Emergency Planning and Community Right-to-Know Act of 1986 (42 U.S.C. 11023). Yes
No

8. Has the transferor or any facility on the property or the property been the subject of any of the following state or federal governmental actions?

(A) Written notification regarding known, suspected, or alleged contamination on or emanating from the property. Yes
No

(B) Filing an environmental enforcement case with a court or the solid waste management board for Yes
No

which a final order or consent decree was entered.

(C) If the answer to question (B) was Yes Yes, then indicate whether or not No the final order or decree is still in effect for this property.

9. Environmental Releases During Transferor's Ownership.

(A) Has any situation occurred at this site which resulted in a reportable "release" of any hazardous substances or petroleum as required under state or federal laws?

Yes
No

(B) Have any hazardous substances or petroleum which were released come into direct contact with the ground at this site?

Yes
No

If the answers to questions (A) and (B) are Yes, have any of the following actions or events been associated with a release on the property?

Use of cleanup contractor to remove or treat materials including soils, pavement, or other surficial materials?

Assignment of in-house maintenance staff to remove or treat materials including soils, pavement, or other surficial materials?

Sampling and analysis of soils?

Temporary or more long term monitoring of groundwater at or near the site?

Impaired usage of an on-site or nearby water well because of offensive characteristics of the water?

Coping with fumes from subsurface storm drains or inside basements?

Signs of substance leaching out of the

ground along the base of slopes or at other low points on or immediately adjacent to the site?

10. Is the facility currently operating under a variance granted by the commissioner of the Indiana department of environmental management?

Yes
No

11. Is there any explanation needed for clarification of any of the above answers or responses?

no

B. Site Information Under Other Ownership or Operation

1. Provide the following information about the previous owner or about any entity or person to whom the transferor leased the property or with whom the transferor contracted for the management of the property:

Name: _____

Type of business or property usage _____

2. If the transferor has knowledge, indicate whether the following existed under prior ownerships, leaseholds granted by the transferor, or other contracts for management or use of the property:

	YES	NO
Landfill	_____	<input checked="" type="checkbox"/>
Surface Impoundment	_____	<input checked="" type="checkbox"/>
Land Treatment	_____	<input checked="" type="checkbox"/>
Waste Pile	_____	<input checked="" type="checkbox"/>
Incinerator	_____	<input checked="" type="checkbox"/>
Storage Tank (Above Ground)	_____	<input checked="" type="checkbox"/>
Storage Tank (Underground)	_____	<input checked="" type="checkbox"/>
Container Storage Area	_____	<input checked="" type="checkbox"/>
Injection Wells	_____	<input checked="" type="checkbox"/>
Wastewater Treatment Units	_____	<input checked="" type="checkbox"/>
Septic Tanks	_____	<input checked="" type="checkbox"/>

Transfer Stations
Waste Recycling Operations
Waste Treatment Detoxification
Other Land Disposal Area

____ ✓
____ ✓
____ ✓
____ ✓

IV. CERTIFICATION

A. Based on my inquiry of those persons directly responsible for gathering the information, I certify that the information submitted is, to the best of my knowledge and belief, true and accurate.

alandress Gardner
TRANSFEROR (or on behalf of
Transferor)
ALANDRESS GARDNER

B. This form was delivered to me with all elements completed on NOVEMBER 23, 19 94, of

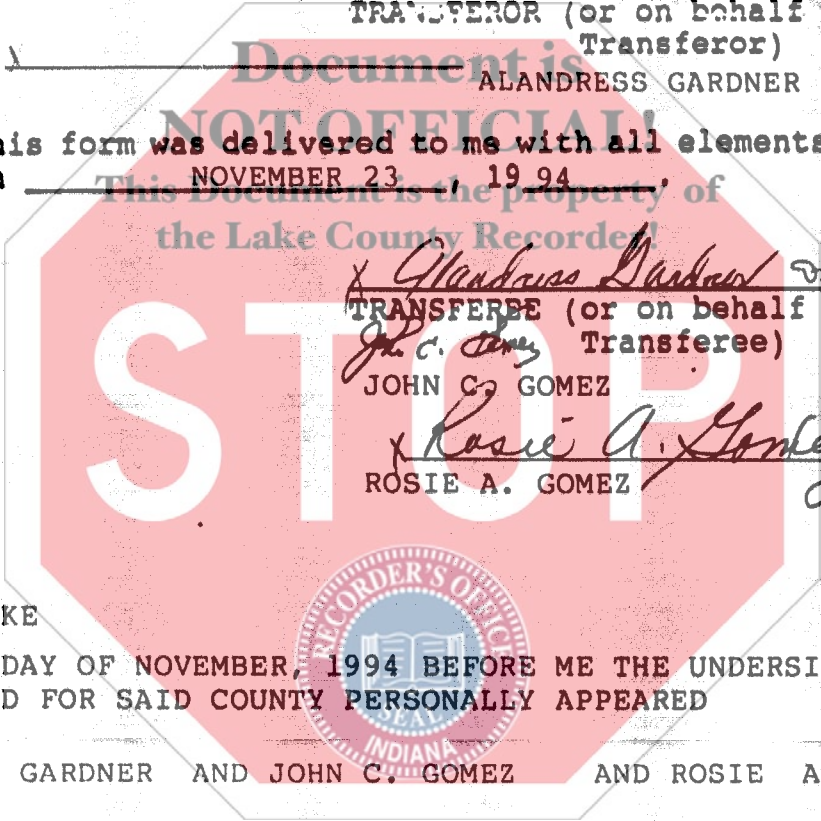

John C. Gomez
TRANSFEEE (or on behalf of
Transferee)
JOHN C. GOMEZ
Rosie A. Gomez
ROSIE A. GOMEZ

mcm.10\5524

STATE OF IN
COUNTY OF LAKE

ON THE 23rd DAY OF NOVEMBER, 1994 BEFORE ME THE UNDERSIGNED A NOTARY PUBLIC IN AND FOR SAID COUNTY PERSONALLY APPEARED

ALANDRESS GARDNER AND JOHN C. GOMEZ AND ROSIE A. GOMEZ

AND ACKNOWLEDGED THE EXECUTION OF THE FOREGOING INSTRUMENT.

WITNESS MY HAND AND OFFICIAL SEAL.

MY COMMISSION EXPIRES: 1-12-96
LAEK COUNTY RESIDENT

Elizabeth J. Webster
ELIZABETH J. WEBSTER

7
THIS INSTRUMENT PREPARED BY ALANDRESS GARDNER.