

2478216
L

Tap Bills to
304 Ellendale Pkwy Cr Pt. In
46307

Chicago Title Insurance Company

Warranty Deed

This Indenture Witnesseth, That THOMAS F. RAY, of Lake County, and State of Indiana

Conveys and Warrants

TO: THERESA L. MINAS, of Lake County, in the State of Indiana for the sum of Ten Dollars (\$10.00) and Other Good and Valuable Consideration, the following described Real Estate in Lake County, in the State of Indiana, to-wit:

Lot 2, Ellendale Second City Park Addition to the City of Crown Point, as shown in Plat Book 21, page 43, in Lake County, Indiana.

Commonly known as 304 Ellendale Parkway, Crown Point, Indiana 46307

Subject to covenants and restrictions, easements for streets and utilities, and building lines, as contained in plat of subdivision and as contained in all other documents of record; and taxes for 1994

Key # 9-28-2

In Witness Whereof, the said THOMAS F. RAY has hereunto set his hand and seal this 30 day of November, 1994.

Thomas F Ray
THOMAS F. RAY

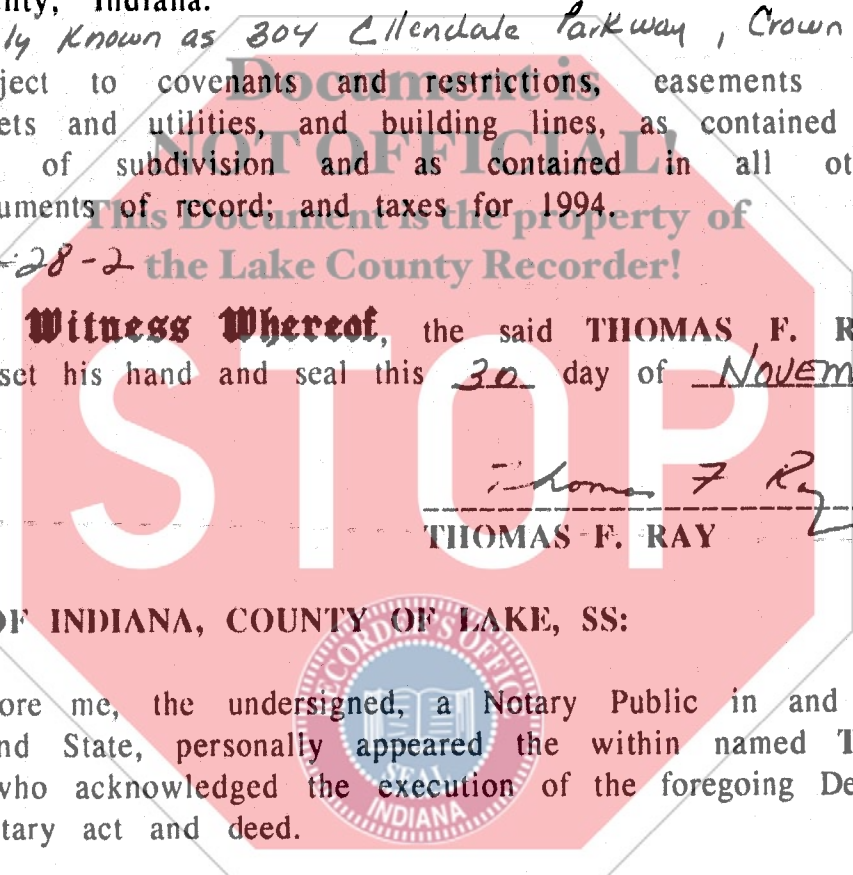

STATE OF INDIANA, COUNTY OF LAKE, SS:

Before me, the undersigned, a Notary Public in and for County and State, personally appeared the within named THOMAS F. RAY who acknowledged the execution of the foregoing Deed to his voluntary act and deed.

Witness, my hand and Official Seal this 30 day of November, 1994.

Star Lugar
Notary Public (signature)

STAR Lugar
Notary Public (typed or printed)

My Commission Expires: JUNE 25, 1995
County of Residence of Notary Public: Lake

This instrument prepared by John R. Sorbello attorney at law.
FINAL ACCEPTANCE FOR TRANSFER

H 8 25

DEC 2 1994

Anna M. Antow
AUDITOR LAKE COUNTY

000150

700
ct

94081791

94 DEC -5 AM 10:18

STATE OF INDIANA
LAKE COUNTY
FILED FOR RECORD

SAMUEL BRUCH
RECORDER