

CP474552L ①

THIS FORM HAS BEEN PREPARED FOR USE IN THE STATE OF INDIANA BY LAWYERS ONLY. THE SELECTION OF A FORM OF INSTRUMENT, FILLING IN BLANK SPACES, STRIKING OUT PROVISIONS, AND INSERTION OF SPECIAL CLAUSES, MAY CONSTITUTE THE PRACTICE OF LAW WHICH SHOULD ONLY BE DONE BY A LAWYER.

Mail tax bills to:
4815 Linden
Hammond, IN 46327

Tax Key No. 26-36-131-1

WARRANTY DEED

94031429

This indenture witnesseth that GEORGE A. ROGGE

of Lake County in the State of Indiana

Convey and warrant to FLOYD J. CLEMENTS and IVY M. CLEMENTS,
Husband and Wife

of Lake County in the State of Indiana

for and in consideration of Ten (\$10) Dollars and for other good and valuable consideration the receipt whereof is hereby acknowledged, the following Real Estate in Lake County in the State of Indiana, to wit:

Lot 117 and the north half of Lot 118, Block 2, Stafford and Trankle's South Central Calumet addition to Hammond, as shown in Plat Book 10, Page 301, in Lake County, Indiana and more commonly known as 4815 Linden, Hammond, IN 46327.

SUBJECT TO:

1. Taxes and assessments;
2. Zoning and building ordinances;
3. Ditches and drains, if any;
4. Covenants, easements and restrictions of record; and,
5. Highways and public right-of-ways.

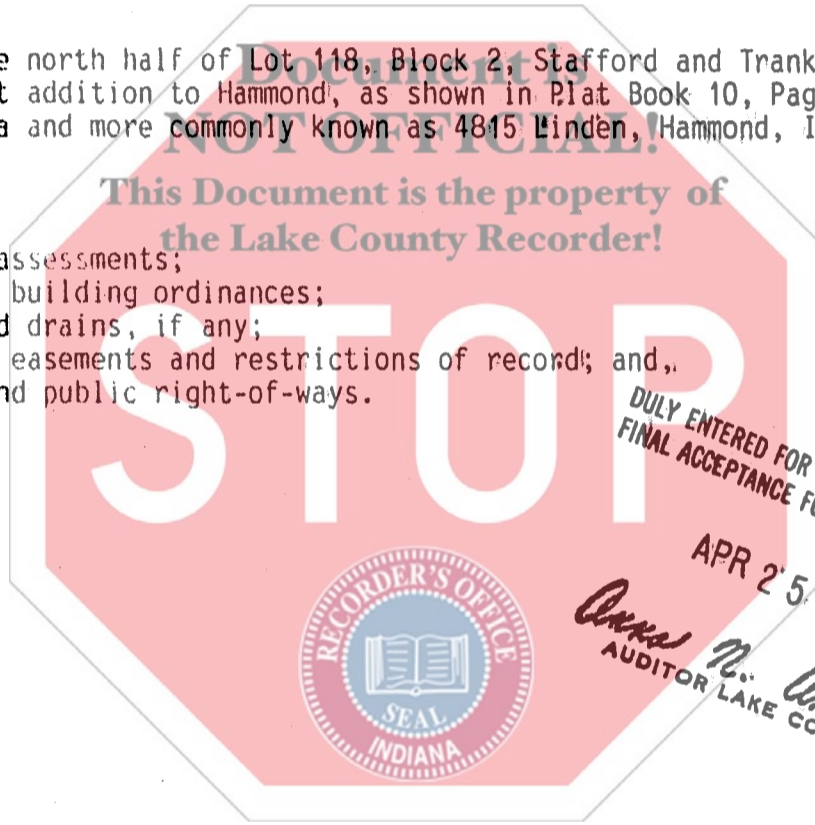

DULY ENTERED FOR TAXATION SUBJECT TO FINAL ACCEPTANCE FOR TRANSFER.

APR 25 1994

Anna N. Antos
AUDITOR LAKE COUNTY

State of Indiana, Lake County, ss:
Before me, the undersigned, a Notary Public in and for said County and State, this 13th day of April 1994 personally appeared:

George A. Rogge

Dated this 13th Day of April 1994
G.A. Rogge
GEORGE A. ROGGE

And acknowledged the execution of the foregoing deed. In witness whereof, I have hereunto subscribed my name and affixed my official seal. My commission expires January 7, 1998

Stacey Eisenhutt
Stacey Eisenhutt, Notary Public

Resident of Lake County.

This instrument prepared by Timothy S. Schafer, 5875 Broadway, Merrillville, IN 46410 Attorney at Law

01519

MAIL TO:

APR 26 1 33 PM '94
SAL RECORDER

Chicago Title Insurance Company

700 ct