

CP47449710

THIS FORM HAS BEEN PREPARED FOR USE IN THE STATE OF INDIANA BY LAWYERS ONLY. THE SELECTION OF A FORM OF INSTRUMENT, FILLING IN BLANK SPACES, STRIKING OUT PROVISIONS, AND INSERTION OF SPECIAL CLAUSES, MAY CONSTITUTE THE PRACTICE OF LAW WHICH SHOULD ONLY BE DONE BY A LAWYER.

Mail tax bills to:

8351 Lakewood Avenue
Gary, IN 46403

WARRANTY DEED

Tax Key No. 25-45-459-14

94031427

This indenture witnesseth that SUSAN L. CHANDLER

of Lake County in the State of Indiana

Convey and warrant to LEONARD B. GREGORY and JANICE M. GREGORY,
Husband and Wife

of Lake County in the State of Indiana
for and in consideration of Ten (\$10) Dollars and for other good and valuable consideration the receipt whereof is hereby acknowledged, the following Real Estate in Lake County in the State of Indiana, to wit:

Lot 14, Lakewood Hills Second Edition, in the City of Gary, as shown in Plat Book 32, Page 30, in Lake County, Indiana and more commonly known as 8351 Lakewood, Gary, Indiana 46403.

SUBJECT TO:

1. Taxes and assessments;
2. Zoning and building ordinances;
3. Ditches and drains, if any;
4. Covenants, easements and restrictions of record; and,
5. Highways and public right-of-ways.

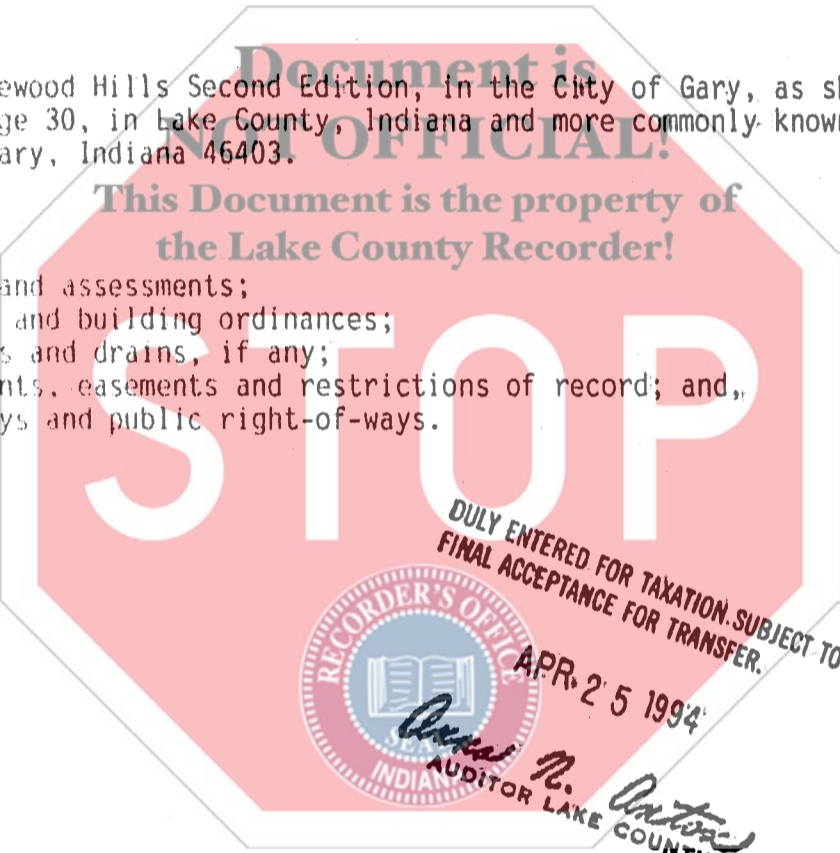

APR 26 1 33 PM '94
S.A. RECORDER JH

DULY ENTERED FOR TAXATION. SUBJECT TO FINAL ACCEPTANCE FOR TRANSFER.
APR 25 1994
RECORDER'S OFFICE
INDIANA
AUDITOR M. [Signature]
LAKE COUNTY

State of Indiana, Lake County, ss:

Dated this 19th Day of April 1994

Before me, the undersigned, a Notary Public in and for said County and State, this 19th day of April 1994 personally appeared:

Susan L. Chandler

Susan L. Chandler
SUSAN L. CHANDLER

And acknowledged the execution of the foregoing deed. In witness whereof, I have hereunto subscribed my name and affixed my official seal. My commission expires January 7, 1998

Stacey Eisenhutt
Notary Public
Resident of Lake County

01518 700 Ct

This instrument prepared by Timothy S. Schafer, 5875 Broadway, Merrillville, IN 46410 Attorney at Law

Chicago Title Insurance Company

STATE OF INDIANA