

MAIL TAX BILLS TO:

TAX KEY NO: 27-490-2

Bank of Highland  
450 W. Lincoln Highway  
Schererville, IN 46375

**WARRANTY DEED**

94031422

This indenture witnesseth that **PHILIP E. KELLAR,**  
of Lake County in the State of Indiana

Conveys and warrants to **BENEVOLENT AND PROTECTIVE  
ORDER OF ELKS NO. 981,**  
of Lake County in the State of Indiana

for and in consideration of Ten Dollars (\$10.00) and other good and valuable consideration the receipt whereof is hereby acknowledged, the following Real Estate in Lake County in the State of Indiana, to wit:

Chicago Title Insurance Company

STATE OF INDIANA, S. NO. 1  
LAKE COUNTY  
FILED FOR RECORD

APR 26 1 33 PM '94  
S.A. RECORDER

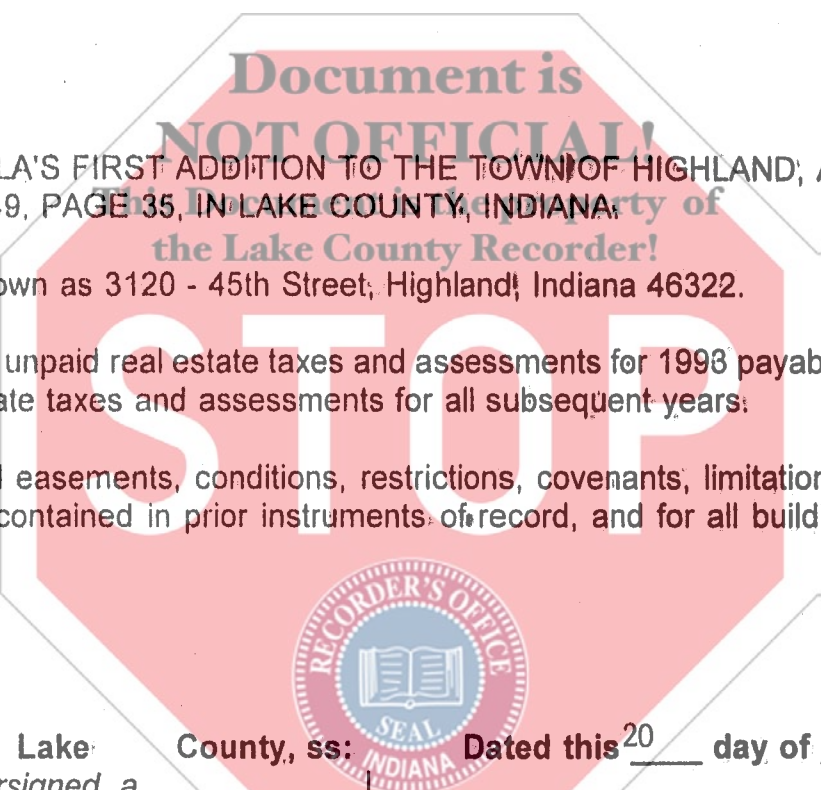

LOT 2, ANGELA'S FIRST ADDITION TO THE TOWN OF HIGHLAND, AS SHOWN IN PLAT BOOK 49, PAGE 35, IN LAKE COUNTY, INDIANA.  
Commonly known as 3120 - 45th Street, Highland, Indiana 46322.

Subject To: all unpaid real estate taxes and assessments for 1993 payable in 1994, and for all real estate taxes and assessments for all subsequent years.

Subject To: all easements, conditions, restrictions, covenants, limitations and building setback lines contained in prior instruments of record, and for all building and zoning ordinances.

State of Indiana, Lake County, ss: Dated this 20 day of APRIL, 1994

Before me, the undersigned, a Notary Public in and for said County and State, this 20th day of APRIL, 1994 personally appeared:

Philip E. Kellar  
PHILIP E. KELLAR

PHILIP E. KELLAR;

DULY ENTERED FOR TAXATION SUBJECT TO FINAL ACCEPTANCE FOR TRANSFER.

And acknowledged the execution of the foregoing deed. In witness whereof, I have hereunto subscribed my name and affixed my official seal.

APR 25 1994  
Anna N. Antos  
AUDITOR-LAKE COUNTY

My commission expires: APRIL 18 1995

Arlyne K. Royal  
Notary Public  
ARLYNE K. ROYAL

Resident of LAKE County

This instrument prepared by: **Rhett L. Tauber, Esq./Anderson, Tauber & Woodward, P.C.**  
8935 Broadway, Merrillville, IN 46410  
Phone: 219/769-1892

01515 700  
OK