

LTC# 56078

THIS FORM HAS BEEN PREPARED FOR USE WITHIN THE STATE OF INDIANA. THE SELECTION OF A FORM OF INSTRUMENT, FILLING IN BLANK SPACES, STRIKING OUT PROVISIONS, AND INSERTION OF SPECIAL CLAUSES, MAY CONSTITUTE THE PRACTICE OF LAW AND SHOULD ONLY BE DONE BY A LAWYER.

Mail tax bills to: 94029114

Tax Key No.: 47-360-1 U#25

NBD MORTGAGE COMPANY  
900 TOWER DRIVE  
TRON, NJ 48098

# WARRANTY DEED

LAWYERS TITLE INS. CORP.  
ONE PROFESSIONAL CENTER  
SUITE 215  
CROWN POINT, IN 46307

This indenture witnesseth that WILLIAM GREER

of LAKE County in the State of INDIANA

Convey and warrant to MICHAEL J. GEE and CASSANDRA GEE, Husband and Wife,

of LAKE County in the State of INDIANA

for and in consideration of TEN DOLLARS (\$10.00) and other good and valuable consideration, the receipt whereof is hereby acknowledged, the following Real Estate in County in the State of Indiana, to wit:

Lots 1 & 2, Block 3, W. G. Wright's Third Addition to the City of Gary, as shown in Plat Book 10, page 34, Lake County, Indiana.

SUBJECT TO all liens, taxes, easements, restrictions and covenants of record.

MORE COMMONLY KNOWN AS 2400 Wilson Street, Gary, IN. 46404

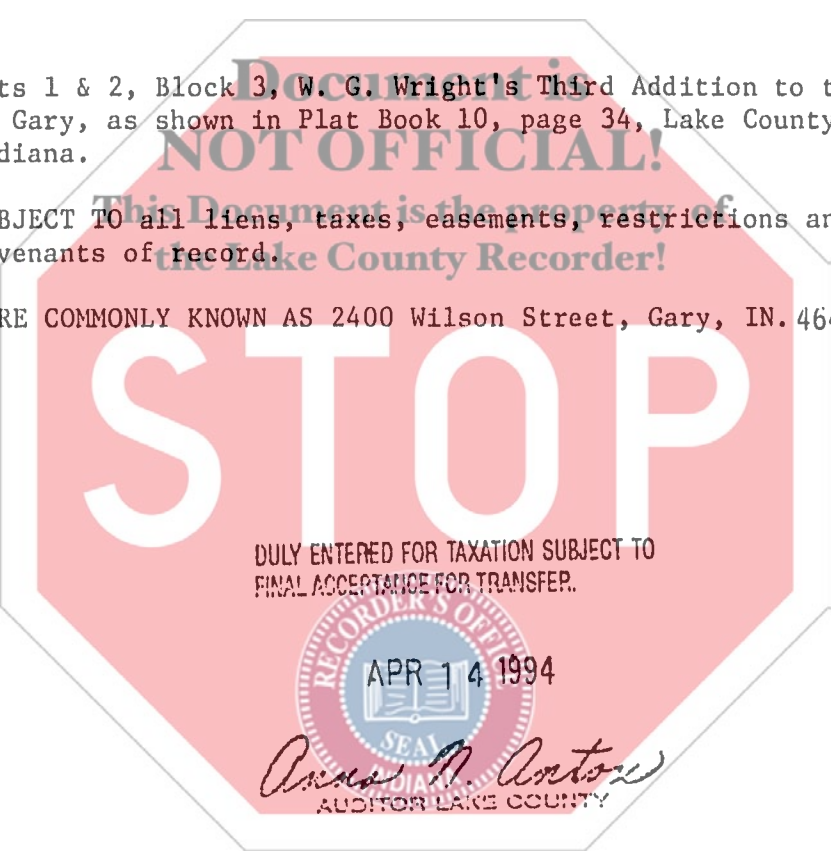

APR 18 12 10 PM '94  
SARAH J. HANCOCK  
RECORDER

STATE OF INDIANA  
FILED IN REC'D

State of Indiana, LAKE County, ss:

Dated this 12th Day of APRIL 1994

Before me, the undersigned, a Notary Public in and for said County and State, this 12th day of APRIL 19 94 personally appeared:

William Greer  
WILLIAM GREER

WILLIAM GREER

And acknowledged the execution of the foregoing deed. In witness whereof, I have heretofore subscribed my name and affixed my official seal. My commission expires 06/03 1994

Michelle L. Valentine  
MICHELLE L. VALENTINE Notary Public

Resident of LAKE County, INDIANA

00900

This instrument prepared by VLADIMIR GASTEVOICH Attorney at Law