



TICOR TITLE INSURANCE

Return To: TICOR TITLE

94028298

HIGHLAND OFFICE

WARRANTY

This Indenture Witnesseth

That GOLDEN OAK BUILDERS, INC. AN INDIANA CORPORATION

of LAKE County, and State of INDIANA

CONVEY AND WARRANT

To WAYNE T. STONE AND SHIRLEY A. STONE, HUSBAND AND WIFE

of COOK County, in the State of ILLINOIS

for the sum of Ten Dollars and other valuable consideration Dollars

the following described REAL ESTATE in LAKE County, in the State of Indiana, to-wit:

LOT 16 AND THE SOUTH 50 FEET OF LOT 17 IN LARIMER PARK SUBDIVISION TO THE TOWN OF ST. JOHN, AS PER PLAT THEREOF, RECORDED IN PLAT BOOK 43 PAGE 1, IN THE OFFICE OF THE RECORDER OF LAKE COUNTY, INDIANA.

Unit No. 22 Key# 12-57-16-117

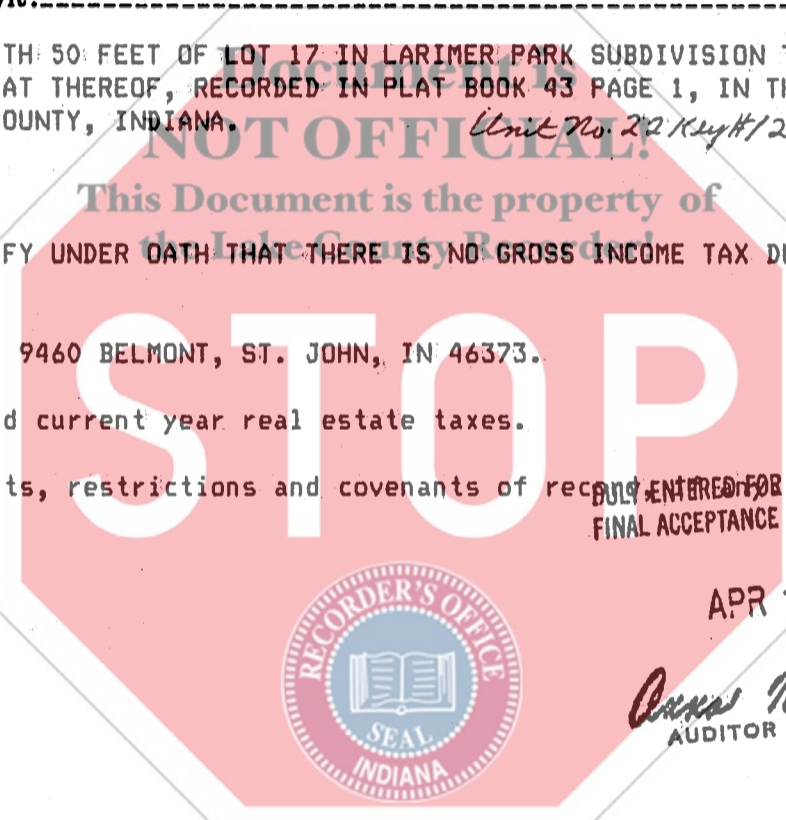

GRANTOR DOES CERTIFY UNDER OATH THAT THERE IS NO GROSS INCOME TAX DUE BY REASON OF THIS TRANSFER.

Commonly known as: 9460 BELMONT, ST. JOHN, IN 46373.

Subject to past and current year real estate taxes.

Subject to easements, restrictions and covenants of record, ENTERED FOR TAXATION SUBJECT TO FINAL ACCEPTANCE FOR TRANSFER.



APR 13 1994

Anna N. Antox
AUDITOR LAKE COUNTY

IN WITNESS WHEREOF, The said GOLDEN OAK BUILDERS, INC. AN INDIANA CORPORATION

BY CHARLES SCHAUFLELE, PRESIDENT AND TIMOTHY A. HILDEBRAND, VICE-PRESIDENT

Have hereunto set their Hands and seals this 8th day of April 19 94

GOLDEN OAK BUILDERS, INC. AN INDIANA CORPORATION

Charles Schaufele (SEAL) *Timothy A. Hildebrand* (SEAL)

CHARLES SCHAUFLELE, PRESIDENT (SEAL) TIMOTHY A. HILDEBRAND, VICE-PRESIDENT (SEAL)

(SEAL) (SEAL)

STATE OF INDIANA, LAKE County, ss:

Before me, the undersigned, a Notary Public in and for said County and State, personally appeared the within named CHARLES SCHAUFLELE, PRESIDENT AND TIMOTHY A. HILDEBRAND, VICE-PRESIDENT OF Golden Oak Builders, Inc., an Indiana Corporation who acknowledged the execution of the foregoing Deed to be their voluntary act and deed.

WITNESS, my hand and Seal this 8th day of April 19 94
October 17 94

My commission expires 19 94 LINDA S. WOOD Notary Public

County of Residence LAKE

Mail/Tax Statements to 9460 Belmont St., John, In 46373 00768

This instrument prepared by CHARLES SCHAUFLELE