

1164 Bigler
Gary 46404
71

94027748

00170900-6 1026/811 NOVEMBER 23, 1993 NASH 3-FHA
SHORT FORM OF DISCHARGE OF MORTGAGE FOR CORPORATIONS

KNOW ALL MEN BY THESE PRESENTS, That a certain indenture of mortgage, bearing date the 21st day of NOVEMBER 1963, made and executed by JOHNNIE W. NASH AND DORIS NASH of the First part, to GARY NATIONAL BANK of the Second part, and recorded in the office of the registrar of deeds for the county of LAKE, state of INDIANA in Liber 1486, page 516, Doc No. 530581 Registered Land Certificate No. THE SOUTH 21 FEET OF LOT 19, NAD THE NORTH 24 FEET OF LOT 20 IN BLK 11 HARTLEY L. REPOOGLE OF LOTS 21 TO 28, LAKE COUNTY, INDIANA.

STATE OF INDIANA, S.S.M.D.
LAKE COUNTY
FILED
RECORDED
APR 13 2 00 PM '94
STATE RECORDS DIVISION

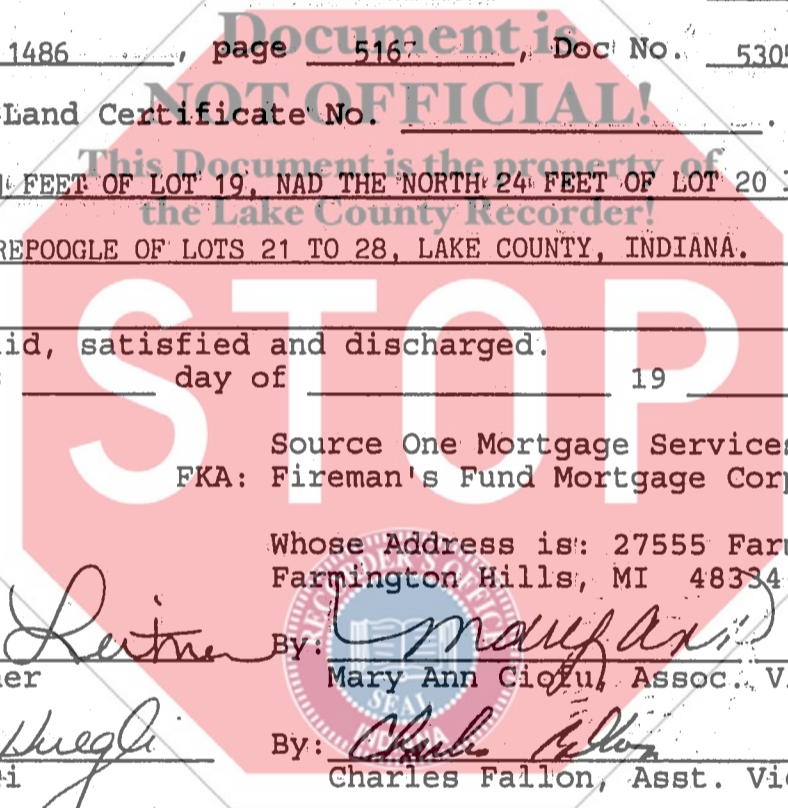

Is fully paid, satisfied and discharged.
Dated this _____ day of _____ 19____

Source One Mortgage Services Corporation
FKA: Fireman's Fund Mortgage Corporation

Whose Address is: 27555 Farmington Rd.
Farmington Hills, MI 48334-3357

Witnesses:

Julie Leitner
Julie Leitner

By: Mary Ann Ciofu
Mary Ann Ciofu, Assoc. Vice President

Kelly Hoegli
Kelly Hoegli

By: Charles Fallon
Charles Fallon, Asst. Vice President

State of Michigan
County of Oakland

On this _____ day of _____ 19____ before me appeared Mary Ann Ciofu and Charles Fallon to me personally known who, being by me duly sworn, did say that they are the Associate Vice President and Assistant Vice President respectively, of Source One Mortgage Services Corporation and that the seal affixed to said instrument is the corporate seal of said corporation, and that said instrument was signed and sealed on behalf of said corporation, by authority of its board of directors, and Mary Ann Ciofu and Charles Fallon acknowledged said instrument to be the free act and deed of said corporation.

My Commission Expires:
LOIS R. BERNARD
Notary Public, Oakland County, MI
My Commission Expires February 21, 1994

Lois R. Bernard
Notary Public, County,

WHEN RECORDED RETURN TO:
Source One Mortgage Services Corp.
P.O. Box 1800
Farmington Hills, MI 48333-9904
Attn: Payoff Department

DRAFTED BY:
Source One Mortgage Services Corp.
27555 Farmington Road
Farmington Hills, MI 48334-3357
Attn: Payoff Department

200