

THIS FORM HAS BEEN PREPARED FOR USE WITHIN THE STATE OF INDIANA. THE SELECTION OF A FORM OF INSTRUMENT, FILLING IN BLANK SPACES, STRIKING OUT PROVISIONS, AND INSERTION OF SPECIAL CLAUSES, MAY CONSTITUTE THE PRACTICE OF LAW AND SHOULD ONLY BE DONE BY A LAWYER.

Mail tax bills to:

6400 W. Spencer Hwy.
Crown Point, IN 46307

Tax Key No.: 20-13-117-18

WARRANTY DEED

94027563

This indenture witnesseth that

CAROLL D. GREEN AND STELLA M. GREEN, HUSBAND AND WIFE

of Lake County in the State of Indiana

Convey and warrant to

CHARLES D. GREEN AND PAMELA/VERGIN-GREEN, HUSBAND AND WIFE
J.

of Lake County in the State of Indiana

for and in consideration of Ten Dollars and other valuable consideration the receipt whereof is hereby acknowledged, the following Real Estate in Lake County in the State of Indiana, to wit:

SEE ATTACHED LEGAL

Commonly known as: Schererville, Indiana

Subject to past and current year real estate taxes.

Subject to easements, restrictions and covenants of record, if any.

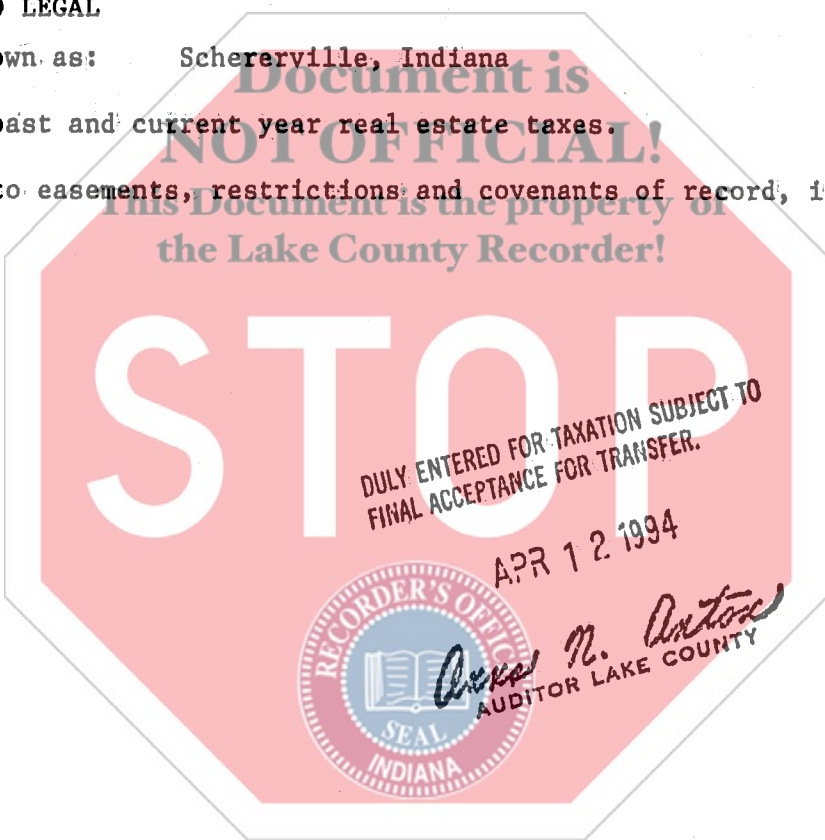

SAMUEL L. BLOCH
RECORDER

APR 13 10 08 AM '94

STATE OF INDIANA/S.S.N.D.
LAKE COUNTY
FILED FOR RECORD

County

State of Indiana, Lake County, ss:

Dated this 6th Day of April 1994

Before me, the undersigned, a Notary Public in and for said County and State, this 6th day of April 1994 personally appeared:

CAROLL D. GREEN AND STELLA M. GREEN,
HUSBAND AND WIFE

Carroll D. Green
CAROLL D. GREEN

Stella M. Green
STELLA M. GREEN

And acknowledged the execution of the foregoing deed. In witness whereof, I have hereunto subscribed my name and affixed my official seal. My commission expires January 26 1995

Linda J. McBride
Linda J. McBride Notary Public

Resident of Lake County.

00655

This instrument prepared by Atty. Thomas K. Hoffman Attorney at Law

PARCEL 1: Part of the Northeast Quarter of the Northeast Quarter of Section 23, Township 35 North, Range 9 West of the 2nd Principal Meridian, more particularly described as follows: Beginning at the Northeast corner of said Section 23; thence South 00 degrees 02 minutes 38 seconds East, along the East line of said Section 23, a distance of 288.98 feet to a point on the Northerly right of way line of U.S. Highway 30 (Lincoln Highway); thence North 71 degrees 28 minutes 00 seconds West along said Northerly right of way line a distance of 155.18 feet; thence North 00 degrees 00 minutes 41 seconds East, a distance of 238.41 feet to a point on the North line of said Section 23; thence North 89 degrees 30 minutes 55 seconds East along said North line, a distance of 146.87 feet to the point of beginning, all in the Town of Schererville, Lake County, Indiana, the West 20 feet of which lies within Greens 1st Addition to the Town of Schererville, as shown in Plat Book 74 page 6, in Lake County, Indiana.

