

94026171

Please return the recorded deed to Attorney Karen Pulliam Willis  
1345 Wallace Street Gary, Indiana 46404

*Just Mailing Address:*  
2453 Delaware St  
Gary IN 46407

46-141-35

ADMINISTRATOR'S DEED

EMMA EZELL, personal representative of the estate of  
MILLIE DICKERSON, deceased, which estate is an unsuper-  
vised administration of the Superior Court of Lake County, under  
Cause No. 45D02-9310-EU-188 in the Office of the Clerk of  
the Superior Court of Lake County, Indiana, for good and  
sufficient consideration, conveys to J. C. DICKERSON, the  
following described real estate in Lake County, State of  
Indiana, to-wit:

Lot 35, Block 13 as marked and laid down  
on the recorded plat of Chicago-Tolleston  
Land and Investment Company's Oak Park  
Addition to Tolleston, in the City of  
Gary, Lake County, Indiana commonly known  
as 2453 Delaware Street, Gary, Indiana

Subject to all easements, rights of way, and taxes

IN WITNESS WHEREOF, the said EMMA EZELL, as personal  
representative of the estate of MILLIE DICKERSON, has  
hereunto set her hand and seal this 2<sup>nd</sup> day of April, 1994.

*Emma Ezell*  
EMMA EZELL, Personal Representative  
of the Estate of MILLIE DICKERSON

STATE OF INDIANA , COUNTY OF LAKE )SS:

Before me, the undersigned, a notary public, in and for  
said County and State, personally appeared EMMA EZELL, as  
personal representative of the estate of MILLIE DICKERSON, and  
acknowledged the execution of said deed to be her voluntary  
act and deed for the uses and purposes expressed therein.

Witness my hand and seal this 2<sup>nd</sup> day of April, 1994.

My Commission Expires:

9-10-97

*Karen Pulliam Willis*  
Notary Public  
Lake County Resident

700

00406

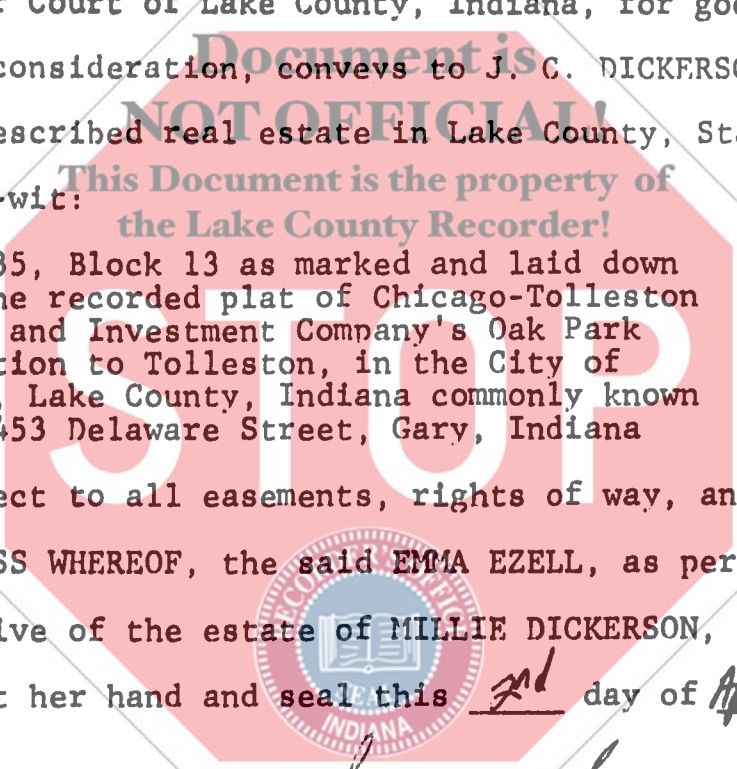

STATE OF INDIANA  
FILED IN CLERK'S OFFICE  
APR 7 11 10 AM '94  
DULY ENTERED FOR TAXATION SUBJECT TO  
FINAL ACCEPTANCE FOR TRANSFER.  
APR 7 1994  
AUDITOR LAKE COUNTY