

60445947 184512

CP/GM/TICOR

TICOR: HIGHLAND OFFICE

THIS FORM HAS BEEN APPROVED BY THE INDIANA STATE BAR ASSOCIATION FOR USE BY LAWYERS ONLY. THE SELECTION OF A FORM OF INSTRUMENT, FILLING IN BLANK SPACES, STRIKING OUT PROVISIONS AND INSERTION OF SPECIAL CLAUSES, CONSTITUTES THE PRACTICE OF LAW AND MAY ONLY BE DONE BY A LAWYER.

Mail tax bills to:

Tax Key No.:

# WARRANTY DEED

4610 PINE AVENUE  
HAMMOND, IN 46323

94025536

This indenture witnesseth that

FRANK M. MATSON

of LAKE County in the State of INDIANA

Convey and warrant to

NANCY E. KINSELLA

of LAKE County in the State of INDIANA  
for and in consideration of Ten Dollars and other good and valuable consideration  
the receipt whereof is hereby acknowledged, the following Real Estate in LAKE County  
in the State of Indiana, to wit:

LOT 18 AND THE NORTH 1/2 OF LOT 17 IN BLOCK 8 IN TOWLE AND AVERY'S ADDITION TO THE CITY OF HAMMOND, AS PER PLAT THEREOF, RECORDED IN PLAT BOOK 1 PAGE 104, IN THE OFFICE OF THE RECORDER OF LAKE COUNTY, INDIANA.  
Commonly known as: 4610 PINE AVENUE, HAMMOND, IN 46323.

Subject to past and current year real estate taxes.  
Subject to easements, restrictions and covenants of record, if any.

26-36-215-14

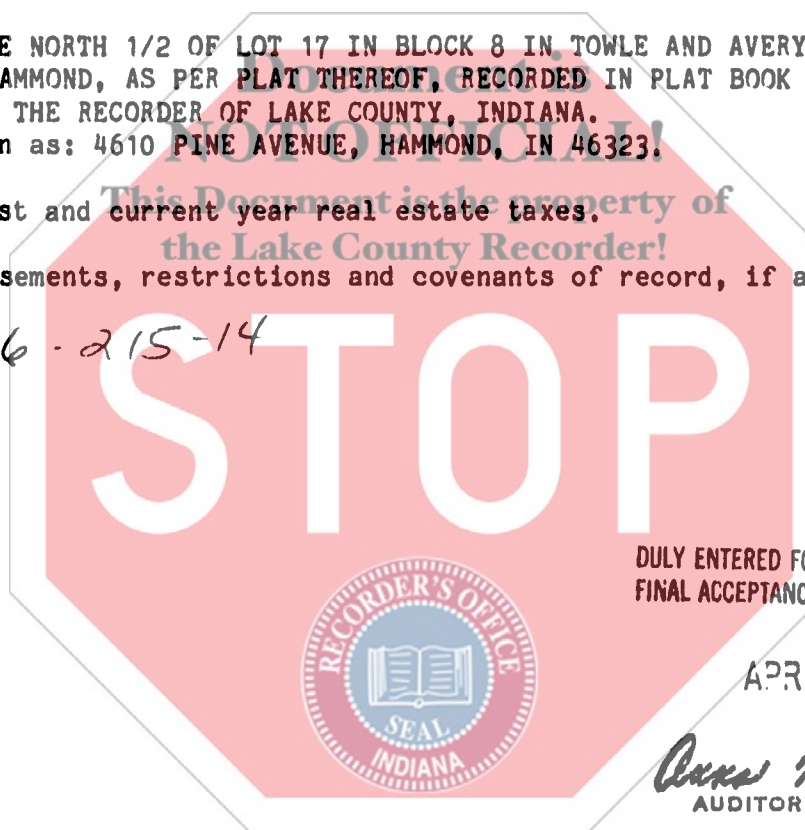

DULY ENTERED FOR TAXATION SUBJECT TO FINAL ACCEPTANCE FOR TRANSFER.

APR 5 1994

*Anna M. Anton*  
AUDITOR LAKE COUNTY

SA  
RECORDER  
CH  
Apr 6 10 16 AM '94

STATE OF INDIANA  
LAKE COUNTY  
FILED FOR RECORDS

State of Indiana, Lake County, ss:  
Before me, the undersigned, a Notary Public in and for said County and State, this 28th day of June 1989  
personally appeared:  
FRANK M. MATSON

Dated this 28th Day of June 1989

*Frank M. Matson*  
FRANK M. MATSON

And acknowledged the execution of the foregoing deed. In witness whereof, I have hereunto subscribed my name and affixed my official seal. My commission expires October 17 1990

*Linda S. Wood*  
LINDA S. WOOD Notary Public

Resident of \_\_\_\_\_ County.

This instrument prepared by JOHN D. BRECLAW Attorney at Law  
735 West Glen Park Avenue  
Griffith, Indiana 46319

158

700  
the

MAIL TO: