

FA-12146

MAIL TAX BILLS TO:
6353 Marshall Court
Merrillville, IN 46410

TAX KEY NO.: 15-525

ADDRESS OF REAL ESTATE:
6353 Marshall Court,
Merrillville, IN 46410

Return to:
First American Title Insurance Company
5285 Commerce Drive
Crown Point, IN 46307

94025418

WARRANTY DEED

This Indenture Witnesseth That:

GERALD ZIMNY and GAIL ZIMNY, Husband and Wife

Conveys and Warrants to:

BERTHA E. HILGER and LILLIAN M. ROBERTSON, as
Joint Tenants with rights of survivorship.

for and in consideration of Ten Dollars (\$10.00), and other good and valuable consideration, the receipt whereof is hereby acknowledged, the following Real Estate in Lake County, Indiana, to-wit:

Lot 25 in Innsbrook, Unit No. 6, in the Town of Merrillville, as per Plat thereof, recorded in Plat Book 56, Page 18, in the Office of the Recorder of Lake County, Indiana.

This conveyance is subject to State, County and City taxes for 1993 payable in 1994 and all subsequent years; all special assessments levied prior to and payable subsequent to the date hereof, building and zoning ordinances now or hereafter in effect, easements, restriction of record and questions of survey. Grantor expressly limits said Warranties only against the acts of the Grantor and all persons claiming by, through or under the Grantor.

Dated this 4th day April, 1994.

Gerald Zimny
GERALD ZIMNY
Gail Zimny
GAIL ZIMNY

DULY ENTERED FOR TAXATION SUBJECT TO
FINAL ACCEPTANCE FOR TRANSFER

APR 6 1994

STATE OF INDIANA

COUNTY OF

Wendell W. Goad II
SS
AUDITOR LAKE COUNTY

Before me, the undersigned, a Notary Public in and for said County and State, this 4th day of April, 1994, personally appeared GERALD ZIMNY and GAIL ZIMNY, Husband and Wife, and acknowledged the execution of the foregoing Deed. In Witness Whereof, I have hereunto subscribed my name and affixed my official seal.

Wendell W. Goad II
Wendell W. Goad II, Notary Public
Resident of Lake County, Indiana

My Commission Expires:
12/18/96

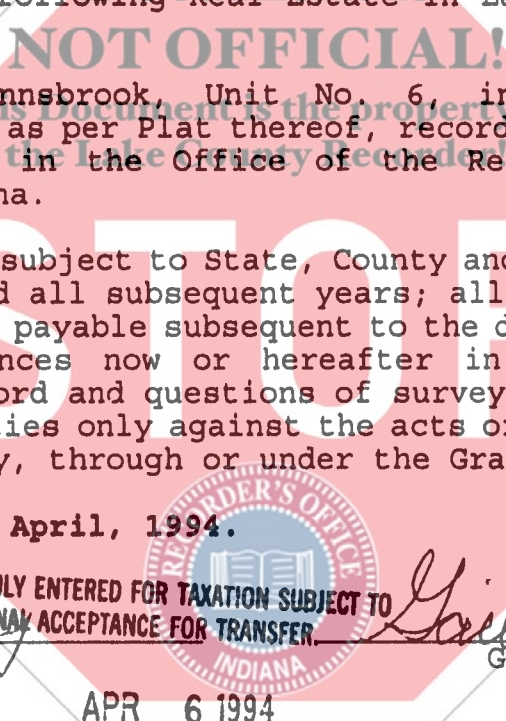

STATE OF INDIANA
LAKE COUNTY
RECORDER
9 36 AM '94

00210 700
Ja