

94025254

ORDINANCE NUMBER 835

TOWN OF ST. JOHN  
11030 W. CINDY STREET  
ST. JOHN, INDIANA 46373

**AN ORDINANCE ANNEXING CERTAIN PROPERTY TO  
THE TOWN OF ST. JOHN, COUNTY OF LAKE,  
STATE OF INDIANA**

WHEREAS, the Board of Trustees of the Town of St. John, Indiana, is charged with the promotion of the orderly growth and development of the Town of St. John and its environs; and,

WHEREAS, the Board of Trustees of the Town of St. John, Indiana, has studied the feasibility of annexing certain contiguous unincorporated lands; and,

WHEREAS, it is considered in the best interests of the Town of St. John that the said territory be annexed to and become part of the Town of St. John.

NOW, THEREFORE, BE IT ORDAINED BY THE BOARD OF TRUSTEES OF THE TOWN OF ST. JOHN, COUNTY OF LAKE, STATE OF INDIANA:

**SECTION ONE:** That the following-described contiguous territory be, and the same is hereby, annexed to and shall become a part of the Town of St. John, Lake County, State of Indiana, to-wit: **APR 5 1994**

**SEE LEGAL DESCRIPTION ATTACHED HERETO  
AND MARKED AS EXHIBIT "A"**

commonly located in the general area west of Lake Central High School and north of Ventura Estates Subdivision, St. John, Lake County, Indiana.

**SECTION TWO:** That the said annexation shall have no special terms or conditions, *and shall be zoned R-1.*

**SECTION THREE:** That the Clerk-Treasurer of the Town of St. John, Indiana, is hereby directed to publish this ordinance immediately after the passage thereof for two consecutive weeks in accordance with Acts 1980, P. L. 212, as amended, I. C. 5-3-1-1, et. seq.

**SECTION FOUR:** That the Clerk-Treasurer of the Town of St. John, Indiana, is further directed to deliver a certified copy of this ordinance to the St. John Township Assessor and the Auditor of Lake County, Indiana, sixty (60) days following the last date of

STATE OF INDIANA  
LAKE COUNTY  
FILED FOR RECORD  
APR 5 12 24 PM '94  
S. J. RECORDER

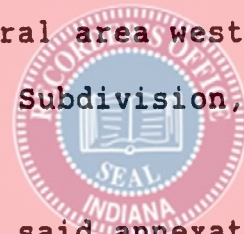
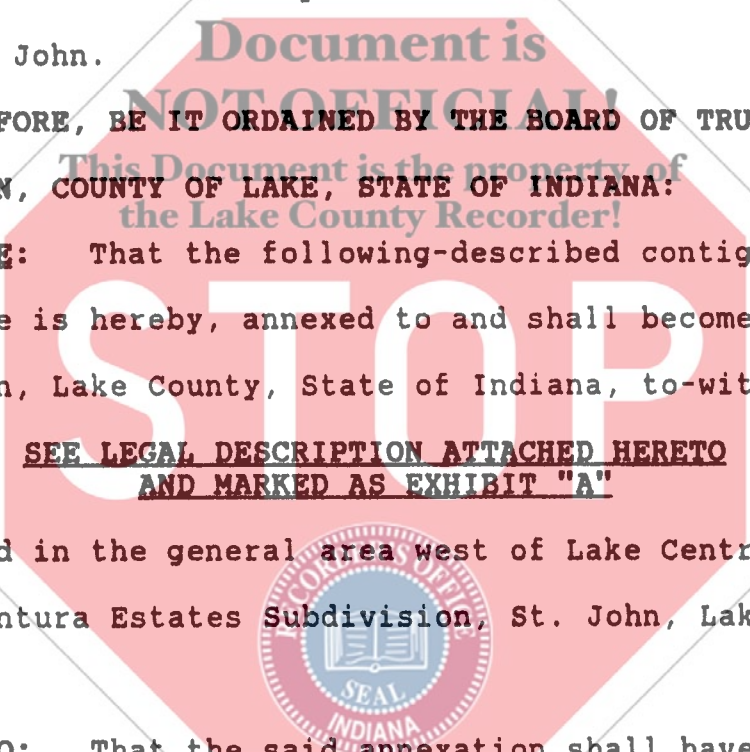

*Anna N. Antox*  
AUDITOR LAKE COUNTY

10214 *102*

publication referred to in Section Three hereof.

**SECTION FIVE:** That this ordinance shall be in full force and effect from and after the date of its adoption, its passage and publication pursuant to law.

PASSED AND ADOPTED BY THE BOARD OF TRUSTEES of the Town of St. John, Indiana, this 4 day of April, 1990.

*William B. Bell*  
\_\_\_\_\_  
PRESIDENT

*David Harner*  
\_\_\_\_\_

ATTEST:

*Judith A. Combs*  
\_\_\_\_\_  
Clerk-Treasurer

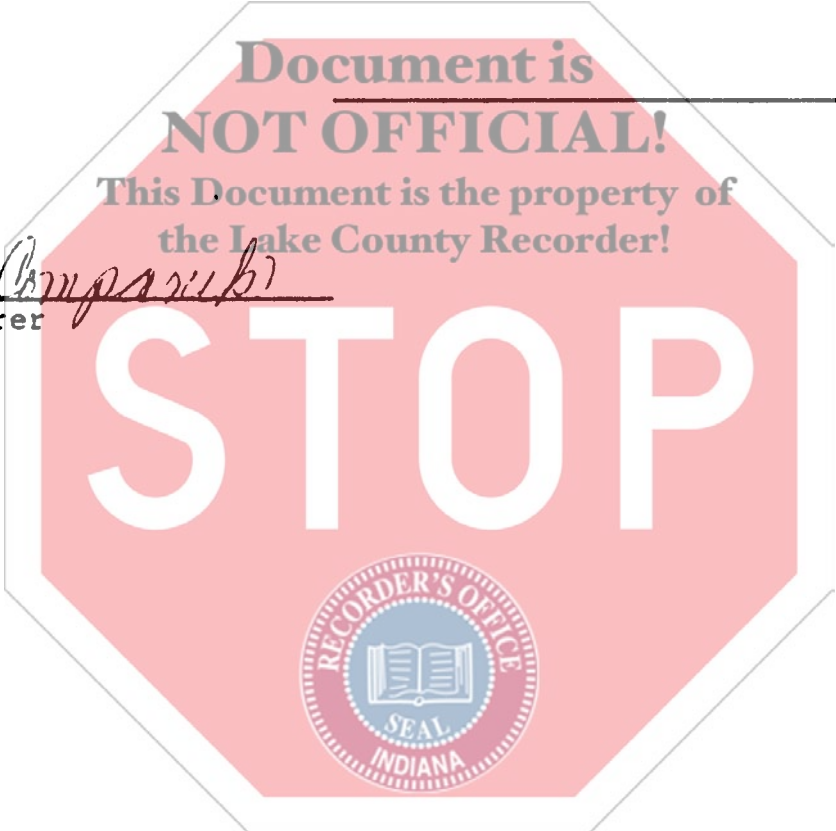

LEGAL DESCRIPTION

173,871.87  
37,883

EXHIBIT "A"

Part of the Southeast Quarter of Section 20, Township 35 North, Range 9 West of the 2nd P.M., described as follows, to-wit: Beginning at the Northwest corner of the Southeast Quarter of Section 20, Township 35 North, Range 9 West of the 2nd P.M.; thence North 89 degrees 56 minutes East along the North line of said Southeast Quarter, 1662.88 feet; thence South no degrees 21 minutes East 2183.449 feet; thence West 1662.88 feet, more or less, to the West line of said Southeast Quarter; and thence North, no degrees 32 minutes West along said West line 2183.449 feet, more or less, to the place of beginning, in Lake County, Indiana, excepting therefrom, a parcel of land in the East half of the Southeast Quarter lying West of the East 60 acres of the said Southeast Quarter of Section 20, Township 35 North, Range 9 West of the 2nd P.M., more particularly described as follows: Beginning at a point on the West line of the East 60 acres, said point being 451.44 feet North of the South line of said Section; thence North on said West line of the East 60 acres a distance of 1512.85 feet to a point 664.80 feet South of the North line of the Southeast Quarter of said Section; thence West a distance of 338.94 feet to the West line of the East half of the Southeast Quarter, said point being 666.04 feet South of the Northwest corner of the said East half of the Southeast Quarter; thence South on the West line of the said East half of the Southeast Quarter a distance of 1508.07 feet to a point 451.44 feet North of the South line of said Section; thence East a distance of 339.35 feet to the place of beginning.

And also excepting a strip of land described as follows: Beginning at a point on the West line of the East half of the Southeast Quarter of Section 20, 1,071.44 feet North of the South line of said section; thence North on said West line a distance of 100.00 feet; thence West on a line 1,171.44 feet North of and parallel to the South line of said Section a distance of 130.00 feet; thence North on a line 130.00 feet West of and parallel to the said West line of said East half of the Southeast quarter a distance of 787.77 feet to a point 666.04 feet South of the North line of the Southeast Quarter of said section; thence West on a line 666.04 feet South of and parallel to the last said North line, a distance of 430.50 feet; thence North on a line 560.50 feet West of and parallel to the said West line of the East half of the Southeast Quarter a distance of 666.04 feet to the North line of the Southeast quarter; thence West on the said North line a distance of 100.00 feet; thence South on a line 660.50 feet, West of and parallel to the said West line of the East half of the Southeast Quarter a distance of 766.04 feet; thence East on a line 766.04 feet South of and parallel to the North line of the Southeast Quarter a distance of 430.50 feet; thence South on a line 230.00 feet West of and parallel to the said West line of the East half of the Southeast Quarter a distance of 787.58 feet to a point 1071.44 feet North of the said South line; thence East a distance of 230.00 feet to the place of beginning, in Lake County, Indiana.