

THIS FORM HAS BEEN PREPARED FOR USE IN THE STATE OF INDIANA BY LAWYERS ONLY. THE SELECTION OF A FORM OF INSTRUMENT, FILLING IN BLANK SPACES, STRIKING OUT PROVISIONS, AND INSERTION OF SPECIAL CLAUSES, MAY CONSTITUTE THE PRACTICE OF LAW WHICH SHOULD ONLY BE DONE BY A LAWYER.

Mail tax bills to: 94025073  
7920 NORTH DRIVE  
HIGHLAND, IN. 46322

Tax Key No.: 27-350-26

# WARRANTY DEED

This indenture witnesseth that

DENNIS R. ROEHRICH ALSO KNOWN AS  
DENNIS RICHARD ROEHRICH

of RAMSEY

County in the State of MINNESOTA

Convey and warrant to

PAUL J. SYTNIK AND SUSAN L. SYTNIK,  
HUSBAND AND WIFE

of LAKE

County in the State of INDIANA

for and in consideration of TEN DOLLARS (\$10.00) AND OTHER GOOD AND VALUABLE CONSIDERATION the receipt whereof is hereby acknowledged, the following Real Estate in LAKE County in the State of Indiana, to wit:

LOT 26 IN HOMESTEAD GARDENS MASTER ADDITION, BLOCK 22, TO THE TOWN OF HIGHLAND, AS PER PLAT THEREOF, RECORDED IN PLAT BOOK 37 PAGE 9, IN THE OFFICE OF THE RECORDER OF LAKE COUNTY, INDIANA.

COMMONLY KNOWN AS: 7920 NORTH DRIVE  
HIGHLAND, IN. 46322

SUBJECT TO PAST AND CURRENT YEAR REAL ESTATE TAXES.

SUBJECT TO EASEMENTS, RESTRICTIONS AND COVENANTS OF RECORD, IF ANY.

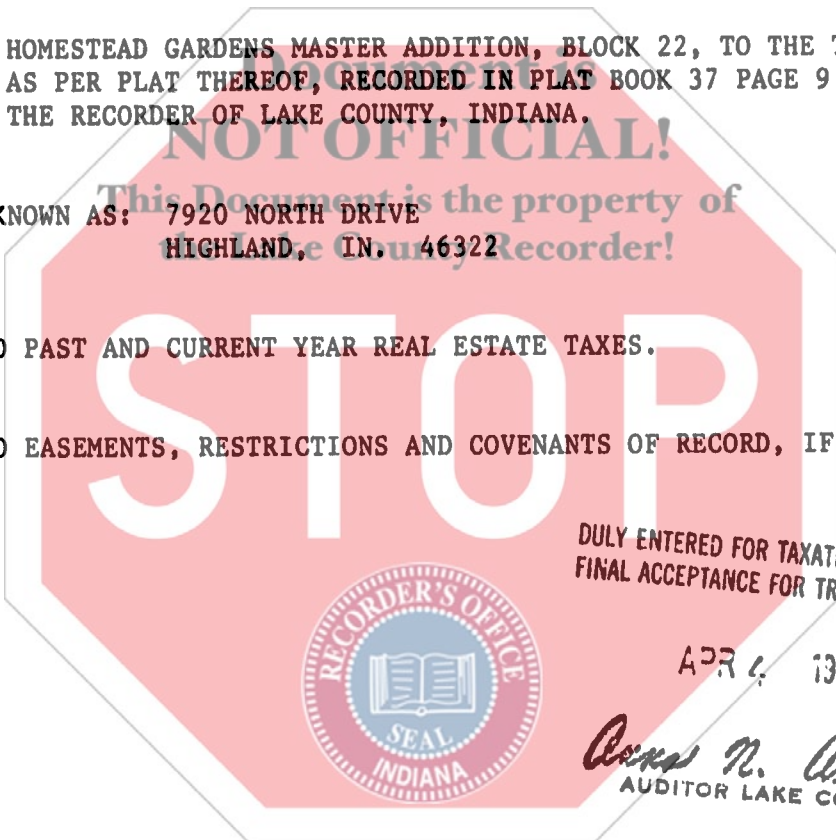

DULY ENTERED FOR TAXATION SUBJECT TO FINAL ACCEPTANCE FOR TRANSFER.

APR 4 1994

*Anna N. Antos*  
AUDITOR LAKE COUNTY

~~State of Indiana~~ <sup>Minnesota</sup> Ramsey County, ss:  
Before me, the undersigned, a Notary Public in and for said County and State, this 25<sup>th</sup> day of MARCH 19 94 personally appeared:

DENNIS R. ROEHRICH, A/K/A  
DENNIS RICHARD ROEHRICH

Dated this 25<sup>th</sup> Day of MARCH 1994

*Dennis R. Roehrich*  
DENNIS R. ROEHRICH, A/K/A  
DENNIS RICHARD ROEHRICH

And acknowledged the execution of the foregoing deed. In witness whereof, I have hereunto subscribed my name and affixed my official seal. My commission expires 9-22-98 19

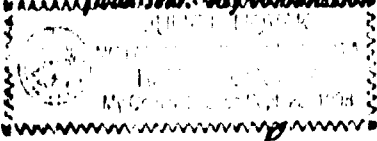

*Julie K. Novel*  
Notary Public

Resident of Ramsey County.

This instrument prepared by John D. Breclaw, JOHN D. BRECLAW & ASSOCIATES  
200 West Glen Park Avenue, Griffith, IN 46319  
219-972-6000

*John D. Breclaw*  
Attorney at Law