

Mail Tax Bills to:
7932 Maple Avenue
Gary, IN 46403

94023898

QUIT-CLAIM DEED

This indenture witnesseth that: **DAVID TODD OWEN,**

of Lake County, in the State of Indiana

Conveys and warrants to: **DAVID TODD OWEN and PAMELA S. OWEN,**
Husband and Wife,

of Lake County, in the State of Indiana,

for and in consideration of love and affection, the receipt whereof is hereby acknowledged, the following real estate in Lake County, State of Indiana, to wit:

Lots 46, 47 and 48, Block 21, Norcott's Addition to Indiana City in the City of Gary, as shown in Plat Book 1, page 14, in Lake County, Indiana.

Commonly known as: 7932 Maple Avenue, Gary, IN 46403

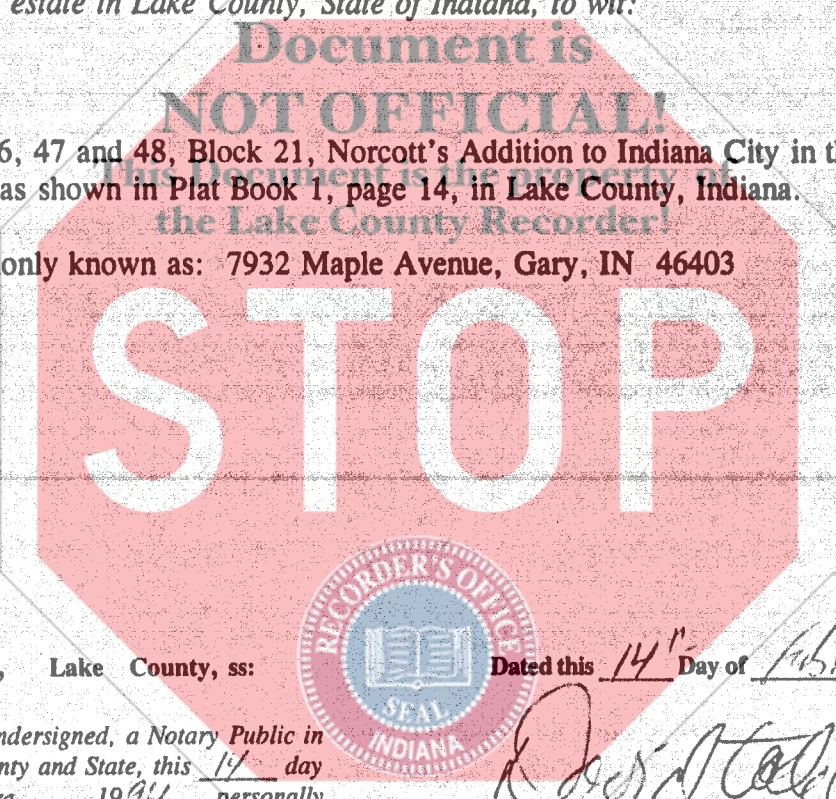

STATE OF INDIANA
LAKE CO
FILED FOR
MAR 31 9 24 AM '94
SAMUEL R. CH
RECORDER

State of Indiana, Lake County, ss: Dated this 14th Day of February, 1994.

Before me, the undersigned, a Notary Public in and for said County and State, this 14 day of February, 1994, personally appeared David Todd Owen

David Todd Owen Seal
DAVID TODD OWEN

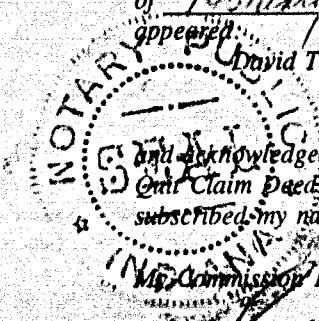

and acknowledged the execution of the foregoing Quit Claim Deed. In witness whereof, I have hereunto subscribed my name and affixed my official seal.

My Commission Expires: January 1995
Gerald M. Bishop Signature
GERALD M. BISHOP Printed Name

DULY ENTERED FOR TAXATION SUBJECT TO FINAL ACCEPTANCE FOR TRANSFER.

MAR 2 5 1994
Gerald M. Bishop
AUDITOR LAKE COUNTY

Resident of LAKE County

This instrument prepared by: GERALD M. BISHOP, ESQ.
2115 West Lincoln Hwy.
Merrillville, IN 46410
(219) 738-2988

↑
31528 700