

Mail TAX Bills to
2655 LAWRENCE ST
LAKE STATION, IN 46405

Warranty Deed

THIS INDENTURE WITNESSETH, That THOMAS CHARLES BREESE

94019091

of Lake County, in the State of Indiana Convey and Warrant
to THELMA O. GULL

2655 Lawrence Street, Lake Station, Indiana 46405

of Lake County, in the State of Indiana, for and in consideration of the sum of

Ten (\$10.00) Dollars and other good and valuable considerations-----

the receipt whereof is hereby acknowledged, the following described Real Estate in Lake County,
in the State of Indiana, to-wit:

Lot 23 and the North 1/2 of Lot 24 in Block 3
in Greater Riverview Addition to East Gary,
now Lake Station, as per plat thereof, re-
corded in Plat Book 15 page 8, in the Office
of the Recorder of Lake County, Indiana.

Subject to easements, covenants and restrictions,
and taxes of record.

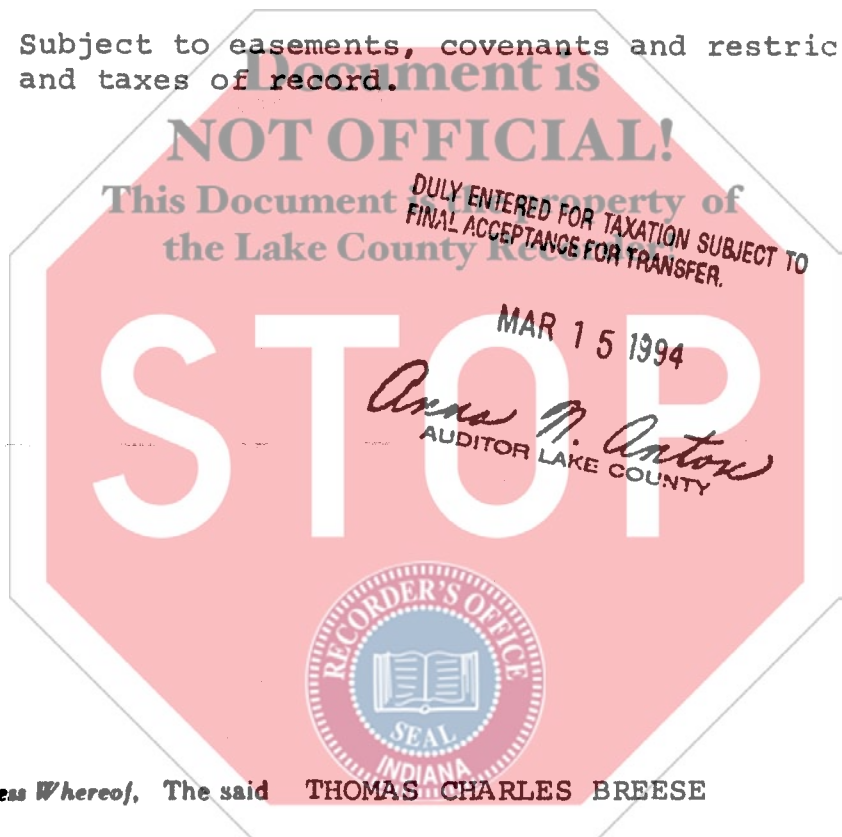

MAR 16 11 46 AM '94
S.A. RECORDER J.H.

In Witness Whereof, The said THOMAS CHARLES BREESE

has hereunto set his hand and seal, this 10th day of March 1994

_____(Seal) Thomas Charles Brees _____(Seal)
THOMAS CHARLES BREESE
_____(Seal) _____(Seal)
_____(Seal) _____(Seal)

STATE OF INDIANA, Lake COUNTY, ss:

Before me, the undersigned, a Notary Public in and for said County, this
10th day of March 1994, came

THOMAS CHARLES BREESE, and acknowledged the execution of the foregoing instrument.
Witness my hand and official seal.

My Commission expires..... 1-21-95.....

Barbara J. Hall 00846
Barbara J. Hall

This instrument prepared by:

Attorney William Enslin, 142 Rimbach, Hammond, Indiana 46320
Resident of _____ County

