

MAIL TAX BILLS TO:
2112 Wespark
Hammond, IN. 46394

94019402

H474129 LD

Return To: LAKE COUNTY TRUST COMPANY
2200 N. Main Street
P O Box 110
Crown Point, Indiana 46307

This Indenture Witnesseth

Key #34-243-4

That the Grantor Shirley J. Shaffer

of the County of Richland and State of Ohio for and in consideration of Ten Dollars (\$10.00) Dollars, and other good and valuable considerations in hand paid, Convey and Warrant unto LAKE COUNTY TRUST COMPANY, a corporation of Indiana, as Trustee under the provisions of a trust agreement dated the day of March 19 94, known as Trust Number 4523, the following described real estate in the County of Lake and State of Indiana, to-wit:

Lot 4, Block 4, Lake Addition to Hammond, as shown in Plat Book 17, Page 6, in Lake County, Indiana.

KA 26-34-243-4
COMMONLY KNOWN AS: 2112 Wespark Hammond, IN. 46394

SUBJECT TO THE FOLLOWING:

1. Restrictions, reservations, easements, terms, conditions, and covenants appearing in any instrument of record.
2. Building and zoning ordinances and laws.

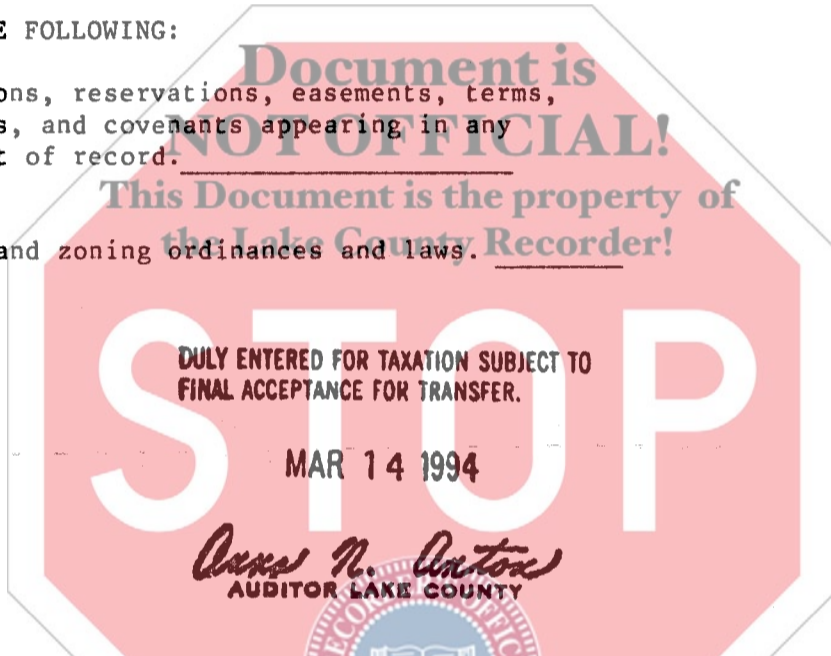

STATE OF INDIANA
FILED
MAR 15 1 33 PM '94
RECORDER

TO HAVE AND TO HOLD the said premises with the appurtenances upon the trusts and for the uses and purposes herein and in said trust agreement set forth. Full power and authority is hereby granted to said trustee to improve, manage, protect and subdivide said premises or any part thereof, to dedicate parks, streets, highways or alleys and to vacate any subdivision or part thereof, and to resubdivide said property as often as desired, to contract to sell, to grant options to purchase, to sell on any terms, to convey either with or without consideration, to convey said premises or any part thereof to a successor or successors in trust and to grant to such successor or successors in trust all of the title, estate, powers and authorities vested in said trustee, to donate, to dedicate, to mortgage, pledge or otherwise encumber said property, or any part thereof, to lease said property, or any part thereof, from time to time, in possession or reversion, by leases to commence in present or in futuro, and upon any terms and for any period or periods of time, not exceeding in the case of any single demise the term of 99 years, and to renew or extend leases upon any terms and for any period or periods of time and to amend, change or modify leases and the terms and provisions thereof at any time or times hereafter, to contract to make leases and to grant options to lease and options to renew leases and options to purchase the whole or any part of the reversion and to contract respecting the manner of fixing the amount of present or future rentals, to partition or to exchange said property, or any part thereof, for other real or personal property, to grant easements or charges of any kind, to release, convey or assign any right, title or interest in or about or easement appurtenant to said premises or any part thereof, and to deal with said property and every part thereof in all other ways and for such other considerations as it would be lawful for any person owning the same to deal with the same, whether similar to or different from the ways above specified, at any time or times hereafter.

This conveyance is made upon the express understanding and condition that neither Lake County Trust Company individually or as Trustee, nor its successor or successors in trust shall incur any personal liability or be subjected to any claim, judgment or decree for anything it or they or its or their agents or attorneys may do or omit to do in or about the said real estate or under the provisions of this Deed or said Trust Agreement or any amendment thereto, or for injury to person or property happening in or about said real estate, any and all such liability being hereby expressly waived and released. Any contract, obligation or indebtedness incurred or entered into by the Trustee in connection with said real estate may be entered into by it in the name of the then beneficiaries under said Trust Agreement as their attorney-in-fact, hereby irrevocably appointed for such purposes, or at the election of the Trustee, in its own name, as Trustee of an express trust and not individually (and the Trustee shall have no obligation whatsoever with respect to any such contract, obligation or indebtedness except only so far as the trust property and funds in the actual possession of the Trustee shall be applicable for the payment and discharge thereof.) All persons and corporations whomsoever and whatsoever shall be charged with notice of this condition from the date of the filing for record of this Deed.

In no case shall any party dealing with said trustee in relation to said premises, or to whom said premises or any part thereof shall be conveyed, contracted to be sold, leased or mortgaged by said trustee, be obliged to see to the application of any purchase money, rent, or money borrowed or advanced on said premises, or be obliged to see that the terms of the trust have been complied with, or be obliged to inquire into the necessity or expediency of any act of said trustee, or be obliged or privileged to inquire into any of the terms of said trust agreement, and every deed, trust deed, mortgage, lease or other instrument executed by said trustee in relation to said real estate shall be conclusive evidence in favor of every person relying upon or claiming under any such conveyance, lease or other instrument, (a) that at the time of the delivery thereof the trust created by this Indenture and by said trust agreement was in full force and effect, (b) that such conveyance or other instrument was executed in accordance with the trusts, conditions and limitations contained in this Indenture and in said trust agreement or in some amendment thereof and binding upon all beneficiaries thereunder, (c) that said trustee was duly authorized and empowered to execute and deliver every such deed, trust deed, lease, mortgage or other instrument and (d) if the conveyance is made to a successor or successors in trust, that such successor or successors in trust have been properly appointed and are fully vested with all the title, estate, rights, powers, authorities, duties and obligations of its, his or their predecessor in trust.

The interest of each and every beneficiary hereunder and of all persons claiming under them or any of them shall be only in the earnings, avails and proceeds arising from the sale or other disposition of said real estate, and such interest is hereby declared to be personal property, and no beneficiary hereunder shall have any title or interest, legal or equitable, in or to said real estate as such, but only an interest in the earnings, avails and proceeds thereof as aforesaid.

In Witness Whereof, the grantor aforesaid has her hereunto set

hand and seal this 8th day of MARCH 19 94

[Signature] x Shirley J. Shaffer
[Signature] x Shirley J. Shaffer

This instrument was prepared by: Attorney Gerald P. Kray, 8721 Kennedy Avenue, Highland, IN 46322

Chicago Title Insurance Company

9.00 CT

STATE OF OHIO

County of RICHLAND

) SS.

I, David A. Howard a Notary Public in and for said County, in the State aforesaid, do hereby certify that _____

SHIRLEY J. SHAFFER

personally known to me to be the same person _____ whose name IS _____ subscribed to the foregoing instrument, appeared before me this day in person and acknowledged that SHE signed, sealed and delivered the said instrument as HER free and voluntary act, for the uses and purposes therein set forth.

GIVEN under my hand and _____ NOTARY seal this 8TH day of MARCH 19 94.

David A. Howard
Notary Public

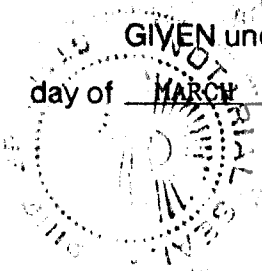

Document is the property of
NOT OFFICIAL!

DAVID A. HOWARD, Attorney at Law
NOTARY PUBLIC, STATE OF OHIO
My Commission Expires: My Commission Has No Expiration Date
Section 147:03 O.R.C.

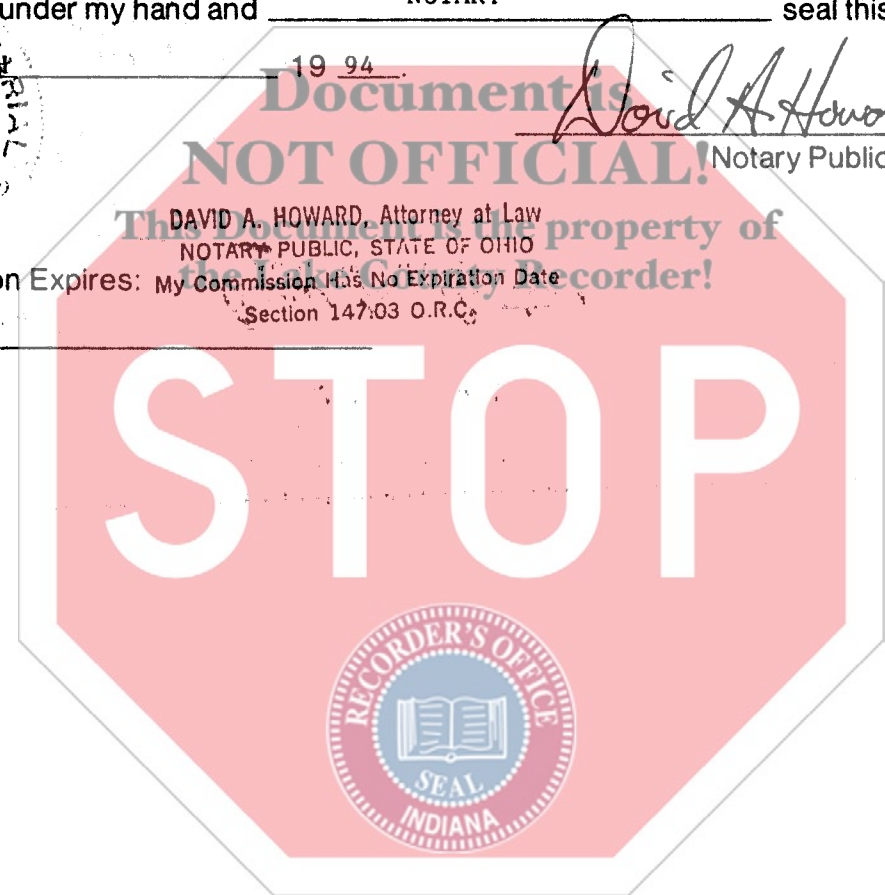

TRUST NO. _____

Deed in Trust

WARRANTY DEED
TO



LAKE COUNTY
TRUST COMPANY
TRUSTEE

PROPERTY ADDRESS

2112 Wespark, Hammond, Indiana