

Mercantile Natl Bk
5243 Holman Blvd

94007173

SATISFACTION OF LIEN MORTGAGE

This Certifies that a certain Lien executed by
MERCANTILE NATIONAL BANK OF INDIANA, as Trustee under Trust No. 4970
dated June 1, 1987

to
MERCANTILE NATIONAL BANK OF INDIANA
on 1st day of June 1987, calling for \$ 140,000.00 and recorded
in Lien Record No. 951813 Document No. 951813 Lake County, State
of Indiana, has been fully paid and satisfied, and the same is hereby released.

WITNESS hand and seal, this 7th day of January 1994
ATTEST: MERCANTILE NATIONAL BANK OF INDIANA

Mary Ann Zembala
Mary Ann Zembala
State of Indiana, Lake County, SS:

William H. Stoll, Vice President

Document is NOT OFFICIAL!
Before me, the undersigned, a Notary Public in and for said County, this 7th day of January 1994, William H. Stoll and Mary Ann Zembala, as Vice President and Assistant Cashier, respectively of Mercantile National Bank of Indiana, the Lake County Recorder!

acknowledged the execution of the annexed satisfaction of Lien.
Witness my Hand and official seal:
My Commission expires 2-4-95
Clara E. Polimac Notary Public

This instrument prepared by: Mary Ann Zembala

184600 44-25
5-20-87

TICOR TITLE INSURANCE

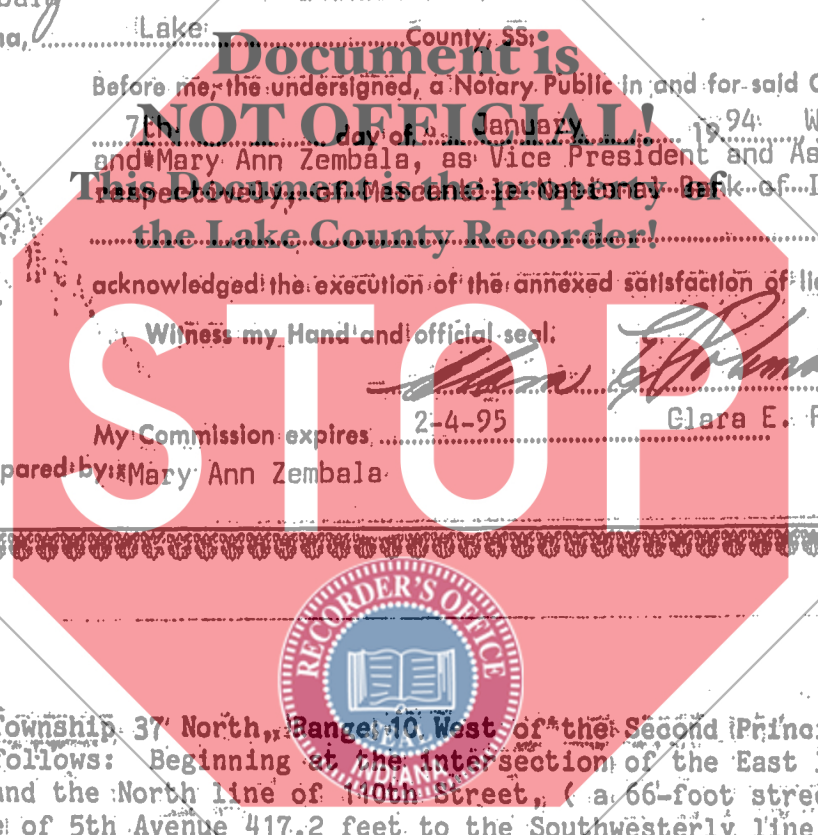

MNB - 310

Parcel I:

Part of Section 1, Township 37 North, Range 10 West of the Second Principal Meridian, being described as follows: Beginning at the intersection of the East line of 5th Avenue (a 66-foot street) and the North line of 110th Street, (a 66-foot street), thence North along said East line of 5th Avenue 417.2 feet to the Southwesterly line of Indianapolis Boulevard; thence Southeasterly along the Southwesterly line of Indianapolis Boulevard 511.8 feet to the West line of 6th Avenue, (a 66-foot street); thence South along the West line of 6th Avenue 20.7 feet to the North line of 110th Street; thence West along the North line of 110th Street 324.0 feet to the point of beginning, in the City of Hammond, Lake County, Indiana.

Parcel II:

Part of the West Half of the Northeast Quarter of Fractional Section 1, Township 37 North, Range 10 West of the Second Principal Meridian, formerly embraced within the boundaries of Lots 1 and 2; Block 10, Roby, Plat Book 3, page 15 (now vacated), described as follows:
Commencing at the point of intersection of the South line of 110th Street and the West line of 6th Avenue; thence West along the South line of 110th Street 152 feet to an alley, thence South on the East line of said alley, 48 feet; thence East parallel to the South line of said 110th Street a distance of 152 feet to the West line of 6th Avenue; thence North on the West line of 6th Avenue 48 feet to the point of beginning, in the City of Hammond, Lake County, Indiana.

Parcel III:

That part of the East half of the Northwest quarter of Section 1, Township 37 North, Range 10 West of the 2nd P.M., lying within vacated Lots 6 and 10, Block 7, Roby Subdivision, as shown in Plat Book 3 page 5, in Lake County, Indiana.

700
ti