

STATE OF INDIANA)
)SS:
COUNTY OF LAKE)

SWORN STATEMENT OF INTENTION TO HOLD LIEN
NOTICE OF MECHANIC'S LIEN

94006910

TO: ST. ANTHONY MEDICAL CENTER, INC. a/k/a ST. ANTHONY MEDICAL CENTER INC., AN INDIANA NOT FOR PROFIT CORPORATION, c/o Resident Agent: Stephen O. Leurck, Main and Franciscan, Crown Point, Indiana 46307,

The undersigned, being first duly sworn, makes this sworn statement of intention to hold a lien upon the property described below and says that:

1. The undersigned, MECHANICAL CONCEPTS, INC., by its Vice-President, Ralph D. Neff, intends to hold a lien on land commonly known as St. Anthony Medical Center, HBE Phase II, 1201 South Main Street and 201 Franciscan Drive, and adjoining parcels therein, Crown Point, Indiana, which property is more particularly and legally described as follows:

See attached legal descriptions captioned and set forth on attached Exhibits "A" and "A-1", and which are herein incorporated by express reference for all intents and purposes (H.I.),

as well as on all buildings, other structures and improvements located thereon or connected therewith for work and labor done and for materials and machinery furnished by the undersigned in the erection, construction, altering, repairing and removing of said buildings, structures and improvements for such work and labor and for such materials and machinery

2. The amount claimed under this statement is Twenty Six Thousand Six Hundred Seventy Three and 59/100 Dollars (\$26,673.59) Dollars, plus interest and attorneys fees.

3. The work and labor were done and the materials and machinery were furnished by the undersigned within the last sixty days.

Mechanical Concepts, Inc.
By: Ralph D. Neff
Ralph D. Neff, Vice-President,
c/o Attorney J. J. Stankiewicz,
7870 Broadway, Merrillville, IN 46410
"CLAIMANT"

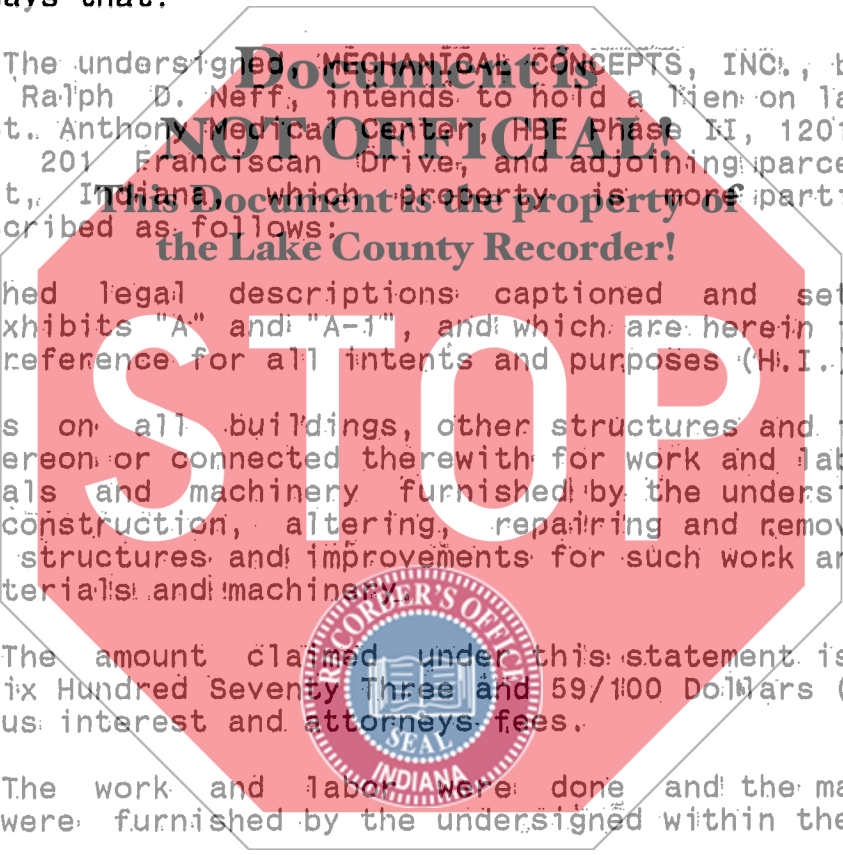

STATE OF INDIANA
LAKE COUNTY
RECORDER
JH
JAN 26 12 24 PM '94

12-00

Subscribed and sworn to before, a notary public, by Ralph D. Neff, as Vice-President of Claimant, this 26th day of January, 1994. Witness my hand and notarial seal.

Shirley Kysh
Shirley Kysh, Notary Public

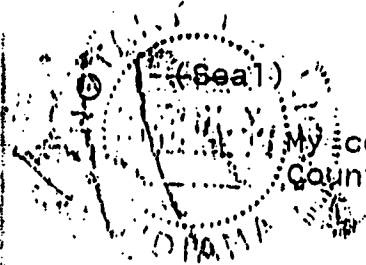

My commission expires: July 12, 1997
County of Residence: Porter

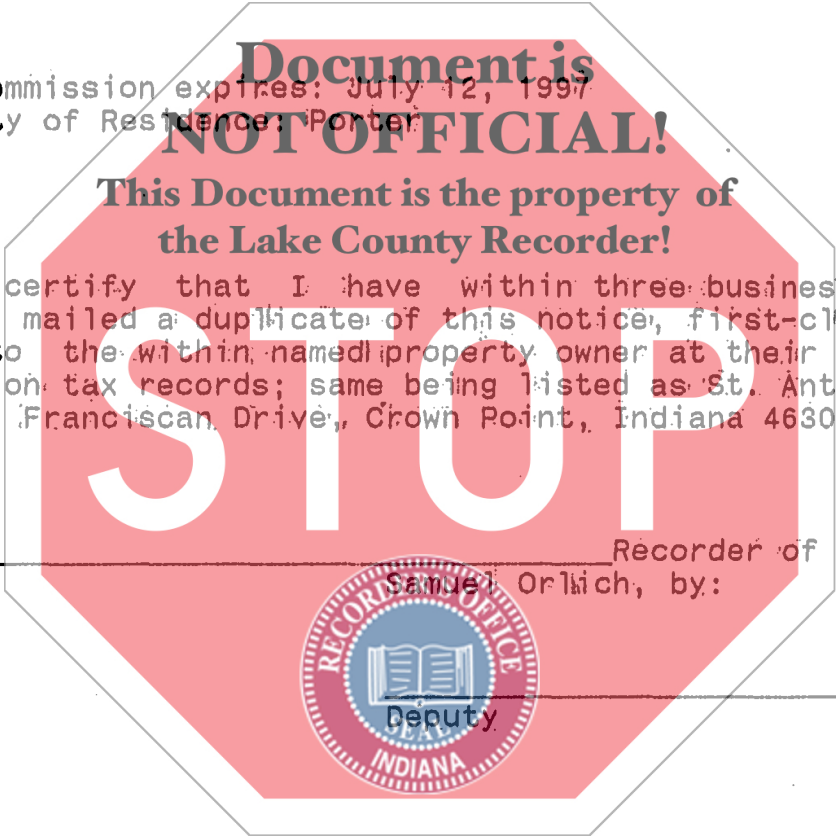

I hereby certify that I have within three business days after recording, mailed a duplicate of this notice, first-class, postage prepaid, to the within named property owner at their last address as shown on tax records; same being listed as St. Anthony Medical Center, 201 Franciscan Drive, Crown Point, Indiana 46307.

Dated: _____ Recorder of Lake County
Samuel Orlich, by: _____
Deputy

This instrument prepared by J. J. Stankiewicz & Associates 7870 Broadway, Merrillville, Indiana, Attorney at Law (219)769-1177

" EXHIBIT A "
" NO. "A-1" "
LEGAL DESCRIPTION

That part of the Northeast quarter of the Southwest quarter and the North half of the Southeast quarter of the Southwest quarter of Section 17, Township 34 North, Range 8 West of the 2nd P.M., described as follows: Commencing at the Northwest corner of the East half of the Southwest quarter of said Section; thence South along the West line of the East half of the Southwest quarter on a assumed bearing of South $0^{\circ} 04' 20''$ East 605.15 feet to railroad spike and the point of beginning of this description; thence North $89^{\circ} 55' 40''$ East 125.8 feet; thence South $65^{\circ} 05' 24''$ East 177.06 feet; thence North $44^{\circ} 53' 57''$ East 350.79 feet; thence North $45^{\circ} 06' 03''$ West 246.91 feet; thence North $0^{\circ} 03' 19''$ East 256.45 feet to the North line of the East half of the Southwest quarter of said Section; thence South $89^{\circ} 56' 41''$ East along said North line 200.44 feet; thence South $0^{\circ} 03' 19''$ West 70.66 feet; thence South $45^{\circ} 06' 03''$ East 183.15 feet; thence North $44^{\circ} 53' 57''$ East 120.80 feet; thence South $0^{\circ} 06' 03''$ East 78.88 feet to the East line of the East half of the Southwest quarter of said Section; thence South $0^{\circ} 06' 03''$ East along said East line 69.42 feet; thence South $89^{\circ} 53' 57''$ West 156.41 feet; thence South $44^{\circ} 55' 40''$ West 457.05 feet; thence South $45^{\circ} 04' 20''$ East 312.81 feet; thence South $44^{\circ} 55' 40''$ West 126.20 feet; thence North $89^{\circ} 53' 57''$ East 275.29 feet; thence North $89^{\circ} 53' 57''$ East 252.51 feet to the East line of the East half of the Southwest quarter of said Section; thence South $0^{\circ} 06' 03''$ East along said East line 59.18 feet; thence South $89^{\circ} 53' 57''$ West 192.02 feet; thence South $0^{\circ} 06' 03''$ East 157.95 feet; thence South $89^{\circ} 53' 57''$ West 194.79 feet; thence North $0^{\circ} 06' 03''$ West 283.80 feet; thence North $45^{\circ} 04' 20''$ West 448.18 feet; thence South $44^{\circ} 55' 40''$ West 576.92 feet; thence South $89^{\circ} 55' 40''$ West 215.16 feet to the West line of the East half of the Southwest quarter of said Section; thence North $0^{\circ} 04' 20''$ West along said West line 1082.48 feet to the point of beginning, in Lake County, Indiana containing 29.7345 acres, more or less, excepting therefrom that portion taken for road purposes.

