

THIS FORM HAS BEEN PREPARED FOR USE IN THE STATE OF INDIANA BY LAWYERS ONLY. THE SELECTION OF A FORM OF INSTRUMENT, FILLING IN BLANK SPACES, STRIKING OUT PROVISIONS, AND INSERTION OF SPECIAL CLAUSES, MAY CONSTITUTE THE PRACTICE OF LAW WHICH SHOULD ONLY BE DONE BY A LAWYER.

Mail tax bills to: **94001236**
2613 New York Avenue
Hammond, Indiana 46394

Tax Key No.: 34-298-4

WARRANTY DEED

COMMUNITY TITLE COMPANY
FILE NO. 27288

This indenture witnesseth that **WILLIAM J. NANNY**

of **LAKE** County in the State of **INDIANA**

Convey and warrant to **SANDRA M. NISSEN**

of **LAKE** County in the State of **INDIANA**
for and in consideration of **Ten Dollars (\$10.00)** and other good and valuable consideration,
the receipt whereof is hereby acknowledged, the following Real Estate in **LAKE** County
in the State of **Indiana**, to wit:

Lot 4 in Block 2 in Lake Shore Subdivision No. 1, in the City of Hammond, as per plat thereof, recorded January 24, 1942 in Plat Book 26 page 9, in the Office of the Recorder of Lake County, Indiana.

Commonly known as **2613 New York Avenue Hammond, Indiana**

Subject to real estate taxes for 1993 payable in 1994, together with delinquency and penalty, if any, and all real estate taxes due and payable thereafter.

Subject to recorded liens, encumbrances, easements, restrictions, ditches and drains, highways and legal rights of way.

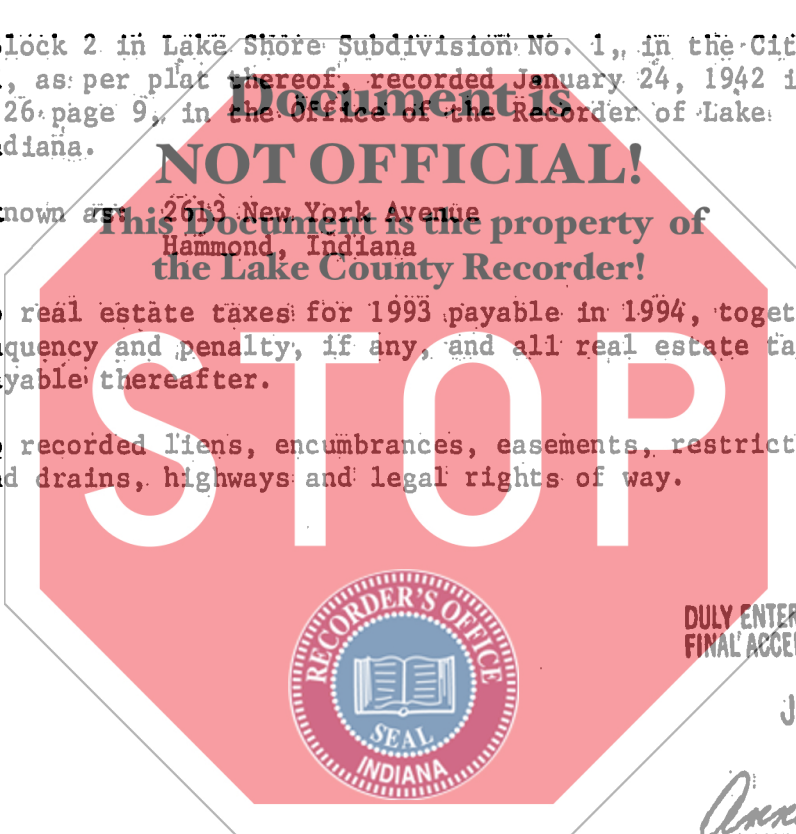

JAN 5 8 44 AM '94
SAMUEL COLLICH
RECORDER

STATE OF INDIANA
RECORDED FOR RECORD

DULY ENTERED FOR TAXATION SUBJECT TO FINAL ACCEPTANCE FOR TRANSFER!

JAN 3 1994

Anna M. Anton
AUDITOR LAKE COUNTY

State of Indiana, **LAKE** County, ss:

Before me, the undersigned, a Notary Public in and for said County and State, this **16th** day of **December** 19**93** personally appeared:

Dated this 16th Day of December 1993

William J. Nanny
William J. Nanny

WILLIAM J. NANNY

And acknowledged the execution of the foregoing deed. In witness whereof, I have hereunto subscribed my name and affixed my official seal. My commission expires _____ 19__

LOIS M. WELCH
NOTARY PUBLIC, Lake County, Indiana
My commission expires May 15, 1994
Resident of Lake County, Indiana *Lois M. Welch*
Notary Public

Resident of _____ County.

This instrument prepared by **PATRICK J. McMANAMA, P.C.** Attorney at Law