

COM 184112

TICOC-17.0

THIS FORM HAS BEEN APPROVED BY THE INDIANA STATE BAR ASSOCIATION FOR USE BY LAWYERS ONLY. THE SELECTION OF A FORM OF INSTRUMENT, FILLING IN BLANK SPACES, STRIKING OUT PROVISIONS AND INSERTION OF SPECIAL CLAUSES, CONSTITUTES THE PRACTICE OF LAW AND MAY ONLY BE DONE BY A LAWYER.

Mail tax bills to: 7635 Starling Dr. Schererville, IN 46375

CORPORATE DEED

THIS INDENTURE WITNESSETH, That K & M BUILDERS OF PORTAGE, INC.

KERRY G. WILSON, PRESIDENT ("Grantor"), a corporation organized and

existing under the laws of the State of INDIANA

AND WARRANTS — ~~RELEASES AND QUIT CLAIMS~~ to MARY ZIMMERMAN

of LAKE County, in the State of

INDIANA, in consideration of Ten dollars

the receipt of which is hereby acknowledged, the

following described real estate in LAKE County, in the State of Indiana, to-wit:

Lot 155 in Unit 4, Foxwood Estates, an Addition to the Town of Schererville, as per plat thereof, recorded in Plat Book 71 page 53, in the Office of the Recorder of Lake County, Indiana.

(Key No. 13-539-31)

This Document is the property of (Commonly known as 7635 Starling Dr. Schererville, In 46375)

Subject to the following:

1. Real estate taxes for 1993 payable 1994 and thereafter.
2. Easements and restrictions of record, if any.
3. Acts of grantee encumbering said property.

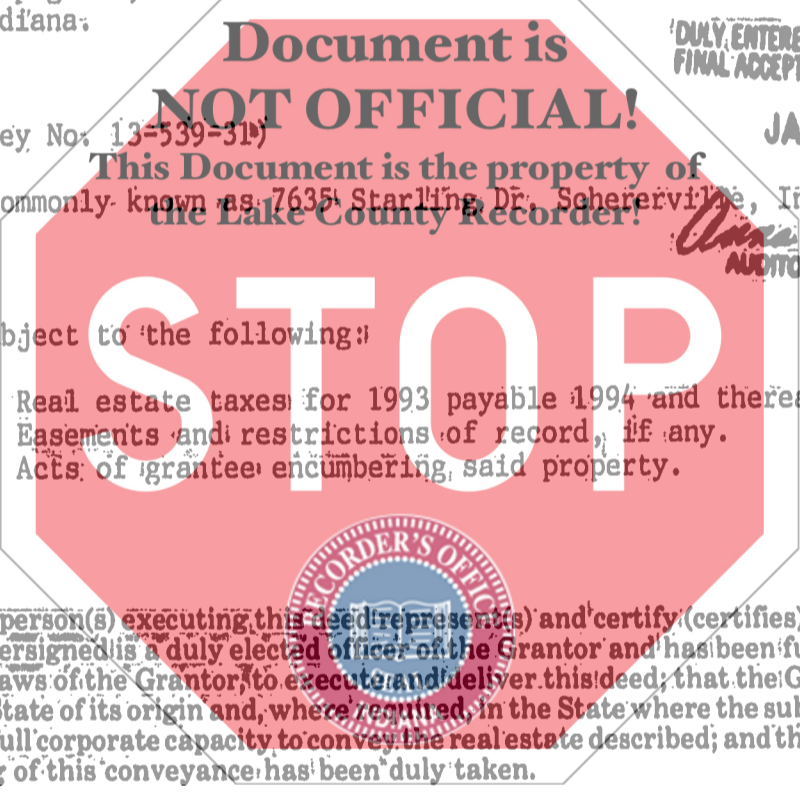

The undersigned person(s) executing this deed represent(s) and certify (certifies) on behalf of the Grantor, that (each of the undersigned is a duly elected officer of the Grantor and has been fully empowered by proper resolution, or the by-laws of the Grantor, to execute and deliver this deed; that the Grantor is a corporation in good standing in the State of its origin and, where required, in the State where the subject real estate is situate; that the Grantor has full corporate capacity to convey the real estate described; and that all necessary corporate action for the making of this conveyance has been duly taken.

IN WITNESS WHEREOF, Grantor has caused this deed to be executed this 30th

day of December, 1993
By Kerry G. Wilson
KERRY G. WILSON
(Printed Name, and Office)

K & M BUILDERS OF PORTAGE, INC.
(Name of Corporation)
By Kerry Wilson
KERRY WILSON, PRESIDENT
(Printed Name, and Office)

STATE OF INDIANA }
COUNTY OF LAKE } SS:

Before me, a Notary Public in and for said County and State, personally appeared KERRY WILSON and KERRY G. WILSON the PRESIDENT

~~and~~ ~~respectively~~ of K & M BUILDERS OF PORTAGE, INC. who acknowledged execution of the foregoing Deed for and on behalf of said Grantor; and who, having been duly sworn, stated that the representations therein contained are true.

Witness my hand and Notarial Seal this 30th day of December 1993

My Commission Expires: 10-2-97 Signature Paula Barrick

Resident of LAKE County Printed: PAULA BARRICK Notary Public

This instrument prepared by THOMAS M. DOGAN Attorney at Law

Mail to: Chapel Square, Suite 238, 7863 Broadway, Merrillville, Indiana 46410