

H472123 ed

Mail tax bills to:
2825 Jewett
Highland, Indiana, 46322
Rev. # 271-93088334

(1)

WARRANTY DEED

This Indenture Witnesseth that IRENE TERPSTRA, also known as IRENE HUIZENGA, of Lake County in the State of Indiana, CONVEYS and WARRANTS to DONALD J. GERCKEN and MARCELLA I. GERCKEN,

of Lake County in the State of Indiana; for and in consideration of Ten (10:00) Dollars and other good and valuable consideration, the receipt whereof is hereby acknowledged, the following Real Estate in the State of Indiana, to-wit:

STATE OF INDIANA
LAKE COUNTY
FILED FOR RECORD
DEC 28 10 53 AM '93
SAMUEL ORLIGN
RECORDER

Chicago Title Insurance Company

Lot 19, except the West 5 feet thereof, and the West 10 feet of the vacated alley adjoining the East line of said Lot 19, Block 14, the Town of Highland, as shown in Plat Book 1, page 86, in Lake County, Indiana; commonly described as 2825 Jewett, Highland, Indiana.

This conveyance is subject to easements, covenants, rights of way, reservations, exceptions, encroachments, grants, building lines, restrictions of record, and real estate taxes for the year 1993 payable in 1994, together with all years subsequent thereto.

Dated this 22nd day of December, 1993.

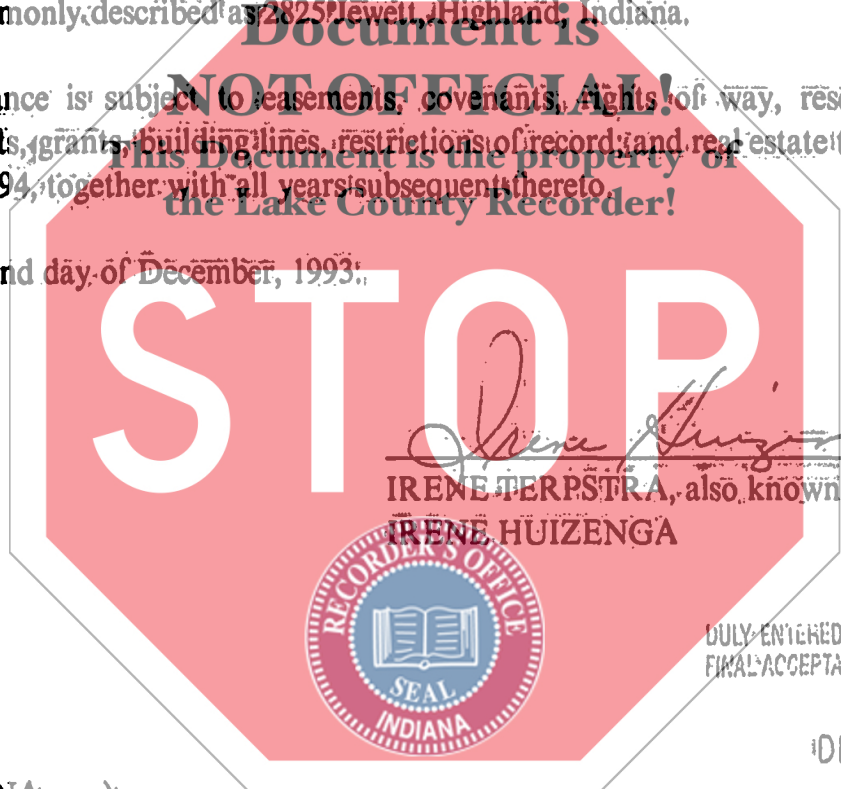

Irene Huizenga
IRENE TERPSTRA, also known as
IRENE HUIZENGA



DULY ENTERED FOR TAXATION SUBJECT TO FINAL ACCEPTANCE FOR TRANSFER.

DEC 27 1993

Anna M. Antone
AUDITOR LAKE COUNTY

STATE OF INDIANA)
) SS:
COUNTY OF LAKE)

Before me, the undersigned, a Notary Public in and for said County and State, this 22nd day of December, 1993, personally appeared IRENE TERPSTRA, also known as IRENE HUIZENGA, and acknowledged the execution of the foregoing deed.

In Witness whereof, I have hereunto subscribed my name and affixed my official seal.

Julia I. Quisenberry
Julia I. Quisenberry, Notary Public
Resident of Newton County, Indiana

My Commission Expires:
December 16, 1994

This Instrument Prepared By: Jason L. Horn, Attorney at Law
9337 Calumet Avenue, Munster, IN 46321

Handwritten initials