

20

U.S. Railroad Vest Corp.
703 Michigan Ave
Suite 4
LaPorte, Ind. 46350

7

93086069

CASE NO. 70681-N

RECEIVED
DEC 20 1993
LA PORTE, IN

TO WHOM IT MAY CONCERN:

I HEREBY CERTIFY THAT BY THE AUTHORITY CONFERRED BY THE BOARD OF DIRECTORS OF CONSOLIDATED RAIL CORPORATION (CONRAIL) ON MARCH 18, 1988 TO THE CHAIRMAN AND CHIEF EXECUTIVE OFFICER TO CONDUCT THE BUSINESS AND AFFAIRS OF THE CORPORATION AND TO DELEGATE SUCH AUTHORITY AS HE MAY DEEM NECESSARY, THE CHAIRMAN, PRESIDENT AND CHIEF EXECUTIVE OFFICER DID DELEGATE ON MARCH 19, 1991 TO THE SENIOR VICE PRESIDENT DEVELOPMENT, WHO ON MAY 23, 1991 REDELEGATED TO THE ASSISTANT VICE PRESIDENT-ASSET DEVELOPMENT, AND WHO ON JUNE 26, 1991 REDELEGATED TO THE DIRECTOR REAL ESTATE FIELD SERVICES AND DIRECTOR MANAGEMENT SERVICES (NOW KNOWN AS DIRECTOR-ASSET MANAGEMENT), OR ANY OF THEM, THE AUTHORITY TO EXECUTE AND DELIVER ON BEHALF OF CONRAIL ANY AND ALL DOCUMENTS NECESSARY TO COMPLETE THE SALE OF 101.64 ACRES, MORE OR LESS, OF THE CORPORATION'S ABANDONED RIGHT OF WAY (LINE CODES 3107 CONTAINING 80.24 ACRES, MORE OR LESS, AND 3233 CONTAINING 21.4 ACRES, MORE OR LESS), LOCATED IN THE COUNTY OF LAKE, INDIANA, FOR THE TOTAL CONSIDERATION OF \$1,612 TO U.S. RAILROAD VEST CORPORATION, OR THE NOMINEE THEREOF.

Wilberta C. Jackson

Assistant Secretary

WILBERTA C. JACKSON



DAILY ENTERED FOR TAXATION SUBJECT TO FINAL ACCEPTANCE FOR TRANSFER.

DEC 20 1993

Gene M. ...
AUDITOR LAKE COUNTY

4400
31188

"KEY # _____"

THIS INDENTURE WITNESSETH, that CONSOLIDATED RAIL CORPORATION, a Corporation of the Commonwealth of Pennsylvania, whose mailing address is Two Commerce Square, 2001 Market Street, Philadelphia, Pennsylvania, 19101-1419, hereinafter referred to as the Grantor, for and in consideration of the sum of ONE THOUSAND SIX HUNDRED TWELVE DOLLARS (\$1,612.00), to it paid, the receipt of which sum is hereby acknowledged, Grantor hereby releases and quitclaims to U.S. RAILROAD VEST CORPORATION, a Corporation of the State of Indiana, having a mailing address of 7031 Michigan Avenue, Suite 4, La Porte, Indiana 46350, hereinafter referred to as the Grantee, all its right, title and interest of, in and to the following described premises:

ALL THOSE CERTAIN strips, pieces or parcels of land, together with the improvements, structure, building, track and appurtenances thereon, and being a part or portion of Grantor's property identified as Line Codes 3107 and 3233 in Grantor's corporate records and situate in the County of Lake in the State of Indiana, which are generally described in Exhibit "A" hereof, and generally indicated on Exhibit "B" hereof, herein referred to as "Premises".

EXCEPTING thereout and therefrom the exceptions as provided in Exhibit "A".

UNDER and SUBJECT, however, to (1) whatever rights the public may have to the use of any roads, alleys, bridges or streets crossing the Premises, (2) any streams, rivers, creeks and water ways passing under, across or through the Premises, and (3) any easements or agreements of record or otherwise affecting the Premises, and to the state of facts which a personal inspection or accurate survey would disclose, and to any pipes, wires, poles, cables, culverts, drainage courses or systems and their appurtenances now existing and remaining in, on, under, over, across and through the Premises, together with the right to maintain, repair, renew, replace, use and remove same.

THIS INSTRUMENT is executed and delivered by Grantor, and is accepted by Grantee, subject to the covenants set forth below, which shall be deemed part of the consideration of this conveyance and which shall run with the land and be binding upon, and inure to the benefit of, the legal representatives, successors and assigns of Grantor and Grantee. Grantee hereby knowingly, willingly, and voluntarily waives the benefit

of any rule, law, custom, or statute of the State of Indiana now or hereafter in force with respect to the covenants set forth below.

(1) Should a claim adverse to the title hereby quitclaimed be asserted and/or proved, no recourse shall be had against the Grantor herein.

(2) Grantee by the acceptance of this Instrument, does hereby accept all existing and prospective responsibility for removal and/or restoration costs for any and all railroad bridges and grade crossings, drainage ditches, culverts and their appurtenances that may be located on the Premises conveyed to the said Grantee; and Grantee further covenants and agrees that it will also assume any obligation and/or responsibility, as may have been or may hereafter be imposed on Grantor by any Public Utility Commission or any other governmental agency having jurisdiction for any and all bridge structures and grade crossings, drainage ditches, culverts and their appurtenances, including but not limited to the removal, repairing or restoration of same in accordance with the requirements of said Commission or other governmental agency; and Grantee further agrees to indemnify, defend and hold Grantor harmless against all costs, penalties, expenses, obligations, responsibility and requirements associated with said bridge structures and grade crossings, drainage ditches, culverts and their appurtenances.

THE words "Grantor" and "Grantee" used herein shall be construed as if they read "Grantors" and "Grantees", respectively, whenever the sense of this instrument so requires and whether singular or plural; such words shall be deemed to include at all times and in all cases the heirs, legal representatives or successors and assigns of the Grantor and Grantee.



IN WITNESS WHEREOF, the said Grantor has caused this

Indenture to be executed by M. Virginia Ebert, its Director-Asset Management, and attested by WILBERTA C. JACKSON, its Assistant Secretary, this 21st day of September A.D. 1993.

Signed, sealed and delivered in the presence of: **CONSOLIDATED RAIL CORPORATION** By:

Juliana R. Sparks
JULIANA JR. SPARKS,

M. Virginia Ebert
M. Virginia Ebert,
Director-Asset Management

ATTEST:

Juliana R. Sparks
JULIANA R. SPARKS,

Wilberta C. Jackson
Assistant Secretary
WILBERTA C. JACKSON



Document is NOT OFFICIAL
This Document is the property of the Lake County Recorder!
COMMONWEALTH OF PENNSYLVANIA)
COUNTY OF PHILADELPHIA)

BEFORE ME, the undersigned, a Notary Public in and for said Commonwealth and County, personally appeared M. Virginia Ebert, as Director-Asset Management and WILBERTA C. JACKSON, its Assistant Secretary, respectively, of CONSOLIDATED RAIL CORPORATION, and severally acknowledged the execution of the foregoing Instrument to be the voluntary act and deed of said CONSOLIDATED RAIL CORPORATION, and their voluntary act and deed as such officers.

WITNESS my hand and notarial seal, this 21st day of September A.D. 1993:

Francis C. Flynn
Notary Public

Notarial Seal
Francis C. Flynn, Notary Public
Philadelphia, Philadelphia County
My Commission Expires July 2, 1995
Member, Pennsylvania Association of Notaries

THIS INSTRUMENT PREPARED BY:

**Juliana R. Sparks
Consolidated Rail Corporation
19-B, Two Commerce Square
2001 Market Street
Philadelphia, Pennsylvania 19101-1419
Case No. 70681-N**

:nls



CASE NO: 70681-N

DEED TO

U.S. RAILROAD VEST CORPORATION

EXHIBIT "A"

Lake County, Indiana

Columbus Chicago Main Line, Line Code 3107

ALL THAT CERTAIN property of the Grantor, being a portion of the line of railroad known as the Columbus Chicago Main Line, and identified as Line Code 3107 in the Recorder's Office of Lake County, Indiana in Deed Book Volume 49 at page 811, situate in the County of Lake and the State of Indiana, herein referred to as Premises and being further described as follows:

This Document is the property of BEING all that portion of Grantor's abandoned railroad line known as Columbus Chicago Main, being further referred to as Sub. Number 309, Line Code 3107, situate in said County and described as follows:

ENTERING the County at the division line of Porter and Lake Counties in Section 4, Township 33 North, Range 7 West, Township of Winfield, and terminating in the County at the west line of Section 15, Township 34 North, Range 8 West, Township of Center.

BEING further described as being located in Sections 4 and 5, Township 33 North, Range 7 West and the Township of Winfield; Sections 32, 31 and 30, Township 34 North, Range 7 West, Township of Winfield; Sections 25, 26, 23, 22 and 15, Township 34 North, Range 8 West, Townships of Winfield and Center.

THE Beginning and Ending Points are indicated on Grantor's Case Plan No. 70681-N, sheets 1 through 8 in Exhibit "B" hereof.

CONTAINING approximately 80.24 acres, more or less.

EXCEPTING therefrom those portions having either been previously sold or subject to a Quiet Title Suit as follows:

THIS EXHIBIT "A" CONTAINS 4 PAGES, OF WHICH THIS IS PAGE 1 OF 4.

KEY 7-11-13
KEY 7-18-7
KEY 7-19-17
KEY 7-20-5
KEY 10-1-6
KEY 10-2-3
KEY 10-27-3
KEY 10-28-3
KEY 10-31-18
KEY 10-37-40

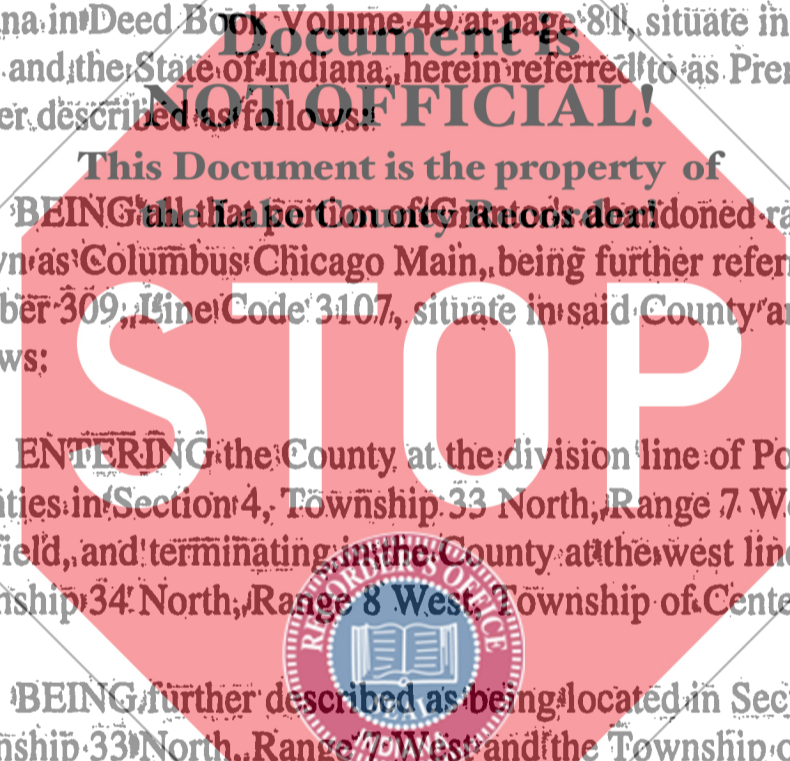

| Case Number | Grantee | Date Sold or Suit Deceid |
|-------------|------------------------------|-------------------------------|
| 68041 | Harlan Fugate | May 7, 1986 |
| 68143 | Evelyn Stokes | August 22, 1986 |
| 68745 | Lawrence Tournquist (QT) | March 25, 1987, Box 106450 |
| | Joseph & Lucille Plesac (QT) | August 4, 1992 |

BEING a part or portion of the same premises which John C. Kohl, as Trustee of the Property of Philadelphia, Baltimore and Washington Railroad Company, Debtor, by Conveyance Document No. PB&W-CRC-RP-34, dated March 29, 1976 and recorded on October 17, 1978, in the Recorder's Office of Lake County, Indiana, in Deed Book Volume 49 at page 76 & c., granted and conveyed unto Consolidated Rail Corporation.



THIS EXHIBIT "A" CONTAINS 4 PAGES, OF WHICH THIS IS PAGE 2 OF 4.

CASE NO. 70681-N

DEED TO

U.S. RAILROAD VEST CORPORATION

EXHIBIT "A"

Lake County, Indiana

Hartsdale Branch, Line Code 3233

ALL THAT CERTAIN property of the Grantor, being a portion of the line of railroad known as the Hartsdale Branch, and identified as Line Code 3233 in the Recorder's Office of Lake County, Indiana in Deed Book Volume 49 at page 85, situate in the County of Lake and the State of Indiana, herein referred to as Premises, and being further described as follows:

This Document is the property of
BEING all that portion of Grantor's abandoned railroad line known as Hartsdale Branch, being further referred to as Sub. Number 761, Line Code 3233, situate in said County and described as follows:
KEY 13-3-2, KEY 14-2-23, KEY 14-7-22, KEY 14-8-25

BEGINNING at the County at a point in Section 8, Township 35 North, Range 9 West, Township of St. John's at Grantor's Mile Post 12.1 (also being the westerly right of way line of Grantor's Kankakee Secondary, and leaving in the County at the Indiana/Illinois State Line.

BEING further described as being located in Sections 7 and 9, Township 35 North, Range 9 West and Township of St. John.

THE Beginning and Ending Points are indicated on Grantor's Case Plan No. 70681-N, sheets 9 and 10, in Exhibit "B" hereof.

CONTAINING approximately 21.4 acres, more or less.

BEING a portion of the same premises which Joliet and Northern Indiana Railroad Company, by Conveyance Document No. J&NI-CRC-RPI-2, issued pursuant to the Regional Rail Reorganization Act of 1973, as amended (P.L. 93-236, H.R. 9142), the Final System Plan of the United States Railway Association and Special Court (Washington, D.C.) Misc. Order No. 75-3, dated March 25, 1976 and March 31, 1976,

THIS EXHIBIT "A" CONTAINS 4 PAGES, OF WHICH THIS IS PAGE 3 OF 4.

in the Matter of Regional Rail Reorganization Proceedings, granted and conveyed certain property, easements, interest and rights unto Consolidated Rail Corporation and which Conveyance Document was recorded on October 17, 1978 in the Recorder's Office of Lake County, Indiana, in Deed Book Volume 49 at page 81 &c.



THIS EXHIBIT "A" CONTAINS 4 PAGES, OF WHICH THIS IS PAGE 4 OF 4.

CASE NO. 70681-N

DEED TO:

**Document is
NOT OFFICIAL!**

**This Document is the property of
the Lake County Recorder!**

U.S. RAILROAD VEST CORPORATION

STOP



EXHIBIT "B"

THIS EXHIBIT "B" CONTAINS 10 MAPS.

CASE NO. 70681-N
 SHEET 11 OF 10
 LAKE COUNTY
 L.C. 3107
 VS. 41N(7148)/161-168
 AT. W46 M. 65-70



Document is
NOT OFFICIAL!
 This Document is the property of
 the Lake County Recorder!

STOP



| | | | | | | | | | | | | | | | | | | | | | | | | | | | | | | | | | | | | | | | | | | | | | | | | | | | | | | | | | | | | | | | | | | | | | | | | | | | | | | | | | | | | | | | | | | | | | | | | | | | |
|---|---|---|---|---|---|---|---|---|----|----|----|----|----|----|----|----|----|----|----|----|----|----|----|----|----|----|----|----|----|----|----|----|----|----|----|----|----|----|----|----|----|----|----|----|----|----|----|----|----|----|----|----|----|----|----|----|----|----|----|----|----|----|----|----|----|----|----|----|----|----|----|----|----|----|----|----|----|----|----|----|----|----|----|----|----|----|----|----|----|----|----|----|----|----|----|----|----|----|-----|
| 1 | 2 | 3 | 4 | 5 | 6 | 7 | 8 | 9 | 10 | 11 | 12 | 13 | 14 | 15 | 16 | 17 | 18 | 19 | 20 | 21 | 22 | 23 | 24 | 25 | 26 | 27 | 28 | 29 | 30 | 31 | 32 | 33 | 34 | 35 | 36 | 37 | 38 | 39 | 40 | 41 | 42 | 43 | 44 | 45 | 46 | 47 | 48 | 49 | 50 | 51 | 52 | 53 | 54 | 55 | 56 | 57 | 58 | 59 | 60 | 61 | 62 | 63 | 64 | 65 | 66 | 67 | 68 | 69 | 70 | 71 | 72 | 73 | 74 | 75 | 76 | 77 | 78 | 79 | 80 | 81 | 82 | 83 | 84 | 85 | 86 | 87 | 88 | 89 | 90 | 91 | 92 | 93 | 94 | 95 | 96 | 97 | 98 | 99 | 100 |
|---|---|---|---|---|---|---|---|---|----|----|----|----|----|----|----|----|----|----|----|----|----|----|----|----|----|----|----|----|----|----|----|----|----|----|----|----|----|----|----|----|----|----|----|----|----|----|----|----|----|----|----|----|----|----|----|----|----|----|----|----|----|----|----|----|----|----|----|----|----|----|----|----|----|----|----|----|----|----|----|----|----|----|----|----|----|----|----|----|----|----|----|----|----|----|----|----|----|----|-----|

PHILA. BALTO. & WASHINGTON R. R.
 FORMERLY
 RIGHT OF WAY AND TRACK MAP
 PITTSBURGH, CINCINNATI, CHICAGO & ST. LOUIS RY.
 LOGANSPOUT DIVISION
 STATION MILEAGE TO STATION MILEAGE
 MADE AND CHECKED BY [illegible] DATE [illegible]
 OFFICE OF COLLECTION ENGINEER
 [illegible]



LAKE COUNTY, INDIANA
CENTER TOWNSHIP

CASE NO. 70681-N
SHEET 7 OF 10
LAKE CO.

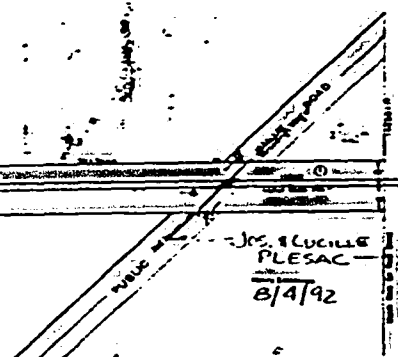
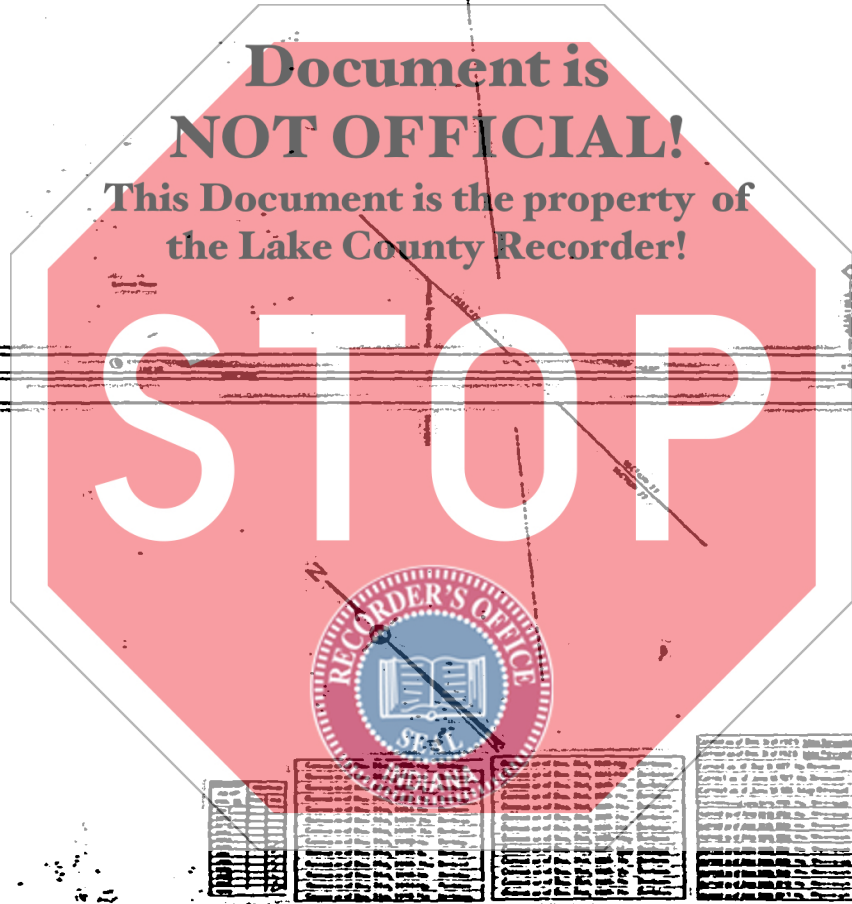

P.M.A. BALTO. & WASHINGTON R. R.
FORMERLY
RIGHT OF WAY AND TRACK MAP
PITTSBURGH, CINCINNATI, CHICAGO & ST. LOUIS RY.
LOGANSPORT DIVISION
STATION 1418177 TO STATION 1420077
SCALE 1/4" = 100 FT.
DATE OF RECORDING 1902

| | | | | | |
|--|--|--|--|--|--|
| | | | | | |
| | | | | | |
| | | | | | |
| | | | | | |
| | | | | | |

| | | | | | |
|--|--|--|--|--|--|
| | | | | | |
| | | | | | |
| | | | | | |
| | | | | | |
| | | | | | |



CASE NO. 70681-N
SHEET 8 OF 10
LAKE CO.

LAKE COUNTY, INDIANA
CENTER TOWNSHIP



SECTION 15
SECTION 16
END

| | | | | | | | | | |
|----|----|----|----|----|----|----|----|----|-----|
| 1 | 2 | 3 | 4 | 5 | 6 | 7 | 8 | 9 | 10 |
| 11 | 12 | 13 | 14 | 15 | 16 | 17 | 18 | 19 | 20 |
| 21 | 22 | 23 | 24 | 25 | 26 | 27 | 28 | 29 | 30 |
| 31 | 32 | 33 | 34 | 35 | 36 | 37 | 38 | 39 | 40 |
| 41 | 42 | 43 | 44 | 45 | 46 | 47 | 48 | 49 | 50 |
| 51 | 52 | 53 | 54 | 55 | 56 | 57 | 58 | 59 | 60 |
| 61 | 62 | 63 | 64 | 65 | 66 | 67 | 68 | 69 | 70 |
| 71 | 72 | 73 | 74 | 75 | 76 | 77 | 78 | 79 | 80 |
| 81 | 82 | 83 | 84 | 85 | 86 | 87 | 88 | 89 | 90 |
| 91 | 92 | 93 | 94 | 95 | 96 | 97 | 98 | 99 | 100 |

| | | | | | | | | | |
|----|----|----|----|----|----|----|----|----|-----|
| 1 | 2 | 3 | 4 | 5 | 6 | 7 | 8 | 9 | 10 |
| 11 | 12 | 13 | 14 | 15 | 16 | 17 | 18 | 19 | 20 |
| 21 | 22 | 23 | 24 | 25 | 26 | 27 | 28 | 29 | 30 |
| 31 | 32 | 33 | 34 | 35 | 36 | 37 | 38 | 39 | 40 |
| 41 | 42 | 43 | 44 | 45 | 46 | 47 | 48 | 49 | 50 |
| 51 | 52 | 53 | 54 | 55 | 56 | 57 | 58 | 59 | 60 |
| 61 | 62 | 63 | 64 | 65 | 66 | 67 | 68 | 69 | 70 |
| 71 | 72 | 73 | 74 | 75 | 76 | 77 | 78 | 79 | 80 |
| 81 | 82 | 83 | 84 | 85 | 86 | 87 | 88 | 89 | 90 |
| 91 | 92 | 93 | 94 | 95 | 96 | 97 | 98 | 99 | 100 |

PHILA. BALTO. & WASHINGTON R. R.
FORMERLY
RIGHT OF WAY AND TRACK MAP
PITTSBURGH, CINCINNATI, CHICAGO & ST. LOUIS RY.
LOGANSPORT DIVISION
STATION 14200+00 TO STATION 14340+00



CASE NO. 70681-N
SHEET 9 OF 10

| SCHEDULE OF PROPERTY | | | |
|----------------------|------|--------|---------|
| SECTION | DATE | RECORD | REMARKS |
| | | | |
| | | | |
| | | | |
| | | | |

LAKE CO. IND.
ST. JOHNS-TWP.
T. 38 N. R. 9 W.

LAKE COUNTY
L.C. 3233
VS. 443(4430)/748
U.P. 28 F. 3

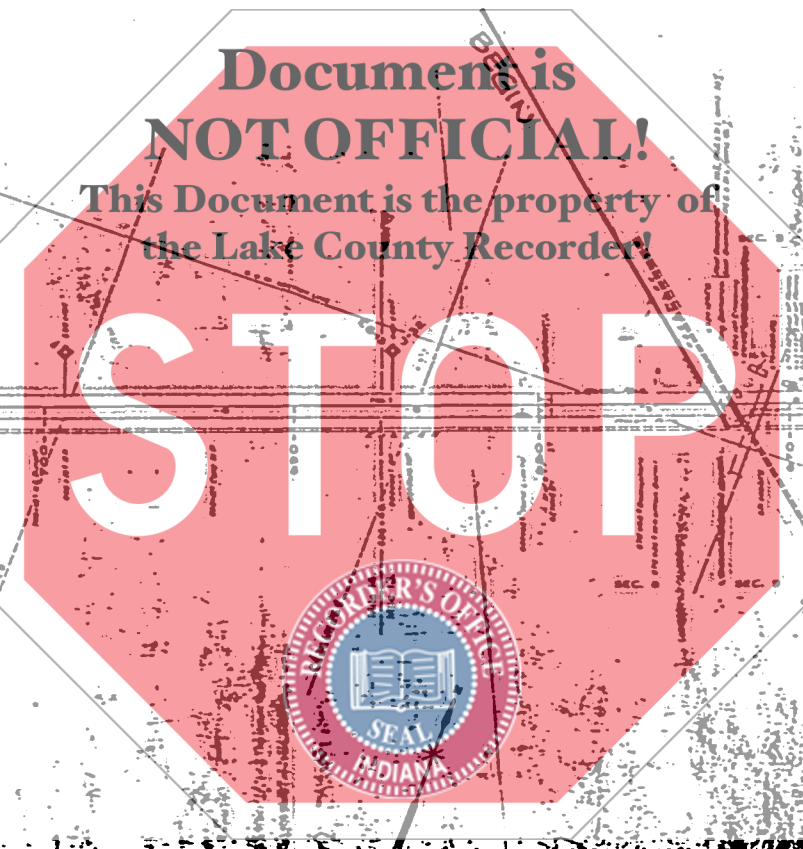

Document is NOT OFFICIAL!
This Document is the property of the Lake County Recorder!

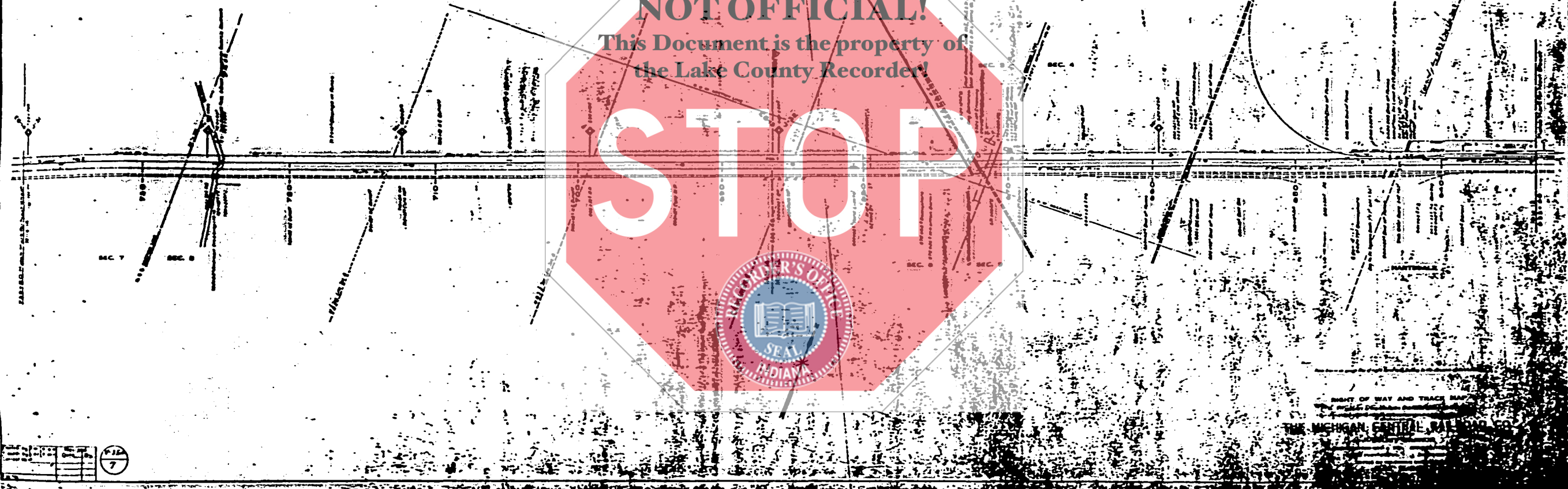

| | | | |
|--|--|--|--|
| | | | |
| | | | |
| | | | |
| | | | |

RIGHT OF WAY AND TRACK MAP
THE MICHIGAN CENTRAL RAILROAD CO.

