

LTTC 56718

93085920

A WARNING TO THE PARTIES TO A TRANSFER OF PROPERTY: It is highly unlikely that the single act of reading this document would be found to constitute "all appropriate inquiry into the previous ownership and uses of the property" so as to protect you against liability under the "innocent purchaser" provision of the federal Comprehensive Environmental Response, Compensation and Liability Act, 42 U.S.C. 9601(35)(B). You are strongly encouraged not only to read this document carefully but also to take all other actions necessary to the exercise of due diligence in your inquiry into the previous ownership and uses of the property.

**ENVIRONMENTAL DISCLOSURE DOCUMENT FOR
TRANSFER OF REAL PROPERTY**

The following information is provided under IC 13-7-22.5, the Property Transfer Law. For Use by County Recorder's Office: County: _____ Date: _____

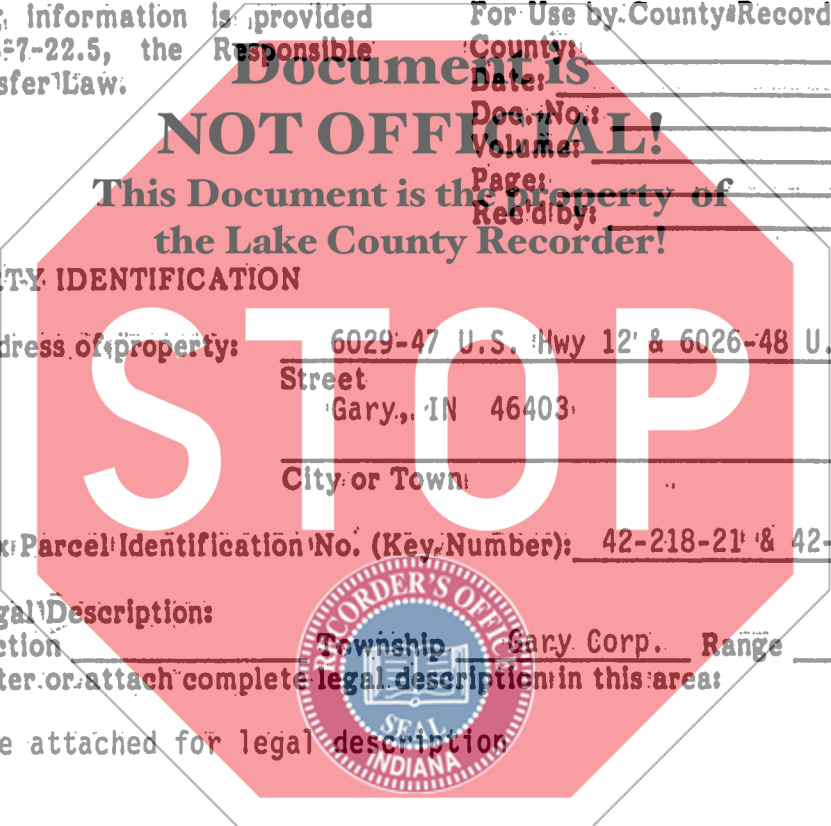

Document is NOT OFFICIAL!

This Document is the property of the Lake County Recorder!

I. PROPERTY IDENTIFICATION

A. Address of property: 6029-47 U.S. Hwy 12 & 6026-48 U.S. Hwy 20
Street Gary, IN 46403

Gary Corp. Township

Tax Parcel Identification No. (Key Number): 42-218-21 & 42-218-41 unit 25

B. Legal Description: Section _____ Township Gary Corp. Range _____
Enter or attach complete legal description in this area:

See attached for legal description

ONE...
GROUND...

LIABILITY DISCLOSURE

Transferors and transferees of real property are advised that their ownership or other control of such property may render them liable for environmental cleanup costs whether or not they caused or contributed to the presence of environmental problems in association with the property.

24/1/98
00348

C. Property Characteristics:

Lot Size 122 x 257 Acreage .75

Check all types of improvement and uses that pertain to the property:

- Apartment building (6 units or less)
- Commercial apartment (over 6 units)
- Store, office, commercial building
- Industrial building
- Farm, with buildings
- Other (specify) Former Gas Station

II. NATURE OF TRANSFER

		Yes	No
A.	(1) Is this a transfer by deed or other instrument of conveyance of fee title to property?	<u>x</u>	<u> </u>
	(2) Is this a transfer by assignment of over 25% of beneficial interest of a land trust?	<u> </u>	<u>x</u>
	(3) A lease exceeding a term of 40 years?	<u> </u>	<u>x</u>
	(4) A collateral assignment of beneficial interest?	<u> </u>	<u>x</u>
	(5) An installment contract for the sale of property?	<u> </u>	<u>x</u>
	(6) A mortgage or trust deed?	<u> </u>	<u>x</u>
	(7) A lease of any duration that includes an option to purchase?	<u> </u>	<u>x</u>

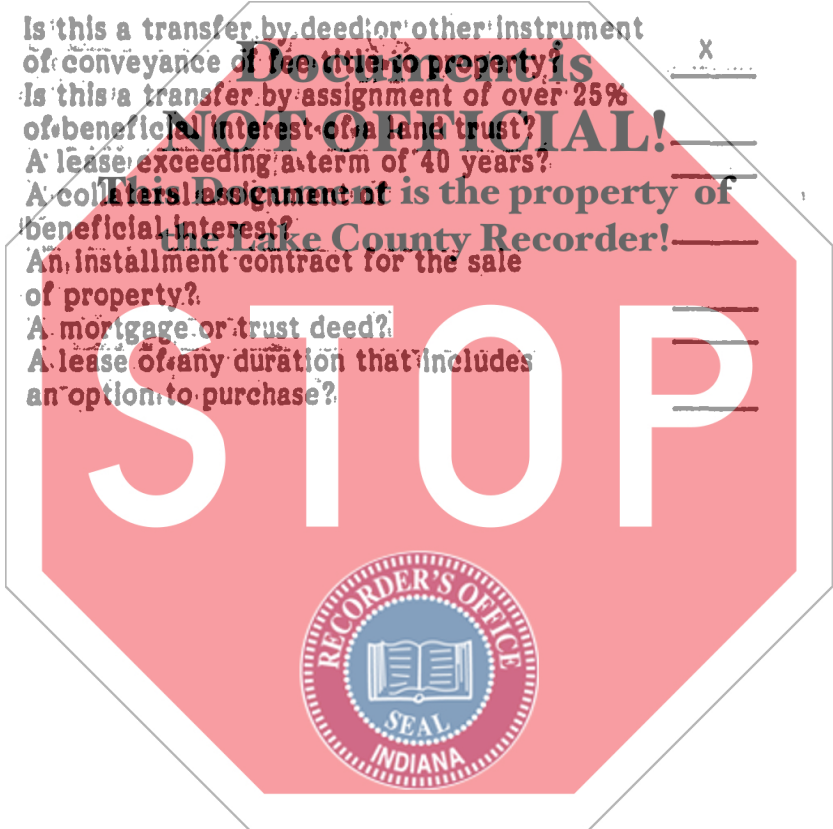

B. (1) Identify Transferor:

Nassar Fardad

Name _____ Telephone _____
c/o Box 331
Current Address of Transferor _____
Flossmoor IL 60422
City State Zip Code

Name and Address of Trustee if this is a transfer of beneficial interest of a land trust.

Name _____ Telephone _____
Current Address of Trustee _____ Trust No. _____
City State Zip Code

(2) Identify person who has completed this form on behalf of the Transferor and who has knowledge of the information contained in this form:

Leslie C. Barnard 708-841-7005

Name _____ Telephone _____

Position (if any) _____

Address _____

Box 331

City Flossmoor State IL Zip Code 60422

C. Identify Transferee:

James B. Meyer 219-938-0800

Name _____ Telephone _____

6917 Forest Ave.

Current Address of Transferee _____

Gary IN 46403
City State Zip Code

III. ENVIRONMENTAL INFORMATION

A. Regulatory Information During Current Ownership

1. Has the transferor ever conducted operations on the property which involved the generation, manufacture, processing, transportation, treatment, storage, or handling of a "hazardous substance", as defined by IC 13-7-8.7-1? This question does not apply to consumer goods stored or handled by a retailer in the same form and approximate amount, concentration, and manner as they are sold to consumers, unless the retailer has engaged in any commercial mixing (other than paint mixing or tinting of consumer sized containers), finishing, refinishing, servicing, or cleaning operations on the property.

Yes: _____

No:

2. Has the transferor ever conducted operations on the property which involved the processing, storage, or handling of petroleum, other than that which was associated directly with the transferor's vehicle usage?

Yes: _____

No:

3. Has the transferor ever conducted operations on the property which involved the generation, transportation, storage, treatment, or disposal of "hazardous waste", as defined in IC 13-7-1?

Yes: _____

No:

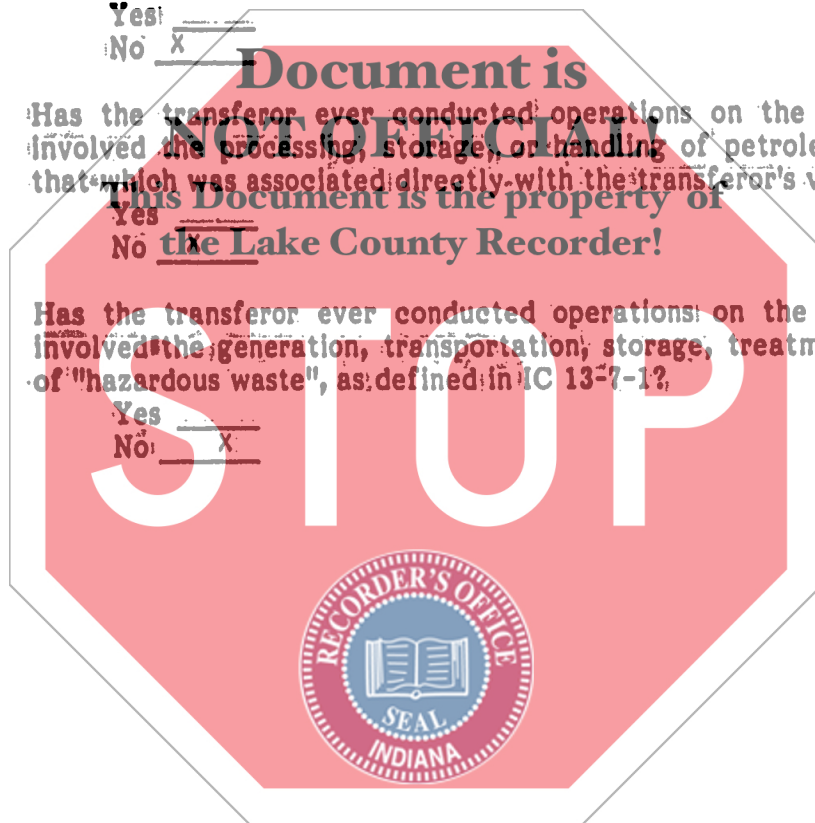

4. Are there any of the following specific units (operating or closed) at the property that are used or were used by the transferor to manage hazardous wastes, hazardous substances, or petroleum?

	YES	NO
Landfill	_____	X _____
Surface Impoundment	_____	X _____
Land Application	_____	X _____
Waste Pile	_____	X _____
Incinerator	_____	X _____
Storage Tank (Above Ground)	_____	X _____
Storage Tank (Underground)	X _____	_____
Container Storage Area	_____	X _____
Injection Wells	_____	X _____
Wastewater Treatment Units	_____	X _____
Septic Tanks	_____	X _____
Transfer Stations	_____	X _____
Waste Recycling Operations	_____	X _____
Waste Treatment/ Detoxification	_____	X _____
Other Land Disposal Area	_____	X _____

If there are "YES" answers to any of the above items and the transfer of property that requires the filing of this document is other than a mortgage or trust deed or a collateral assignment of beneficial interest in a land trust, you must attach to the copies of this document that you file with the county recorder and the department of environmental management a site plan that identifies the location of each unit.

5. Has the transferor ever held any of the following in regard to this real property?

	Yes	No
(A) Permits for discharges of wastewater to waters of Indiana.	_____	X _____
(B) Permits for emissions to the atmosphere.	_____	X _____
(C) Permits for any waste storage, waste treatment, or waste disposal operation.	_____	X _____

6. Has the transferor ever discharged any wastewater (other than sewage) to a publicly owned treatment works?

Yes _____
 No X _____

7. Has the transferor been required to take any of the following actions relative to this property?

- | | Yes | No |
|--|-------|---------------|
| (A) Filed an emergency and hazardous chemical inventory form pursuant to the federal Emergency Planning and Community Right-to-Know Act of 1986 (42 U.S.C. 11022). | _____ | _____ X _____ |
| (B) Filed a toxic chemical release form pursuant to the federal Emergency Planning and Community Right-to-Know Act of 1986 (42 U.S.C. 11023). | _____ | _____ X _____ |

8. Has the transferor or any facility on the property or the property been the subject of any of the following state or federal governmental actions?

- | | | |
|--|-------|---------------|
| (A) Written notification regarding known, suspected, or alleged contamination on or emanating from the property. | _____ | _____ X _____ |
| (B) Filing an environmental enforcement case with a court or the solid waste management board for which a final order or consent decree was entered. | _____ | _____ X _____ |
| (C) If the answer to question (B) was Yes, then indicate whether or not the final order or decree is still in effect for this property. | _____ | _____ X _____ |

9. Environmental Releases During Transferor's Ownership.

(A) Has any situation occurred at this site which resulted in a reportable "release" of any hazardous substances or petroleum as required under state or federal laws?

Yes _____
No X _____

(B) Have any hazardous substances or petroleum which were released come into direct contact with the ground at this site?

Yes _____
No X _____

If the answer to question (A) or (B) is Yes, have any of the following actions or events been associated with a release on the property?

- Use of a cleanup contractor to remove or treat materials, including soils, pavement, or other surficial materials?
- Assignment of in-house maintenance staff to remove or treat materials including soils, pavement, or other surficial materials?
- Sampling and analysis of soils?
- Temporary or more long term monitoring of groundwater at or near the site?
- Impaired usage of an onsite or nearby water well because of offensive characteristics of the water?
- Coping with fumes from subsurface storm drains or inside basements?
- Signs of substances leaching out of the ground along the base of slopes or at other low points on or immediately adjacent to the site?



(C) Is there an environmental defect (as defined in IC 13-7-22.5-1.5) on the property that is not reported under question (A) or (B)?

Yes _____
No

If the answer is Yes, describe the environmental defect:

10. Is the facility currently operating under a variance granted by the commissioner of the Indiana department of environmental management?

Yes _____
No

11. Has the transferor ever conducted an activity on the site without obtaining a permit from the U.S. Environmental Protection Agency, the commissioner of the department of environmental management, or another administrative agency or authority with responsibility for the protection of the environment, when such a permit was required by law?

Yes _____
No

If the answer is Yes, describe the activity:

12. Is there any explanation needed for clarification of any of the above answers or responses?

NO

B. Site Information Under Other Ownership or Operation

1. Provide the following information about the previous owner or about any entity or person to whom the transferor leased the property or with whom the transferor contracted for the management of the property:

Name: _____
 Type of business or property usage: _____

_____ This Document is the property of _____
 the Lake County Recorder!

2. If the transferor has knowledge, indicate whether the following existed under prior ownerships, leaseholds granted by the transferor, or other contracts for management or use of the property:

	YES	NO
Landfill	_____	X
Surface Impoundment	_____	X
Land Application	_____	X
Waste Pile	_____	X
Incinerator	_____	X
Storage Tank (Above Ground)	_____	X
Storage Tank (Underground)	X	_____
Container Storage Area	_____	X
Injection Wells	_____	X
Wastewater Treatment Units	_____	X
Septic Tanks	_____	X
Transfer Stations	_____	X
Waste Recycling Operations	_____	X
Waste Treatment Detoxification	_____	X
Other Land Disposal Area	_____	X

IV. CERTIFICATION

A. Based on my inquiry of those persons directly responsible for gathering the information, I certify that the information submitted is, to the best of my knowledge and belief, true and accurate.

Nassar Fardad by Leslie C. Barnard Atty. in Fact
TRANSFEROR (or on behalf of Transferor)

Nassar Fardad by Leslie C. Barnard his attorney in fact

B. This form was delivered to me with all elements completed on October
26, 1993

James R. Meyer
TRANSFeree (or on behalf of Transferee)

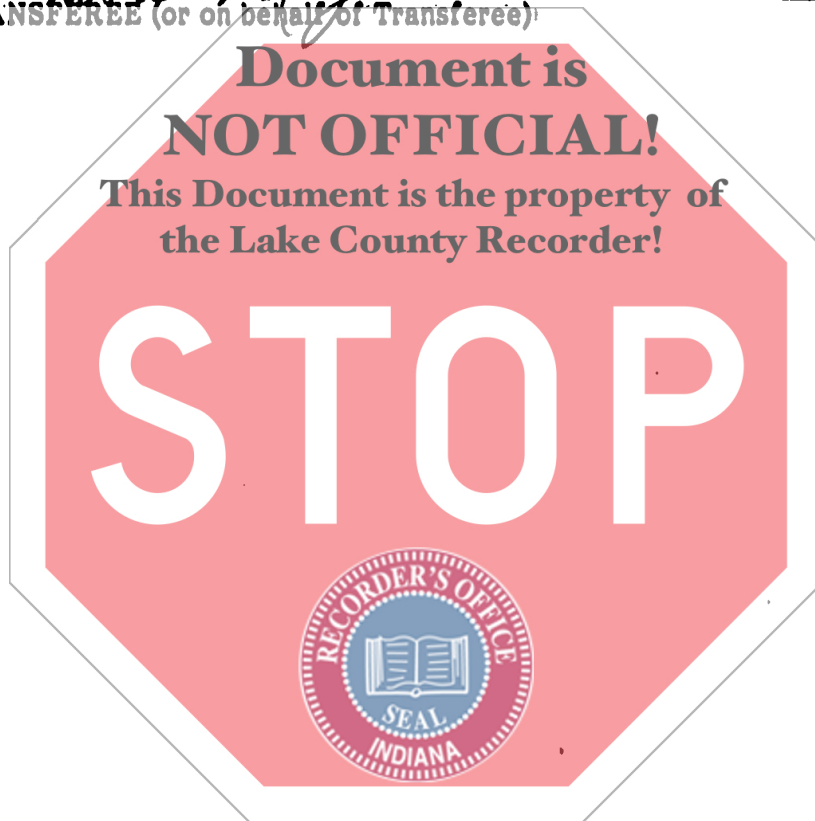

(INDIVIDUAL ACKNOWLEDGMENT)

STATE OF Indiana)
) SS:
COUNTY OF Lake)

Before me, a Notary Public in and for said County and State, personally appeared Leslie C. Barnard, attorney in fact for Nasser, on behalf of Transferor, and acknowledged the execution of the foregoing instrument.

Witness my hand and Notarial Seal this 26th day of October, 19 93

Document is

NOT OFFICIAL!

This Document is the property of
the Lake County Recorder!

My Commission Expires: 12/08/95 Jacalyn L. Smith (signature)
(printed name) NOTARY PUBLIC
Resident of Lake County



(INDIVIDUAL ACKNOWLEDGMENT)

STATE OF Indiana)
) SS:
COUNTY OF Lake)

Before me, a Notary Public in and for said County and State, personally appeared James B. Meyer, on behalf of Transferee, and acknowledged the execution of the foregoing instrument.

Witness my hand and Notarial Seal this 26th day of October, 19 93



Jacalyn L. Smith (signature)
(printed name) NOTARY PUBLIC
Resident of Lake County

My Commission Expires:
12/08/95

This instrument was prepared by [Name of Individual]

